

**TECHNICAL DATA****Operating range:**

up to 5.4 m<sup>3</sup>/h with head up to 61 metres.

**Liquid quality requirements:** clean, free from solid or abrasive contaminants, non-viscous, non-aggressive, uncrystallised and chemically neutral, close to the properties of water.

**Liquid temperature range:** from 0°C to +35°C for domestic use (EN 60335-2-41). For other use: from 0°C to +40°C

**Maximum ambient temperature:** +40°C

**Maximum operating pressure:** 8 bar (800 kPa)

**Motor protection rating:** IP 44

**Terminal block protection rating:** IP 55

**Insulation class:** F

**Standard input voltage:** single phase 220-240 V / 50 Hz

**APPLICATIONS**

Automatic booster sets, especially suitable for domestic use, small civil, farming or industrial installations, washing plants and leisure activities.

These feature JET self-priming electric pumps, which work even in the presence of air bubbles and small sandy impurities in the water.

The assembly comprises a 20 litre capacity mebrane tank, pressure switch for automatic operation, pressure gauge, JET electric pump with power cord with plug, fittings kit between the pump and the tank, all fully assembled and ready for installation.

**CONSTRUCTIONAL FEATURES OF THE PUMP**

Pump body and motor support in die cast aluminium.

Impeller, diffuser, venturi tube and sand guard in technopolymer

Stainless steel wear ring.

Carbon/ceramic mechanical seal.

**CONSTRUCTIONAL FEATURES OF THE MOTOR**

Asynchronous type, closed, with external air cooling.

Rotor mounted on oversized greased-for-life ball bearings, to guarantee low noise and long life.

Incorporated thermo-amperometric protection and permanently inserted capacitor.

Manufactured pursuant to CEI 2-3 / CEI 61-69 (EN 60335-2-41).

**CONSTRUCTIONAL FEATURES OF THE TANK**

Horizontal, 20 litre capacity tank, with butyl membrane, including rear support brackets and front housing brackets for installation of the top side of the pump.

### MATERIALS

N°	PARTS *	MATERIALS
1	PUMP BODY	200 UNI ISO 185 CAST IRON
3	FRAME	DIE CAST ALUMINIUM
4	IMPELLER	TECHNOPOLYMER A
7	SHAFT WITH ROTOR	AISI 416 STAINLESS STEEL X12 CrS13 - UNI 6900/71
16	MECHANICAL SEAL	CARBON/CERAMIC
28	OR GASKET	NBR RUBBER
160	VENTURI DIFFUSER NOZZEL GROUP	TECHNOPOLYMER A

\* In contact with liquid

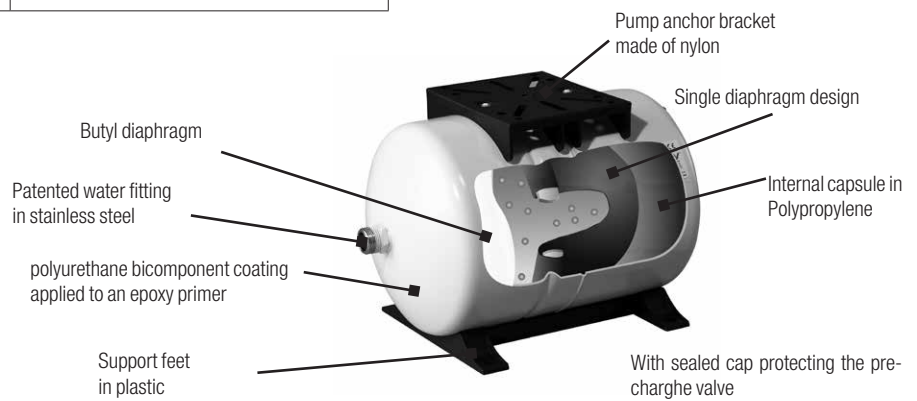
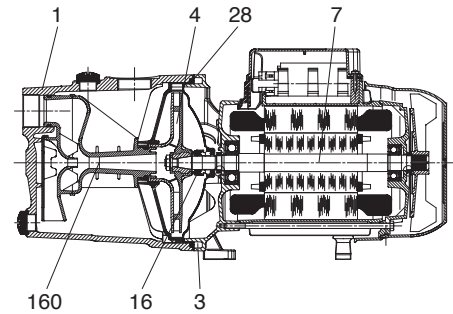

### SELF PRIMING CAPACITY

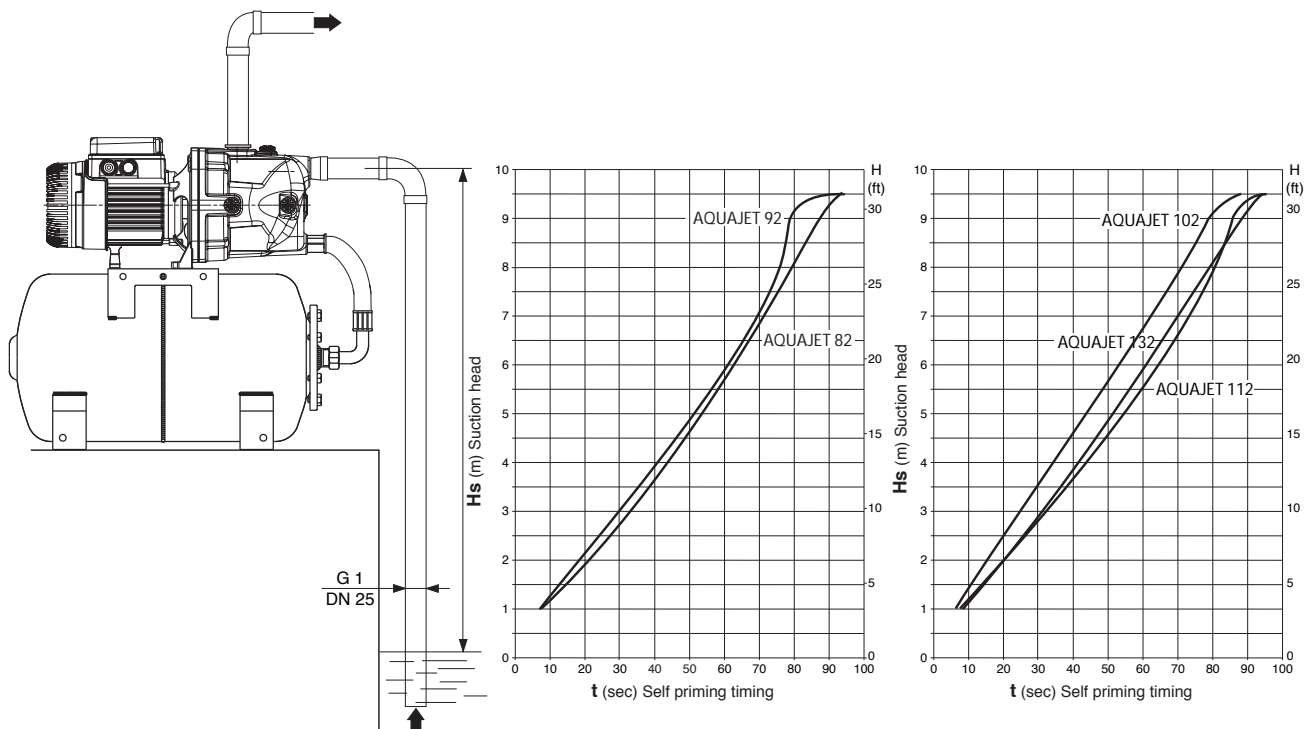

### PERFORMANCE RANGE

The performance curves are based on kinematic viscosity values = 1 mm<sup>2</sup>/s and density equivalent to 1000 kg/m<sup>3</sup>. Curve tolerance according to ISO 9906.

### GRAPHIC SELECTION TABLE

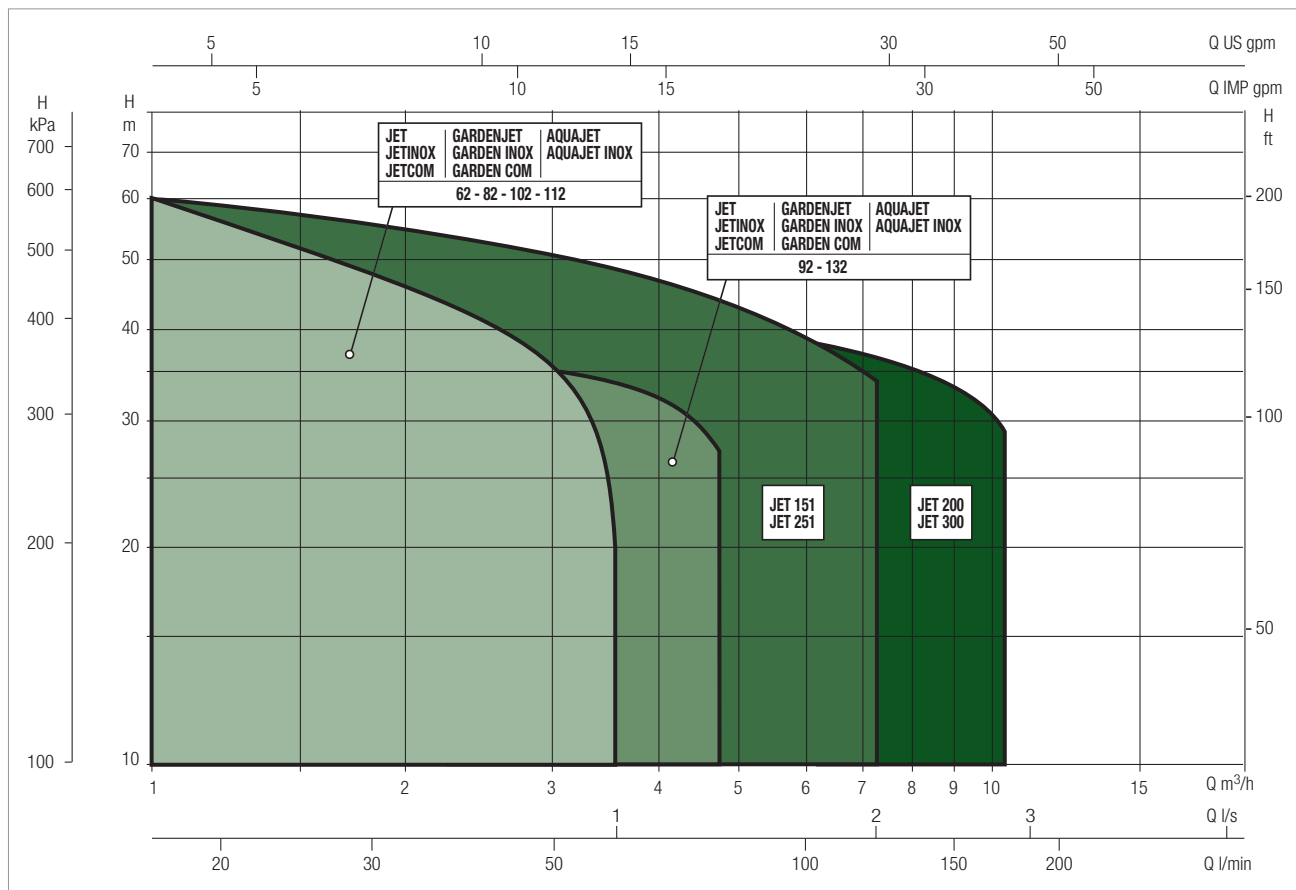

### AQUAJET SELECTION TABLE

MODEL	Q=m <sup>3</sup> /h	0	0.6	1.2	1.8	2.4	3.0	3.6	4.2	4.8
	Q=l/min	0	10	20	30	40	50	60	70	80
AQUAJET 82 M	H (m)	47	40	34	30	26.2	23.5	20.3		
AQUAJET 102 M		53.8	47	41	36.3	32.4	28.8	25.8		
AQUAJET 112 M		61	54	47.8	42.8	38.8	34.8	22		
AQUAJET 92 M		36.2	33.5	31	28.4	26	24	21.8	19.6	17.5
AQUAJET 132 M		48.3	45.6	42.8	40	37.6	35	32.5	30	27.2

# AQUAJET - AUTOMATIC SELF-PRIMING PRESSURISATION GROUPS FOR DOMESTIC WATER SUPPLY

Liquid temperature range pumped: from 0 °C to +35 °C - Maximum ambient temperature: +40°C

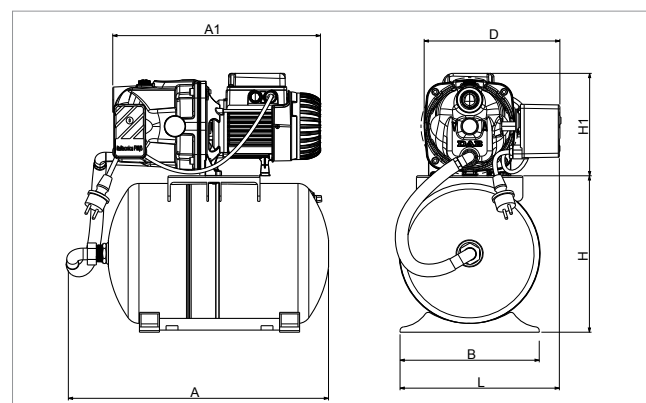
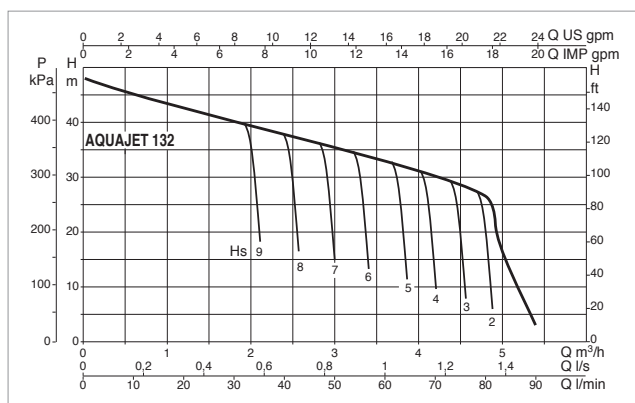
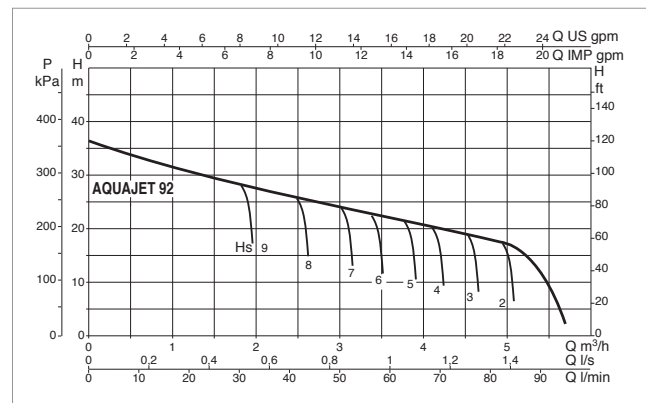
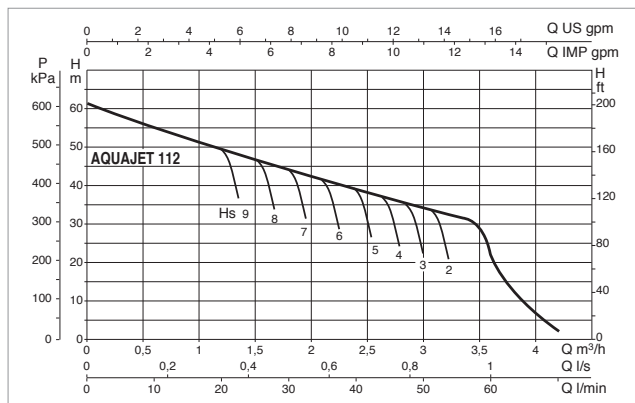
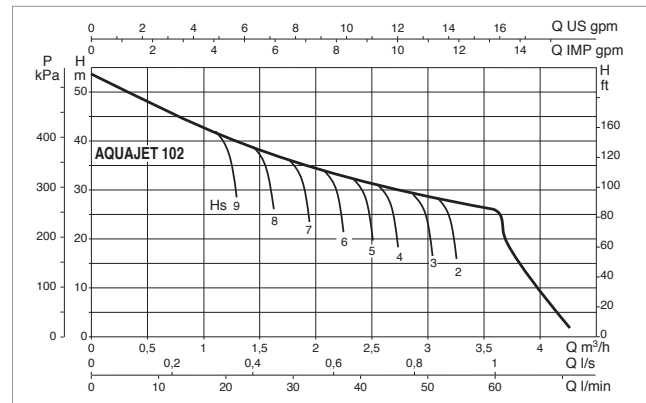
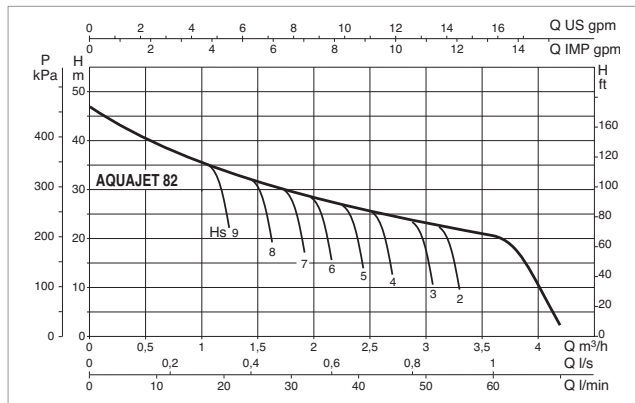

The performance curves are based on kinematic viscosity values = 1 mm<sup>2</sup>/s and density equivalent to 1000 kg/m<sup>3</sup>. Curve tolerance according to ISO 9906.

MODEL	ELECTRICAL DATA						
	POWER SUPPLY 50 Hz	P1 MAX kW	P2 NOMINAL		In A	CAPACITOR	
			kW	HP		µF	Vc
AQUAJET 82 M	1x220-240 V ~	0.85	0.6	0.8	3.8	12.5	450
AQUAJET 102 M	1x220-240 V ~	1.13	0.75	1	5.1	16	450
AQUAJET 112 M	1x220-240 V ~	1.4	1	1.36	6.2	25	450
AQUAJET 92 M	1x220-240 V ~	0.94	0.75	1	4.2	14	450
AQUAJET 132 M	1x220-240 V ~	1.43	1	1.36	6.6	25	450

MODEL	A	A1	B	D	H	H1	L	DNA GAS	DNM GAS	PACK DIMENSIONS			VOLUME (mc)	GROSS WEIGHT Kg
										L/A	L/B	H		
AQUAJET 82 M	492	393	263	256	296	194	301	1"	1"	566	360	554	0.104	17.8
AQUAJET 102 M	492	413	263	256	296	204	301	1"	1"	566	360	554	0.104	19.8
AQUAJET 112 M	492	413	263	256	296	204	301	1"	1"	566	360	554	0.104	19
AQUAJET 92 M	492	303	263	256	296	194	301	1"	1"	566	360	554	0.104	20.1
AQUAJET 132 M	492	413	263	256	296	204	301	1"	1"	566	360	554	0.104	21.5

# AQUAJET - AQUAJETINOX

## SELF-PRIMING AUTOMATIC BOOSTER



### DOMESTIC WATER SUPPLY



Automatic water lifting units, suitable for domestic use, small installations for civil, agricultural, industrial use, washing and hobby applications.

The unit is equipped with a JET or JETINOX type self-priming electropump, vessel, pressure switch for automatic operation, pressure gauge, fitting kit between pump and motor, all pre-assembled.

Tank: horizontal, 20 litres capacity type, inner single diaphragm high-grade butyl membrane and virgin polypropylene liner, complete with stands at the bottom and brackets for fixing the pump to the top.

**Operating range:** up to 5.4 m<sup>3</sup>/h with head up to 61 metres

**Liquid temperature range:** from 0°C to +35°C for domestic use from 0°C to +40°C for other use

**Pumped liquid characteristics:** clean, free from solids or abrasive substances, not viscous, not aggressive, not crystallised and chemically neutral.

**Maximum ambient temperature:** +40°C

**Maximum working pressure:** 8 bar (800 kPa)

**Protection level:** IP 44 (IP 55 terminal board protection).

**Insulation class:** F

ACCESSORIES

PAG. 95

## TECHNICAL DATA - AQUAJET

MODEL	CODE	ELECTRICAL DATA					HYDRAULIC DATA													
		VOLTAGE 50 Hz	P1 MAX KW	P2 NOMINAL		In A	Q=m <sup>3</sup> /h	0	0,6	1,2	1,8	2,4	3,0	3,6	4,2	4,8	DNA GAS	DNM GAS	WT. KG	Q.TY X PALLET
				kW	HP		Q=l/min	0	10	20	30	40	50	60	70	80				
AQUAJET 82 M - G	60121345	1x220-240 V ~	0,85	0,6	0,8	3,8	H (m)	47	40	34	30	26,2	23,5	20,3		1"	1"	18,2	12	
AQUAJET 102 M - G	60121344	1x220-240 V ~	1,13	0,75	1	5,1		53,8	47	41	36,3	32,4	28,8	25,8		1"	1"	20,0	12	
AQUAJET 112 M - G	60141881	1x220-240 V ~	1,4	1	1,36	6,2		61	54	47,8	42,8	38,8	34,8	22		1"	1"	21,0	12	
AQUAJET 92 M - G	60141882	1x220-240 V ~	0,94	0,75	1	4,2		36,2	33,5	31	28,4	26	24	21,8	19,6	17,5	1"	1"	19,2	12
AQUAJET 132 M - G	60141883	1x220-240 V ~	1,43	1	1,36	4,7-2,7		48,3	45,6	42,8	40	37,6	35	32,5	30	27,2	1"	1"	21,0	12

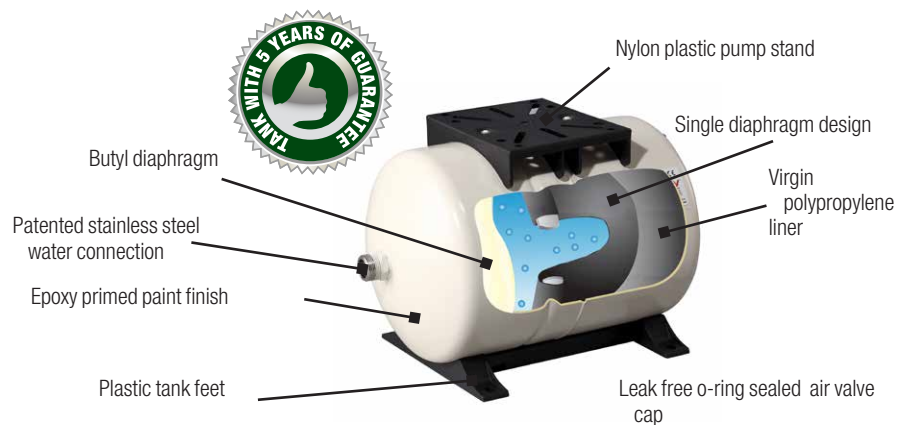

## TECHNICAL DATA - AQUAJETINOX

MODEL	CODE	ELECTRICAL DATA					HYDRAULIC DATA													
		VOLTAGE 50 Hz	P1 MAX KW	P2 NOMINAL		In A	Q=m <sup>3</sup> /h	0	0,6	1,2	1,8	2,4	3,0	3,6	4,2	4,8	DNA GAS	DNM GAS	WT. KG	Q.TY X PALLET
				kW	HP		Q=l/min	0	10	20	30	40	50	60	70	80				
AQUAJET-INOX 82 M - G	60141884	1x220-240 V ~	0,85	0,6	0,8	3,8	H (m)	47	40	34	30	26,2	23,5	20,3		1"	1"	15,3	12	
AQUAJET-INOX 102 M - G	60141885	1x220-240 V ~	1,13	0,75	1	5,1		53,8	47	41	36,3	32,4	28,8	25,8		1"	1"	17,1	12	
AQUAJET-INOX 112 M - G	60141886	1x220-240 V ~	1,4	1	1,36	6,2		61	54	47,8	42,8	38,8	34,8	20		1"	1"	18,1	12	
AQUAJET-INOX 132 M - G	60141888	1x220-240 V ~	1,43	1	1,36	4,7-2,7		4,3	45,6	42,8	40	37,6	35	32,5	30	27,2	1"	1"	18,1	12