





AYTOK started its manufacturing journey by producing PE Fittings for driplines in Izmir (1997). In 1999, AYTOK management perceived a new market opportunity and started metal and plastic filter manufacturing in Konya. This decision created remarkable results, contributing AYTOK a market leader manufacturer position in Turkey. AYTOK management's great support on R&D and market research in accordance with customer request, lies behind this success. AYTOK, a pioneer at the sector, has contributed to further development of the sector and user-oriented by field troubleshooting service, factory maintenance, technology and control systems and continued this responsibility by competing with itself. Today, AYTOK is serving its domestic and international customers in more than 60 countries with its all White and Blue collar employees including dedicated engineers in the total area of 30000 m<sup>2</sup> that 12380 m<sup>2</sup> of which is indoor area. As an innovative brands in its own domestic market, AYTOK is one of the leading players in the global market, as well, who follows international manufacturing standards by its exports capabilities. By always giving importance to quality, technology and innovation, alongside environmental protection policy, AYTOK will continue its works without compromising this service concept and stabilize its position in filtration industry in the international market.



ISO 9001:2015

ISO 45001

www.famcocorp.com

E-mail: info@famcocorp.com

@famco\_group



Tel: 021- 4 8 0 0 0 4 9

Fax : 021 - 4 4 9 9 4 6 4 2

تهران ، کیلومتر ۲۱ بزرگراه لشگری (جاده مخصوص کرج)

روبروی پالایشگاه نفت پارس ، پلاک ۱۲



# PRODUCT IN LINE

## PLASTIC FILTERS



- MINI PLASTIC FILTERS (DISC & SCREEN) MPD, MPE
- PLASTIC MANUAL T MODEL FILTERS (DISC & SCREEN) PE, PD
- PLASTIC MANUAL DOUBLE MODEL FILTERS (DISC & SCREEN) DE, DD
- PLASTIC AUTOMATIC SELF CLEANING DISC FILTERS T MODEL PSC
- PLASTIC AUTOMATIC SELF CLEANING DISC FILTERS DOUBLE MODEL DDSC
- PLASTIC HYDROCYCLONE P20
- PLASTIC SAND MEDIA FILTERS P30
- PLASTIC FERTILIZER TANKS P1100, P1200
- PLASTIC CLAMPS V20
- PLASTIC VENTURIES
- PLASTIC FLANGES



Mini Plastic Filters



DISC & SCREEN  
MPD, MPE

GENERAL CHARACTERISTICS

Body Material : PP  
Cartridge Material: PP (Disc) PA (Screen SS 304 Cage PA)  
Maximum Working Pressure : 8 Bar (116 PSI)  
Maximum Working Temperature: 60 °C/ 140 °F  
Filtration Degree: 20-50-100-130 micron  
Filter Cartridge: D: Disc Cartridge E: Screen Cartridge

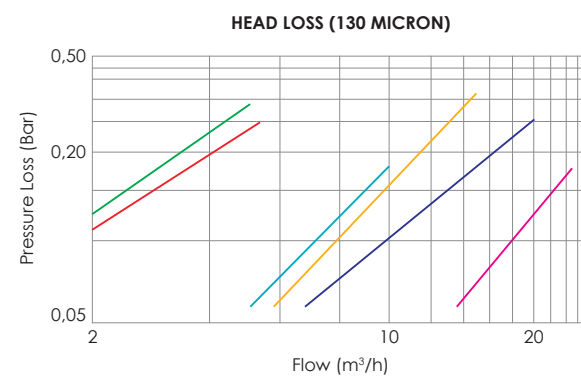
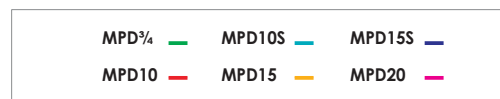
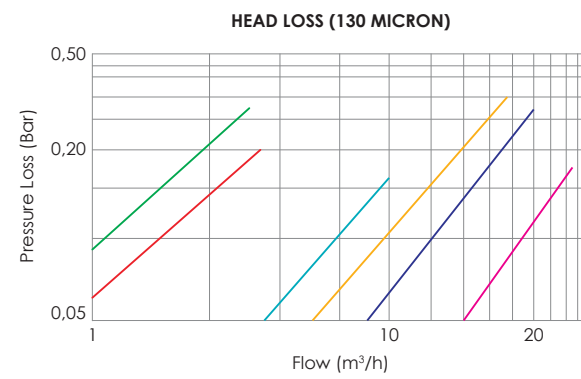

CODE	D	M	T	D1	H	K	FLOW	FILTER SURFACE AREA	WEIGHT
	inch			mm			m³/h	cm²	kg
MPE3/4	3/4		1/2	68	190	160	5	165	0,3
MPD3/4	3/4		1/2	68	190	160	5	185	0,45
MPE10	1		1/2	68	190	160	6	165	0,3
MPD10	1		1/2	68	190	160	6	185	0,45
MPD10S	1		1/2	96	230	220	10	300	0,75
MPE10S	1		1/2	96	230	220	10	325	1
MPE15	1½		1/2	96	230	220	15	300	0,75
MPD15	1½		1/2	96	230	220	15	325	1
MPE15S	1½	1/4	1/2	120	280	270	20	515	1,2
MPD15S	1½	1/4	1/2	120	280	270	20	550	1,5
MPE20	2	1/4	1/2	120	280	270	25	515	1,2
MPD20	2	1/4	1/2	120	280	270	25	550	1,5

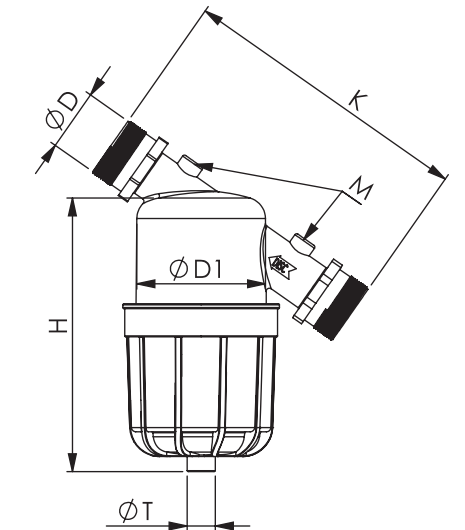

CODE	Connection	Max. flow	Filtering surface (screen)	Filtering surface (disc)
MPE 3/4 - MPD 3/4	3/4" BSP/NPT	5 m³/h	165 cm²	185 cm²
MPE 10 - MPD 10	1" BSP/NPT	6 m³/h	165 cm²	185 cm²

CODE	Connection	Max. flow	Filtering surface (screen)	Filtering surface (disc)
MPE 10S - MPD 10S	1" BSP/NPT	10 m³/h	300 cm²	325 cm²
MPE 15 - MPD 15	1½" BSP/NPT	15 m³/h	300 cm²	325 cm²

CODE	Connection	Max. flow	Filtering surface (screen)	Filtering surface (disc)
MPE 15S - MPD 15S	1½" BSP/NPT	20 m³/h	515 cm²	550 cm²
MPE 20 - MPD 20	2" BSP/NPT	25 m³/h	515 cm²	550 cm²

## Horizontal Plastic Disc Filters



## DISC & SCREEN PE, PD

### GENERAL CHARACTERISTICS

Body Material: PA6GFR30  
 Cartridge Material: PP (Disc) PA (Screen SS 304 Cage PA)  
 Maximum Working Pressure: 8 Bar (116 PSI)  
 Maximum Working Temperature: 60°C/ 140 °F  
 Filtration Degree: 20-50-100-130 Micron  
 Filter Cartridge: D: Disc Cartridge - E: Screen Cartridge

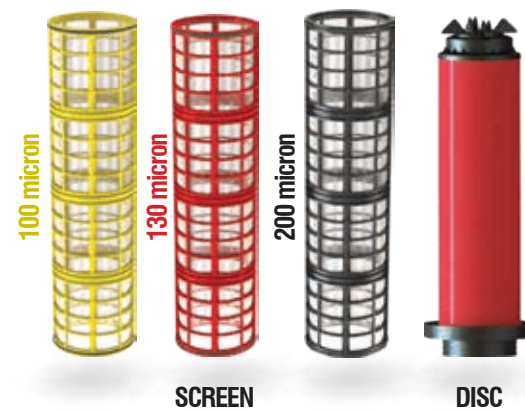

## FAMCO هایپر صنعت

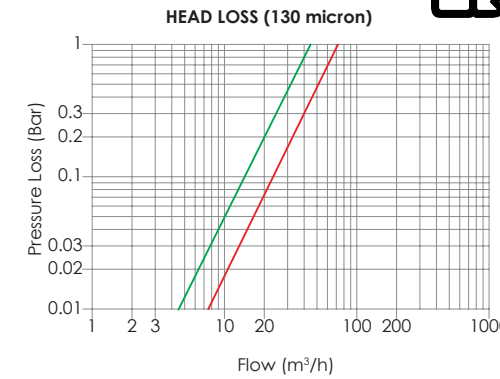

PD2 — PSD3

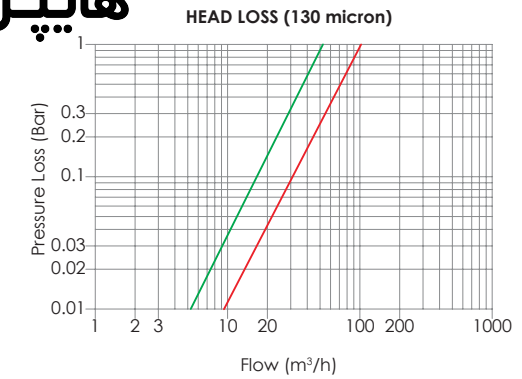

PE2 — PSE3

CODE	D	M	T	D1	H	K	Flow Rate		Filtration Area	Weight
	inch	inch	inch	mm	mm	mm	m³/h	Usgpm	cm²	kg
PME2	2	1/4	3/4	190	500	335	20	88	760	5,2
PMD2	2	1/4	3/4	190	500	335	20	88	868	6
PD2	2	1/4	3/4	190	600	335	30	132	1302	7
PSD2	2	1/4	3/4	190	750	335	35	154	1805	8
PD25	2½	1/4	3/4	190	600	335	35	154	1302	7,1
PSD25	2½	1/4	3/4	190	750	335	40	176	1805	8,1
PD3	3	1/4	3/4	190	600	335	45	198	1302	7,2
PSD3	3	1/4	3/4	190	750	335	50	220	1805	8,2
PE2	2	1/4	3/4	190	600	335	30	132	1140	5,4
PSE2	2	1/4	3/4	190	750	335	35	154	1520	6,3
PE25	2½	1/4	3/4	190	600	335	35	154	1140	5,5
PSE25	2½	1/4	3/4	190	750	335	40	176	1520	6,4
PE3	3	1/4	3/4	190	600	335	45	198	1140	5,6
PSE3	3	1/4	3/4	190	750	335	50	220	1520	6,5

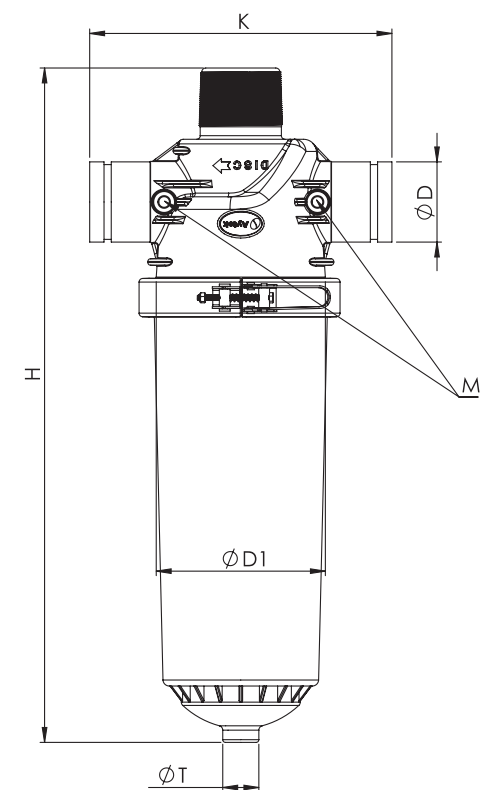

**“4 Double Plastic Filters**



**DISC & SCREEN  
DD, DE**

**GENERAL CHARACTERISTICS**  
Body Material: PA6GFR30  
Cartridge Material: PP (Disc) PA (Screen SS 304 Cage PA)  
Maximum Working Pressure: 8 Bar (116 PSI)  
Maximum Working Temperature: 60 °C/ 140 °F  
Filtration Degree: 20-50-100-130 Micron  
Filter Cartridge: D: Disc Cartridge - E: Screen Cartridge

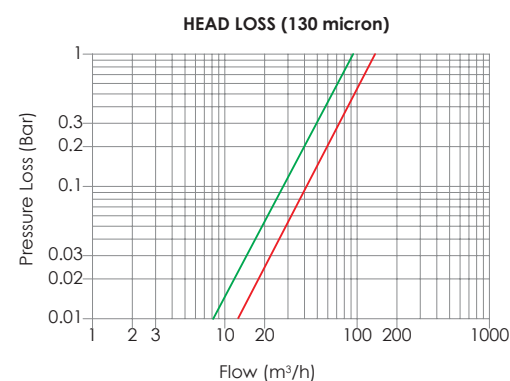
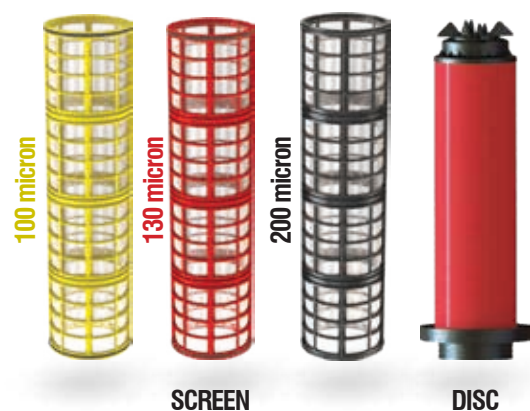
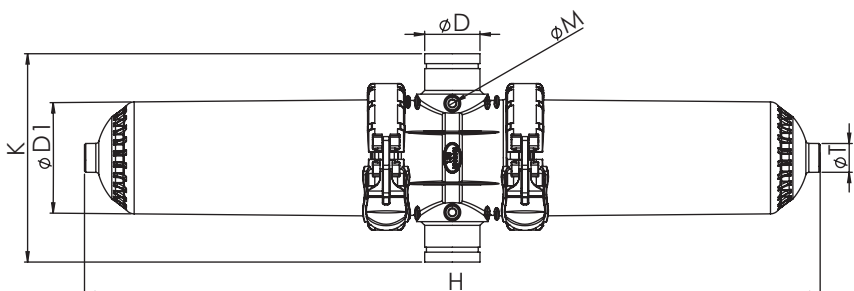

CODE	D	M	T	D1	H	K	Flow Rate		Filtration Area	Weight
	inch	inch	inch	mm	mm	mm	m³/h	Usgpm	cm²	kg
DD3	3	1/4	3/4	190	960	340	50	220	2604	11,4
DD4	4	1/4	3/4	190	960	340	70	308	2604	11,6
DDS3	3	1/4	3/4	190	1200	340	60	264	3610	13,6
DDS4	4	1/4	3/4	190	1200	340	80	352	3610	13,8
DE3	3	1/4	3/4	190	960	340	50	220	2280	8,4
DE4	4	1/4	3/4	190	960	340	70	308	2280	8,6
DES3	3	1/4	3/4	190	1200	340	60	264	3040	9,8
DES4	4	1/4	3/4	190	1200	340	80	352	3040	10

**“6 Double Plastic Filters**



**DISC & SCREEN  
DD, DE**

**GENERAL CHARACTERISTICS**  
Body Material: PA6GFR30

Cartridge Material: PP (Disc) PA (Screen SS 304 Cage PA)  
Maximum Working Pressure: 8 Bar (116 PSI)  
Maximum Working Temperature: 60 °C/ 140 °F  
Filtration Degree: 20-50-100-130 Micron  
Filter Cartridge: D: Disc Cartridge - E: Screen Cartridge

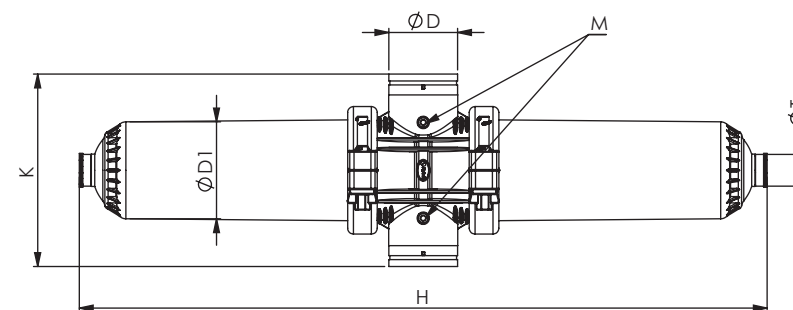
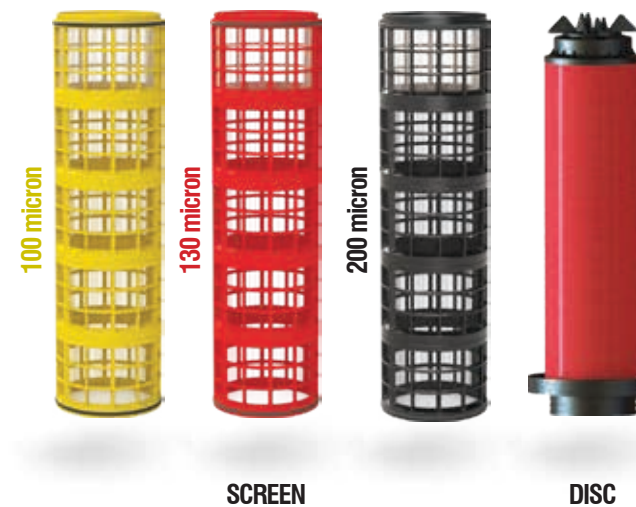

CODE	D	M	T	D1	H	K	Flow Rate		Filtration Area	Weight
	inch	inch	inch	mm	mm	mm	m³/h	Usgpm	cm²	kg
DD6	6	1/4	1	242	1655	460	180	792	6212	28
DE6	6	1/4	1	242	1655	460	180	792	5532	21

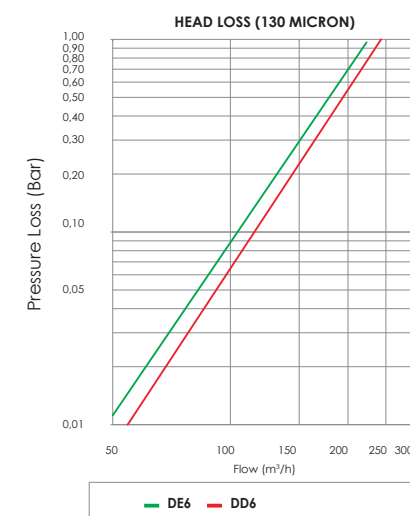



# PRODUCT IN LINE

## METAL FILTERS



- ANGULAR METAL FILTERS (SCREEN & DISC) FILTERS LE, LD
- HORIZONTAL METAL FILTERS (SCREEN & DISC) FILTERS YE, YD
- METAL HYDROCYCLONE
- METAL SAND MEDIA (GRAVEL) FILTERS
- METAL FERTILIZER TANKS



## Angular Metal Filters

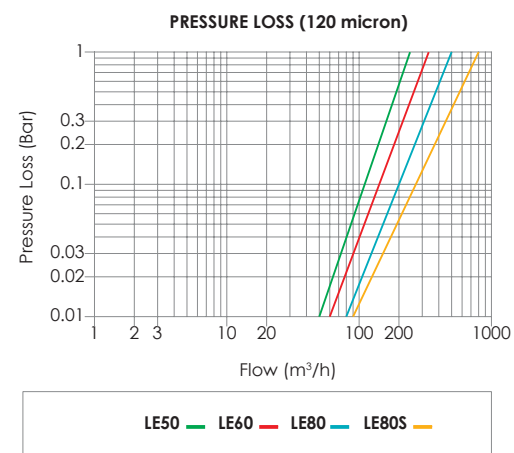
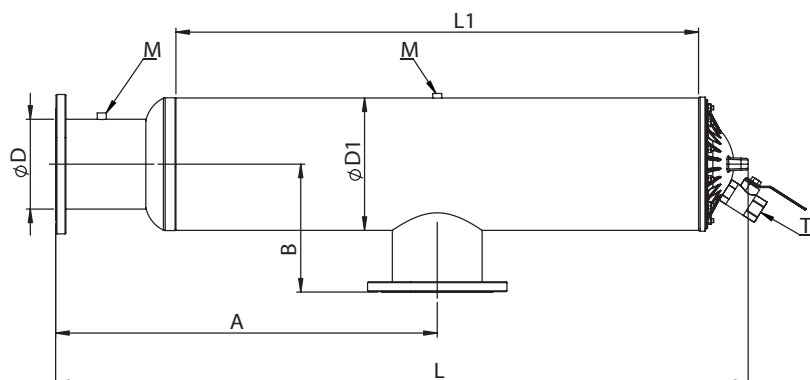

CODE	D	D1	M	T	A		B		L		Main Flow Rate m³/h	Filtration Area cm²	Weight kg
	inch				mm		mm		mm				
LE50	5	10	¼	1	610	287	1055	640	140	616	3951	46	
LE60	6	10	¼	1	710	287	1255	840	180	792	5268	58	
LE60S	6	12	¼	1	810	287	1455	1040	220	968	6585	68	
LE80	8	12	¼	1	810	287	1455	1040	280	1232	6585	70	
LE80S	8	12	¼	1	930	312	1690	1275	340	1496	7902	88	

## SCREEN LE

### GENERAL CHARACTERISTICS

Body Material : S195T  
Cartridge Material: PP (Disc) PA (Screen SS 304 Cage PA)  
Maximum Working Pressure : 10 Bar (116 PSI)  
Maximum Working Temperature: 60 °C / 140 °F  
Filtration Degree: 20-50-100-130 Micron  
Filter Cartridge: E: Screen Cartridge  
Painting Method: Electrostatic Powder Coating  
Paint Material: Epoxy Polyester

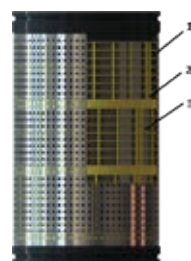

- 1 - Protector coarse screen SS304L
- 2 - Molded plastic rib (PA6)
- 3 - The main filtering screen

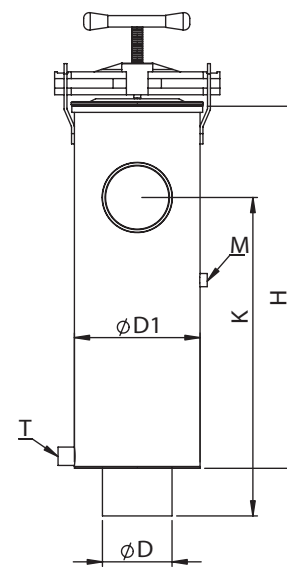

## Angular Metal Filters



## DISC LD

### GENERAL CHARACTERISTICS

Body Material: S195T  
Cartridge Material: PP (Disc)  
Maximum Working Pressure: 8 Bar (116 PSI)  
Maximum Working Temperature: 60 °C / 140 °F  
Filtration Degree: 20-50-100-130 Micron  
Filter Cartridge: D: Disc Cartridge  
Painting Method: Electrostatic Powder Coating  
Paint Material: Epoxy Polyester

CODE	D	D1	M	T	K		H		FLOW RATE		WEIGHT
	inch				mm		mm		m³/h	Usgpm	kg
LDS20	2	6	¼	½	320	400	30	400	30	132	15
LDS25	2½	8	¼	¾	320	400	35	400	35	154	19
LDS30	3	8	¼	¾	455	515	50	515	50	220	22
LD40	4	8	¼	¾	555	625	70	625	70	308	27



DISC

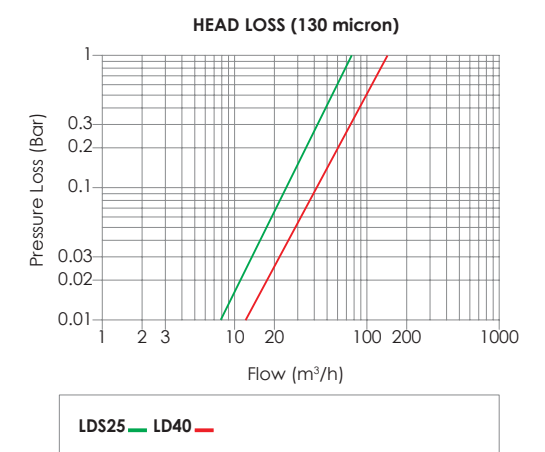
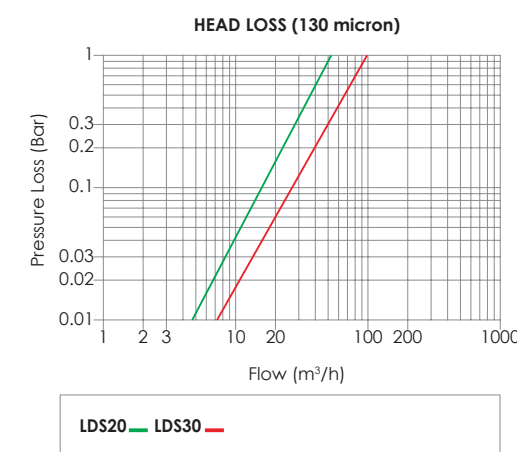



## Horizontal Metal Filters

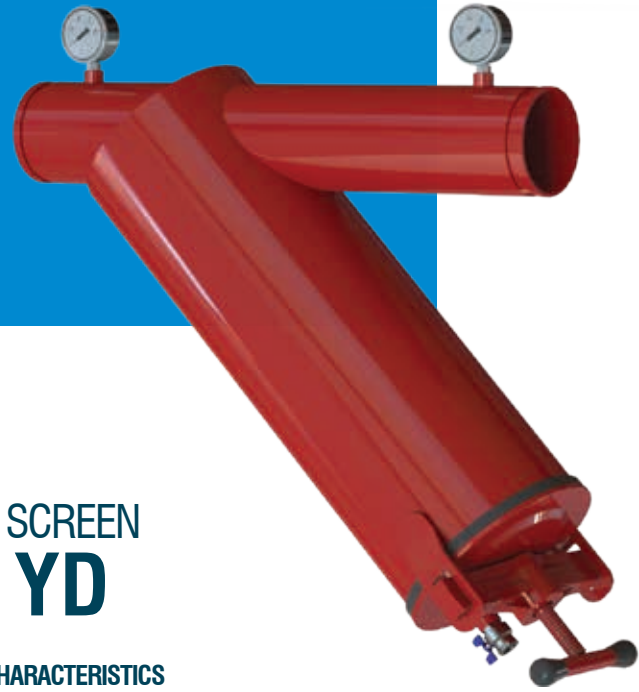

### DISC & SCREEN YE, YD

#### GENERAL CHARACTERISTICS

Body Material: S195T  
Cartridge Material: PP (Disc) PA (Screen SS 304 Cage PA)  
Maximum Working Pressure: 8 Bar (116 PSI)  
Maximum Working Temperature: 60 °C / 140 °F  
Filtration Degree: 20-50-100-130 Micron  
Filter Cartridge: D: Disc Cartridge E: Screen Cartridge  
Painting Method: Electrostatic Powder Coating  
Paint Material: Epoxy Polyester

CODE	D	D1	M	T	K	H	FLOW RATE		WEIGHT
	inch				mm		m <sup>3</sup> /h	Usgpm	
YE20	2	6	¼	½	515	240	30	132	12
YE25	2½	6	¼	½	570	360	35	154	14,6
YE30	3	6	¼	½	570	480	45	198	18
YE40	4	8	¼	½	670	605	75	330	28
YE50	5	10	¼	1	900	700	140	616	51
YE60	6	10	¼	1	1100	1000	180	792	88
YE80	8	12	¼	1	1200	1200	280	1232	115
YDS20	2	6	¼	½	520	400	30	132	16
YD25	2½	8	¼	¾	590	400	35	154	20
YD30	3	8	¼	¾	590	515	45	198	24
YD40	4	8	¼	¾	670	625	70	308	29

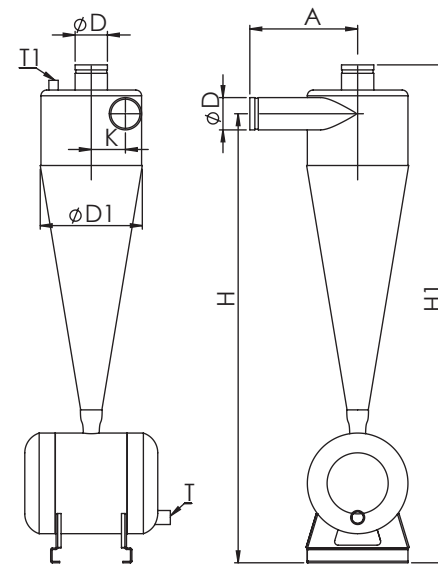
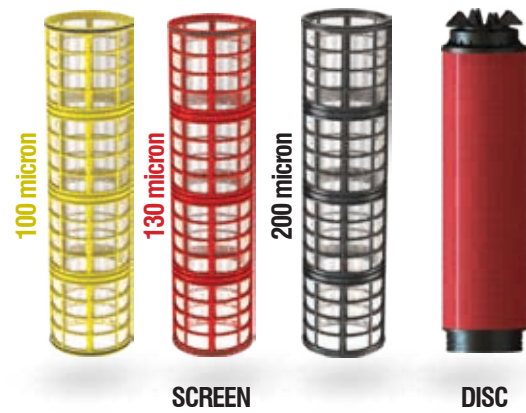
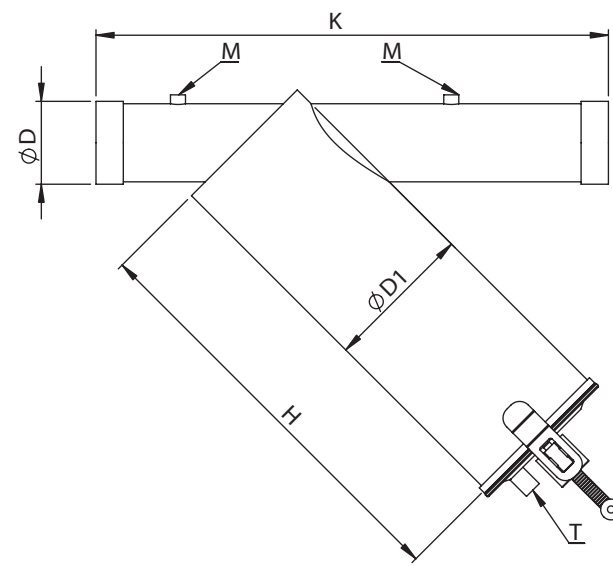
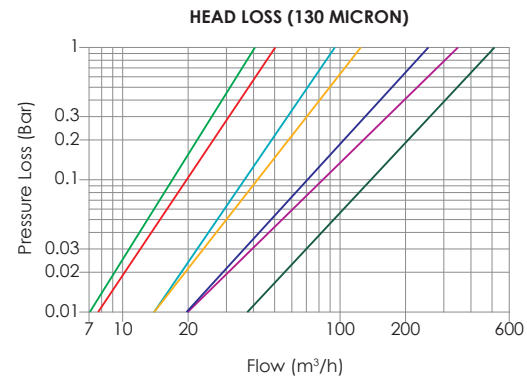

## Metal Hydrocyclone



#### GENERAL CHARACTERISTICS

Body Material: S235JR  
Maximum Working Pressure: 8 Bar (116 PSI)  
Maximum Working Temperature: 60 °C / 140 °F  
Painting Method: Electrostatic Powder Coating  
Paint Material: Epoxy Polyester

CODE	D	D1	T	T1	K	A	H	H1	FLOW		MAX. PRESSURE		WEIGHT					
	inch				mm	inch	mm	inch	mm	inch	m <sup>3</sup> /h	Us gpm	Bar	PSI	kg	lb		
2020	2	11	¾	½	110	4,3	250	9,8	1185	46,7	1305	51,4	20	88	8	116	25	55,1
2025	2½	11	1	½	102	4	300	11,8	1255	49,4	1385	54,5	30	132	8	116	27	59,5
2030	3	11	1	½	95	3,7	300	11,8	1250	49,2	1385	54,5	40	176	8	116	28	61,7
2040	4	11	1	½	82,5	3,2	300	11,8	1235	48,6	1385	54,5	60	264	8	116	30	66,1
2040S	4	13	2	¾	102,5	4	350	13,8	1280	50,4	1430	56,3	80	352	8	116	35	77,2
2050	5	15	2	1	120	4,7	400	15,7	1520	59,8	1745	68,7	120-140	528-616	8	116	65	143,3
2060	6	18	2	1	142,5	5,6	450	17,7	1750	68,9	2035	80,1	160-200	704-880	8	116	92	202,8



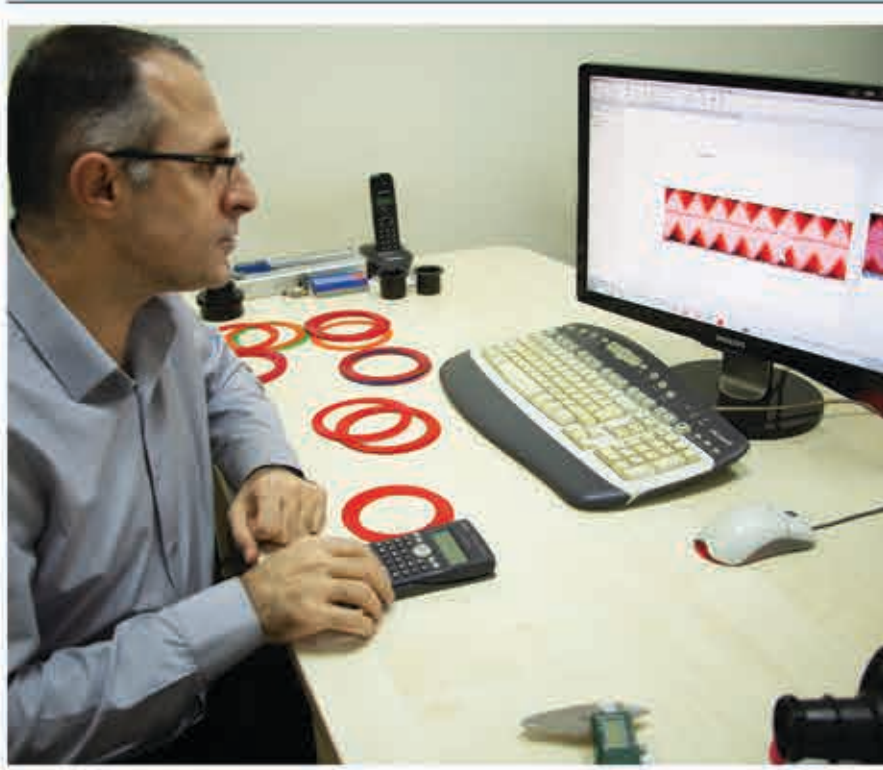

The reason of Aytok's development and moving forward in the technological competition is the strategic importance given to the R&D and Quality.

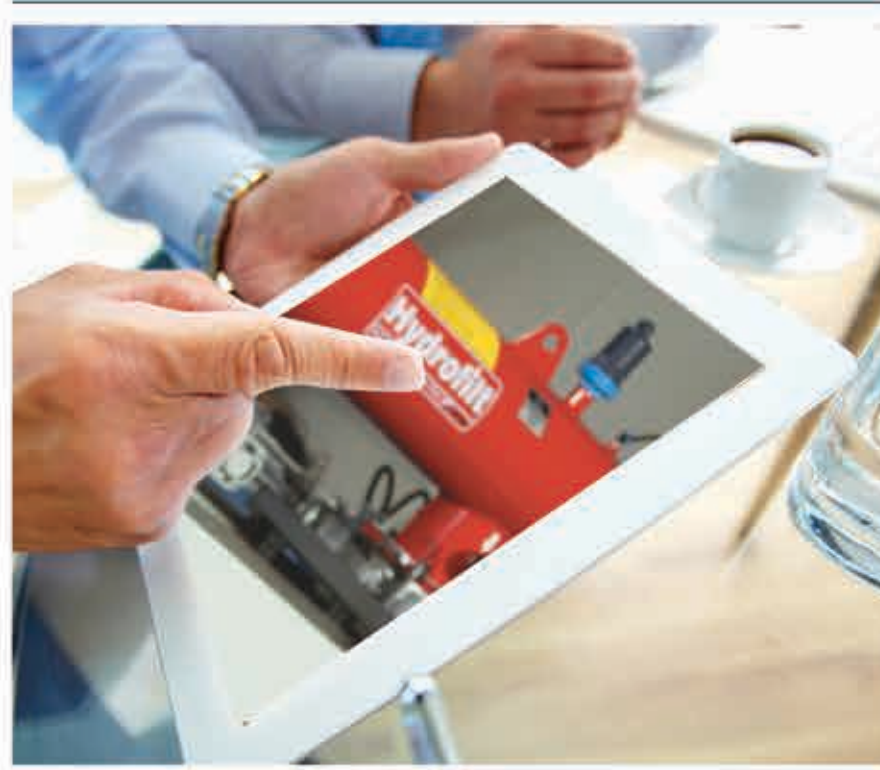

Quality is not a coincidence...

aytokfiltre.com

PRODUCT