

Product Catalogue

RESIDENTIAL, COMMERCIAL & GOLF IRRIGATION | Built on Innovation®

VOLUME 38

Hunter®

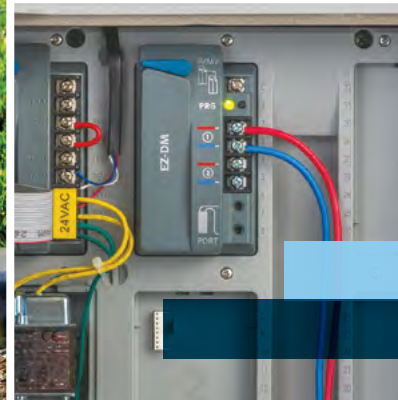

www.famcocorp.com

E-mail: info@famcocorp.com

@famco_group

Tel: ۰۲۱-۴۸۰۰۰۰۴۹

Fax: ۰۲۱-۴۴۹۹۴۶۴۲

es.com تهران، کیلومتر ۲۱ بزرگراه لشگری (جاده مخصوص کرج)

روبروی پالایشگاه نفت پارس، پلاک ۱۲



CONTROLLERS

 www.famcocorp.com

 E-mail: info@famcocorp.com

 @famco_group

 Tel: ۰۲۱-۴۸۰۰۰۰۴۹

 Fax: ۰۲۱-۴۴۹۹۴۶۴۲

تهران، کیلومتر ۲۱ بزرگراه لشگری (جاده مخصوص کرج)

روبروی پالایشگاه نفت پارس، پلاک ۱۲



CONTROLLER SELECTION GUIDE

Platform

AC-Powered Controllers

STANDARD

Details on [page 100](#)

Button and dial-based controllers are standalone systems that offer water-saving features and convenient remote control operation for faster maintenance.

Eco-Logic
Stations: 4, 6
[page 101](#)



X-Core™
Stations: 2, 4, 6, 8
[page 102](#)



X2™
Stations: 4, 6, 8, 14
[page 103](#)



Pro-C™
Stations: 4-16, 6, 12
[page 104](#)



I-Core™
Stations: 6-42 conventional, 1-48 with two-wire
[page 105](#)



HYDRAWISE®

Details on [page 108](#)

Hydrawise is simple to set up, easy to use, and packed with helpful features. Built-in system monitoring and a suite of powerful tools make saving water and managing multi-site municipal properties, community tracks, and commercial projects more convenient than ever before.

HC
Stations: 6, 12
[page 110](#)



WAND for X2
Stations: 4, 6, 8, 14
[page 111](#)

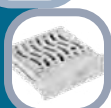

HPC
Stations: 4-16
[page 112](#)



Pro-HC
Stations: 6, 12, 24
[page 113](#)



HCC
Stations: 8-54 conventional, 1-54 with two-wire
[page 114](#)



CENTRALUS™

Details on [page 118](#)

Add cloud-based control and monitoring for ICC2 and ACC2 controllers with the mobile-friendly Centralus irrigation management platform.



ICC2
Stations: 8-54 conventional, 1-54 with two-wire
[page 119](#)



ACC2
Stations: 12-54 conventional, 1-225 with two-wire
[page 120](#)



Use this guide to quickly compare Hunter controller power needs, station counts, and software platforms to ensure you choose the best controller for every installation.

Platform

AC-Powered Controllers, Continued

IMMS™ ONLINE

Details on [page 122](#)

Simplify central control of Hunter ACC controllers and accessories with the web- or server-based IMMS software package.



ACC
Stations: 12-42 conventional, 1-99 with two-wire
[page 124](#)



Platform

Battery-Powered Controllers

INDEPENDENT

Details on [page 126](#)

Battery-powered controllers allow automatic irrigation for power-restricted valve locations and areas where hardscape blocks the ability to run wire affordably.

NODE

Stations: 1, 2, 4, 6
[page 128](#)



XC Hybrid

Stations: 6, 12
[page 130](#)



BLUETOOTH®

Details on [page 126](#)

Bluetooth enabled, battery-powered controllers have all the benefits of independent battery controllers with convenient, on-site wireless control from a smartphone.

BTT

Zones: 1, 2
[page 127](#)



NODE-BT

Stations: 1, 2, 4
[page 129](#)



Look for this icon to identify controllers with two-wire compatibility. Save wire and easily expand the system as needed after installation.

STANDARD CONTROLLERS



Standard controllers are self-contained irrigation systems designed for simple installation and programming. They offer locally measured weather monitoring capabilities for automatic schedule adjustments, the option of modular station flexibility, and convenient remote control operation for faster maintenance.

STANDARD CONTROLLER COMPARISON CHART

CONTROLLER MODELS	MAXIMUM STATIONS	SENSOR INPUTS	TWO-WIRE	REMOTE CONTROL	WEB ACCESS
ECO-LOGIC	6	1	None	None	None
X-CORE	8	1	None	ROAM, ROAM XL	None
X2	14	1	None	ROAM, ROAM XL, Smartphone with Wi-Fi	Hydrawise, Wi-Fi
PRO-C	16	1	None	ROAM, ROAM XL	None
I-CORE	42, 48 two-wire	2 (Click or Flow), 3 (Click or Flow, in metal)	DUAL, 48 stations	ROAM, ROAM XL	None

X-CORE™

This simple irrigation controller offers optional on-site smart ET watering adjustments and handheld remote operation.

KEY BENEFITS

- Number of stations:
 - 2, 4, 6, or 8 (fixed models)
- Solar Sync™ accessory saves water based on local weather conditions
- Built-in key lock on outdoor models protects against vandalism
- 3 flexible programs with 4 start times each and up to 4-hour run times
- QuickCheck™ provides simple diagnostics of faulty field wiring
- Hide Programs setting shows 1 program and 1 start time for simplification
- Suspend irrigation up to 99 days during the off-season
- Short-circuit protection detects wiring faults and skips the station without system damage
- Easy Retrieve™ memory backs up the full irrigation schedule
- Delay Between Stations for slow-closing valves or pump recharge
- Cycle and Soak prevents water waste and runoff in areas with elevation changes or tight soils
- Seasonal adjustment for quicker schedule adjustments without changing run times

OPERATING SPECIFICATIONS

- Transformer input: 120 VAC or 230 VAC
- Transformer output (24 VAC): 1 A
- Station output (24 VAC): 0.56 A
- P/MV output (24 VAC): 0.28 A
- Sensor inputs: 1
- Approvals: Plastic IP54 (outdoor), UL, cUL, FCC, CE, RCM
- Warranty period: 2 years



Plastic Indoor

Height: 16.5 cm
Width: 14.6 cm
Depth: 5 cm



Plastic Outdoor

Height: 22 cm
Width: 17.8 cm
Depth: 9.5 cm

X-CORE - SPECIFICATION BUILDER: ORDER 1 + 2 + 3 + 4

1	Model	2	Transformer	3	Indoor/Outdoor	4	Plug
	XC-2 = 2-station (indoor only)		00 = 120 VAC		(blank) = Outdoor model		(blank) = American plug
	XC-4 = 4-station		01 = 230 VAC		i = Indoor model		E = European connections
	XC-6 = 6-station						A = Australian plug
	XC-8 = 8-station						

Examples:

XC-801i-E = 8-station controller, 230 VAC European wall adapter, indoor

XC-801-A = 8-station controller, 230 VAC internal transformer, outdoor with Australian plug

Compatible with:



**Solar Sync
Sensor**
Page 146



ROAM Remote
Page 137
ROAM XL Remote
Page 138

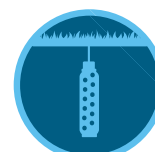

**Soil-Clik
Sensor**
Page 151



Smart WaterMark

Recognised as a responsible water-saving tool when used with a Solar Sync sensor

X2™

This online-capable controller features rapid schedule programming and advanced water-saving features.

KEY BENEFITS

- Number of stations:
 - 4, 6, 8, or 14 (fixed models)
- Wi-Fi capable controller automatically managed by Hydrawise® software
- Backlit display provides optimal visibility in any light
- 3 flexible programs with 4 start times each and up to 6-hour run times
- QuickCheck™ provides simple diagnostics of faulty field wiring
- Hide Programs option shows 1 program and 1 start time for simplification
- Suspend irrigation up to 99 days during the off-season
- Short-circuit protection detects wiring faults and skips the station without system damage
- Easy Retrieve™ memory backups the full irrigation schedule
- Delay Between Stations for slow-closing valves or pump recharge
- Cycle and Soak prevents water waste and runoff in areas with elevation changes or tight soils
- Seasonal adjustment for quicker schedule adjustments without changing run times

WI-FI MODULE BENEFITS

- Provides rapid programming, online irrigation management, and controller status alerts
- Standard ABC programming with 6 programs and 6 start times or advanced schedules with 36 start times, and run times up to 24 hours
- Predictive Watering™ provides precise weather adjustments for maximum water savings
- Compatibility with Amazon Alexa™ and Control4® home automation
- See complete WAND Wi-Fi module benefits and specifications on **page 111**

OPERATING SPECIFICATIONS

- Transformer input: 120 VAC or 230 VAC
- Transformer output (24 VAC): 1 A
- Station output (24 VAC): 0.56 A
- P/MV output (24 VAC): 0.28 A
- Sensor inputs: 1
- Approvals (controller): Plastic IP44, UL, cUL, FCC, CE, RCM
- Approvals (module): Wi-Fi b/g/n, Bluetooth 5.0, CE, UL, RCM, FCC
- Warranty period: 2 years

X2 - SPECIFICATION BUILDER: ORDER 1 + 2 + 3

1	Model	2	Transformer	3	Plug
	X2-4 = 4-station		00 = 120 VAC		(blank) = American plug
	X2-6 = 6-station		01 = 230 VAC		E = European plug
	X2-8 = 8-station				A = Australian plug
	X2-14 = 14-station				

Examples:

X2-1401-E = 14-station controller, 230 VAC internal transformer with European plug
 X2-1401-A = 14-station controller, 230 VAC internal transformer with Australian plug

WAND WI-FI MODULE

Model	Description
WAND	Wi-Fi module for Hydrawise water management software



X2
 Height: 23 cm
 Width: 19 cm
 Depth: 10 cm



WAND Wi-Fi Module
 Height: 2 cm
 Width: 5 cm
 Depth: 5 cm

Compatible with:



**Hydrawise®
 Software**
 Page 108



**Rain-Clik
 Sensor**
 Page 144



ROAM Remote
 Page 137
ROAM XL Remote
 Page 138



Smart WaterMark

Recognised as a responsible water-saving tool when used with the WAND Wi-Fi module

Amazon Alexa is a trademark of Amazon.com Inc. or its affiliates.
 Control4 is a registered trademark of Control4 Corporation in the United States and/or other countries.

PRO-C™

Simple programming and flexible station expansion make Pro-C the professional's choice for residential and light commercial systems.

KEY BENEFITS

- Number of stations:
 - Modular Pro-C capacity from 4 to 16
 - Fixed PCC with 6- and 12-station options
- 3 independent irrigation programs (4 start times each) allow for customised scheduling
- 6-hour maximum station run time provides flexibility for differing application amounts
- 1 sensor input available for use with Solar Sync™ or any Klik sensors
- 1 P/MV output for pump start relay and master valve activation
- Dedicated Solar Sync dial position provides logic for smart water savings
- Easy Retrieve™ memory allows for manual backup and retrieval of preferred settings and programming
- QuickCheck™ provides simple diagnostics of faulty field wiring

OPERATING SPECIFICATIONS

- Transformer input: 120 VAC or 230 VAC
- Transformer output (24 VAC): 1 A
- Station output (24 VAC): 0.56 A
- P/MV output (24 VAC): 0.28 A
- Approvals: UL, cUL, FCC, CE, RCM
- Warranty period: 2 years



Plastic Indoor

Height: 22.9 cm
Width: 25.4 cm
Depth: 11.4 cm



Plastic Outdoor

Height: 22.9 cm
Width: 25.4 cm
Depth: 11.4 cm

Compatible with:



**Solar Sync
Sensor**
Page 146



ROAM Remote
Page 137
ROAM XL Remote
Page 138



**Soil-Clik
Sensor**
Page 151



Smart WaterMark

Recognised as a responsible water-saving tool when used with a Solar Sync sensor

تهران، کیلومتر ۲۱ بزرگراه لشگری (جاده مخصوص کرج)

روبروی پالایشگاه نفت پارس، پلاک ۱۲

PRO-C - SPECIFICATION BUILDER: ORDER 1 + 2 + 3 + 4

1 Model	2 Transformer	3 Indoor/Outdoor	4 Options
PC-4 = 4-station base module controller	00 = 120 VAC	(blank) = Outdoor model (internal transformer)	(blank) = No option
PCC-6 = 6-station	01 = 230 VAC	i = Indoor model (plug-in transformer)	E = 230 VAC with European connections
PCC-12 = 12-station			A = 230 VAC with Australian connections (outdoor models have internal transformer with cord)

Examples:

PC-400 = Modular 4-station outdoor base unit, internal 120 VAC transformer, and plastic cabinet

PCC-601i-E = Fixed 6-station indoor controller, plug-in 230 VAC transformer with European connections, and plastic cabinet

PCC-1200 = Fixed 12-station outdoor controller, internal 120 VAC transformer, and plastic cabinet

PC-SERIES STATION EXPANSION

Modules	Description
PCM-300	3-station plug-in module
PCM-900	9-station plug-in module (maximum, one per controller)

www.famcocorp.com

E-mail: info@famcocorp.com

@famco_group

Tel: ۰۲۱-۴۸۰۰۰۰۴۹

Fax: ۰۲۱-۴۴۹۹۴۶۴۲

I-CORE™

Flow monitoring and two-wire capabilities make I-Core an ideal fit for standalone midsize commercial and high-end residential projects.

KEY BENEFITS

- Number of stations:
 - Conventional: 6 to 30 (plastic), 6 to 42 (metal and pedestals)
 - With DUAL™ decoder: up to 48
- 4 independent irrigation programs (8 start times each) allow for customised scheduling
- 12-hour maximum station run time provides flexibility for lower-flow zones
- Any 2 programs can operate simultaneously for more efficient watering
- Sensor inputs:
 - 2 (plastic)
 - 3 (metal and pedestal)
- 1 P/MV output for pump start relay and master valve activation
- Flow-monitoring capabilities provide real-time water usage data
- Programmable No Water Window prevents all irrigation for a specified time frame
- High-visibility, backlit display with 6 selectable languages

OPERATING SPECIFICATIONS

- Transformer input: 120/230 VAC
- Transformer output (24 VAC): 1.4 A
- Station output (24 VAC): 0.56 A
- P/MV output (24 VAC): 0.28 A
- Approvals: Plastic Wall Mount IP44, Metal IP56, Plastic Pedestal IP34, NEMA 3R, UL, cUL, FCC, CE, RCM
- Warranty period: 5 years



Plastic Outdoor

Height: 28 cm
Width: 33.7 cm
Depth: 15.9 cm

Metal Wall Mount

(grey or stainless steel)
Height: 31.4 cm
Width: 39.4 cm
Depth: 16.5 cm



Plastic Pedestal

Height: 99 cm
Width: 61 cm
Depth: 43 cm



Metal Pedestal

(grey or stainless steel)
Height: 91.4 cm
Width: 39.4 cm
Depth: 12.7 cm

I-CORE	
Model	Description
IC-600-PL	Base 6-station controller, indoor/outdoor, plastic cabinet
IC-600-M	Base 6-station controller, indoor/outdoor, metal cabinet
IC-600-PP	Base 6-station controller, indoor/outdoor, plastic pedestal
IC-600-SS	Base 6-station controller, indoor/outdoor, stainless steel cabinet
ICM-600	6-station plug-in expansion module
ACC-PED	Metal pedestal, grey powder-coated, for use with I-Core and ACC metal controllers
PED-SS	Stainless steel pedestal for use with I-Core and ACC stainless steel controllers

DUAL	
Model	Description
DUAL48M	DUAL decoder output module, up to 48-stations maximum
DUAL-1	DUAL 1-station decoder (includes 2 DBRY-6 connectors)
DUAL-2	DUAL 2-station decoder (includes 2 DBRY-6 connectors)
DUAL-S	DUAL surge arrester (includes 4 DBRY-6 connectors)

Compatible with:



**Solar Sync
Sensor**
Page 146

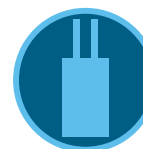

DUAL Decoder
Page 135



**Flow-Sync
Sensor**
Page 148
WFS Sensor
Page 149



Smart WaterMark

Recognised as a responsible water-saving tool when used with a Solar Sync sensor



CENTRALUS CONTROLLERS

CENTRALUS™ CONTROLLERS

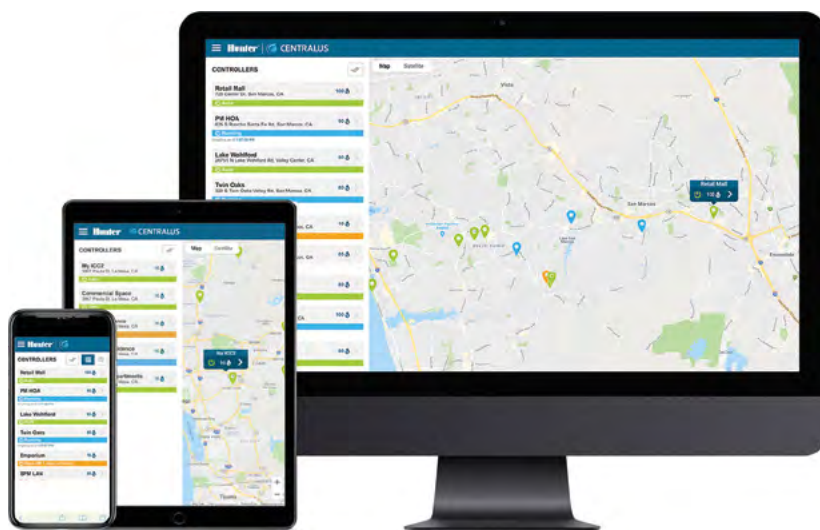

Centralus Software

Enable ICC2 and ACC2 controllers with next-generation management technology.

Mobile-Friendly

The mobile-friendly Centralus irrigation management platform provides highly secure, comprehensive cloud-based control and monitoring features. The connectivity allows you to view a controller's status, change settings, view forecasts, save water, and receive instant notification of important system alarms.

User-Friendly

The addition of internet access brings dial-based ICC2 and ACC2 controllers seamlessly into the world of next-generation irrigation control. From the intuitive Centralus dashboard, it is now easier than ever before to add alarm monitoring, location information, remote operation, and scheduling to ICC2 and ACC2 controllers.

Easy to Upgrade

To upgrade to Centralus control, add a simple Wi-Fi or LAN communication module to the controller:

- ICC2: Add WIFIKIT or LANKIT
- ACC2: Add A2C-WIFI or A2C-LAN

CENTRALUS CONTROLLER COMPARISON CHART

CONTROLLER MODELS	MAXIMUM STATIONS	SENSOR INPUTS	TWO-WIRE	REMOTE CONTROL	WEB ACCESS
ICC2	54	1	EZDS, 54 stations	ROAM, ROAM XL, Smartphone with Wi-Fi	Centralus*: Wi-Fi, LAN
ACC2	54, 225 two-wire	3 Klik, 6 Flow	ICD, 225 stations	ROAM, ROAM XL, Smartphone with Wi-Fi	Centralus*: Wi-Fi, LAN

*Cellular connections available in 2020.

CENTRALUS™ SOFTWARE

Add cloud-based control and monitoring for ICC2 and ACC2 controllers with the mobile-friendly Centralus irrigation management platform.

KEY BENEFITS

- Browser-based programming and communication software
- Highly secure cloud access
- Map-based navigation and status
- Instant remote control from mobile device
- Flow monitoring and reporting
- Alarm reporting and detailed irrigation history reports
- Responsive web design configures for your device, allowing the same controls from your smartphone, tablet, or desktop
- Ethernet or Wi-Fi connectivity options
- Built-in Solar Sync™ logic/Solar Sync Delay features for smart water savings
- Professional crewmember administration with multiple levels of access
- Organise maintenance teams and their controllers into management groups

OPERATING SPECIFICATIONS

- Operates in most modern browsers (Internet Explorer® is no longer supported and may not display all screens correctly)
- Secure internet connection for web-hosted application

USER-INSTALLED OPTIONS

- Solar Sync smart weather sensors, one per controller
- Flow sensors including Flow-Sync, WFS, and other approved equals
- Connected controllers are compatible with ROAM/ROAM XL licence-free remote control (pre-wired controller connection)

COMMUNICATION OPTIONS

- Ethernet with RJ-45 connection, low data requirements
- Wi-Fi 802.11 b/g/n, 2.4 GHz

COMMUNICATIONS

Model	Description
WIFIKIT	ICC2 Wi-Fi connection
LANKIT	ICC2 LAN (Ethernet) connection
A2C-WIFI	ACC2 Wi-Fi connection
A2C-LAN	ACC2 LAN (Ethernet) connection



WIFIKIT
Height: 10.8 cm
Width: 6.4 cm (installed)
Depth: 3.5 cm

COMMUNICATIONS ACCESSORIES

Model	Description
WIFIEXTKIT	Antenna extension, conduit mount (up to 3 m cable), use with A2C-WIFI only



LANKIT
Height: 10.8 cm
Width: 6.4 cm (installed)
Depth: 3.5 cm

Internet Explorer is a trademark of Microsoft Corporation.

www.famcocorp.com

E-mail: info@famcocorp.com

@famco_group

Tel: ۰۲۱-۴۸۰۰۰۰۴۹

Fax: ۰۲۱-۴۴۹۹۴۶۴۲

ACC2 COMMUNICATION MODULE INSTALLATION



A2C-WIFI is installed behind the ACC2 facepack

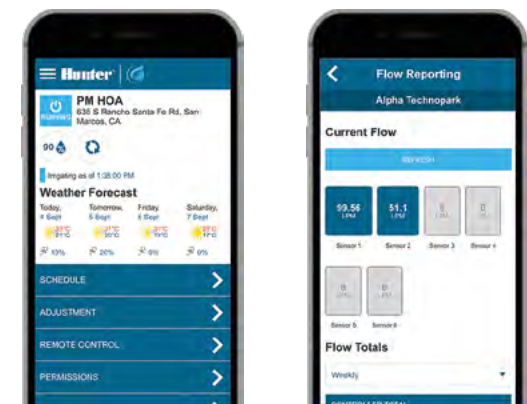

Manage and monitor controllers from anywhere

ICC2 WIFIKIT INSTALLATION



تهران، کیلومتر ۲۱ بزرگراه لشگری (جاده مخصوص کرج)

روبروی پالایشگاه نفت پارس، پلاک ۱۲

ICC2

This reliable control system can run conventional, two-wire, or hybrid operations with the option to upgrade to Centralus™ cloud-based control.

KEY BENEFITS

- Number of stations:
 - Conventional: 8 to 38 (plastic), 8 to 54 (metal and pedestal)
 - With two-wire EZDS: up to 54 (all enclosure options)
- 4 independent irrigation programs (8 start times each) allow for customised scheduling
- 12-hour maximum station run time provides flexibility for low-flow zones
- Any 2 programs can operate simultaneously, providing more efficient watering
- 1 sensor input available for use with Solar Sync™ or any Clik sensors
- 1 P/MV output for pump start relay and master valve activation
- Backward compatibility to original ICC controllers allows for quick updates to older systems
- Upgradeable to Centralus software for web-based central control options

OPERATING SPECIFICATIONS

- Transformer input: 120/230 VAC
- Transformer output (24 VAC): 1.4 A
- Station output (24 VAC): 0.56 A
- P/MV output (24 VAC): 0.56 A
- Approvals: Wall Mounts IP44, Plastic Pedestal IP34, NEMA 3R, UL, cUL, FCC, CE, RCM
- Warranty period: 5 years

USER-INSTALLED OPTIONS

- WIFIKIT or LANKIT communications for Centralus web-based control
- Compatible with Flow-Clik™ sensor for catastrophic high-flow shutdown

ICC2	
Model	Description
I2C-800-PL	8-station base model, plastic outdoor wall mount
I2C-800-M	8-station base model, grey metal outdoor, wall mount
I2C-800-SS	8-station base model, stainless steel, wall mount
I2C-800-PP	8-station base model, plastic pedestal
ICC-FPUP2	ICC2 retrofit kit for original ICC controllers
ICC-PED	Grey pedestal for metal wall mount
ICC-PED-SS	Stainless steel pedestal for stainless wall mount
ICC-PWB	Optional pedestal wiring board for metal pedestals

ICC2 SERIES STATION EXPANSION	
Model	Description
ICM-400	4-station plug-in module with enhanced surge suppression
ICM-800	8-station plug-in module with enhanced surge suppression
ICM-2200	22-station expansion module (one per controller)
EZ-DM	54-station decoder output module (one per controller)
EZ-1	Single-station EZ decoder



Plastic

Height: 30.5 cm
Width: 35 cm
Depth: 12.7 cm

Metal

(grey or stainless steel)
Height: 40.6 cm
Width: 33 cm
Depth: 12.7 cm



Metal Pedestal

(grey or stainless steel)
Height: 91.4 cm
Width: 29.2 cm
Depth: 12.7 cm



Plastic Pedestal

Height: 99 cm
Width: 61 cm
Depth: 43 cm

Compatible with:



**Solar Sync
Sensor**
Page 146



ROAM Remote
Page 137
ROAM XL Remote
Page 138

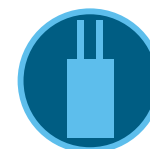

**EZ Decoder
System**
Page 134



Smart WaterMark

Recognised as a responsible water-saving tool when used with a Solar Sync sensor

ACC2

The multi-flow monitoring and management capabilities of ACC2 make it the best choice for complex projects.

KEY BENEFITS

- Number of stations:
 - 12 to 225, for large projects
- Up to 6 flow sensor inputs and 6 P/MV outputs
- 32 automatic programs (10 start times each) for precise plant management
- Block function to group stations and consolidate large systems
- Built-in Solar Sync™ logic for smart water savings
- Real-time flow monitoring detects and diagnoses leaks in up to 6 flow zones
- Flow management optimises watering at safe velocities
- High-visibility, full-colour display with reversible facepack
- Conditional Response “if/then” programming for active responses to sensor inputs
- User management password protection, with two levels of access
- Optional plug-in communications modules for cloud or network control
- Detailed alarm logs in plain language
- Extreme service lightning protection
- Easy Retrieve™ programming backup and restore
- Non-Water Windows to inhibit accidental irrigation

OPERATING SPECIFICATIONS

- Transformer input: 120/230 VAC
- Maximum AC current draw: 120 VAC, 2 A/230 VAC, 1 A
- Transformer output: 24 VAC, ~3 A
- P/MV outputs (24 VAC): Up to 6; 3 included, 0.8 A each
- Sensor inputs: 3 Clik, 1 Solar Sync, and up to 6 Flow sensors (3 included)
- Approvals: Wall Mounts IP44, Plastic Pedestal IP34, NEMA 3R, UL, cUL, FCC, CE, RCM
- Warranty period: 5 years

USER-INSTALLED OPTIONS

- ROAM/ROAM XL remote controls
- WSS-SEN or SOLAR-SYNC-SEN for automatic water savings
- Flow sensors (up to 6) including Flow-Sync, WFS, and other approved equals



Metal Wall Mount
(grey or stainless steel)
Height: 40 cm
Width: 40 cm
Depth: 18 cm



Plastic Wall Mount
Height: 42 cm
Width: 42 cm
Depth: 17 cm



Metal Pedestals
(grey or stainless steel)
Height: 94 cm
Width: 39 cm
Depth: 13 cm



Plastic Pedestal
Height: 97 cm
Width: 55 cm
Depth: 40 cm

Compatible with:



Solar Sync Sensor
Page 146



Flow-Sync Sensor
Page 148
WFS Sensor
Page 149



ROAM Remote
Page 137
ROAM XL Remote
Page 138



Smart WaterMark

Recognised as a responsible water-saving tool when used with a Solar Sync sensor

ADDITIONAL SPECIFICATIONS BY MODEL

ACC2 CONVENTIONAL

- Number of stations:
 - 12 to 54, for large projects
- Simultaneous station operation: up to 14 solenoids
- Expands in 6-station increments
- Extreme service lightning protection, standard on all A2M-600 output modules
- Station outputs: 0.8 A each

ACC2 CONVENTIONAL MODELS	
Model	Description
A2C-1200-M	12-station base unit controller, expands to 54 stations, grey steel wall mount, outdoor
A2C-1200-P	12-station base unit controller, expands to 54 stations, plastic outdoor wall mount
A2C-1200-SS	12-station base unit controller, expands to 54 stations, stainless steel wall mount, outdoor
A2C-1200-PP	12-station base unit controller, expands to 54 stations, plastic pedestal
A2M-600	6-station plug-in module for use with the A2C-1200 series controllers

ACC2 DECODER

- Number of stations:
 - 75, 150, or 225, for large projects
- Simultaneous station operation: up to 30 solenoids
- Operates Hunter's premium ICD decoders over ID wire:
 - Up to 3 km (2 mm² wire)
 - Up to 4.5 km (3 mm² wire)
- See complete ICD decoder key benefits and specifications on **page 133**
- Up to 3 two-wire paths per output module
- Diagnostics including decoder inventory, wire tracker, solenoid finder, and more

ACC2 DECODER MODELS	
Model	Description
A2C-75D-M	75-station base model, grey metal outdoor, wall mount
A2C-75D-P	75-station base model, plastic outdoor, wall mount
A2C-75D-SS	75-station base model, stainless steel, wall mount
A2C-75D-PP	75-station base model, plastic pedestal
A2C-D75	75-station decoder expansion module

ACC2 ACCESSORIES FOR ALL MODELS

ACC2 ACCESSORIES	
Model	Description
A2C-F3	Optional flow meter expansion module (adds 3 inputs)
A2C-LEDKT	External status light shows controller status with door closed
A2C-WIFI	ACC2 Wi-Fi connection
A2C-LAN	ACC2 LAN (Ethernet) connection
ACC-PED	Grey pedestal for wall mount
PED-SS	Stainless steel pedestal for wall mount

A2C-CELL-E cellular connection coming in early 2020

ACC2 - REVERSIBLE FACEPACK



COMMUNICATION OPTIONS FOR ACC INTERFACE

Model	Purpose
ACC-COM-HWR = Hardwire/radio module*	Supports hardwire and radio communication options
ACC-COM-LAN = Ethernet module*	Supports TCP/IP in Ethernet networks in addition to hardwire and radio sharing with local controllers
ACC-COM-GPRS-E = GPRS cellular data module*	Supports mobile data connection via GPRS phone in addition to hardwire and radio sharing with local controllers

Note:

* Also supports radio and hardwire

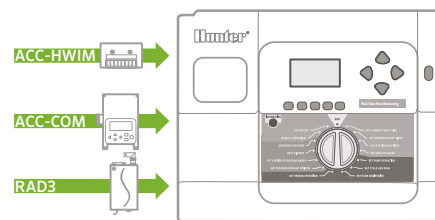

ACC wall-mount communication components

USER-INSTALLED OPTIONS (SPECIFY SEPARATELY)

Model	Description	Purpose
ACC-HWIM	Hardwire interface module required for hardwire connections	Provides surge-protected terminals for hardwired cable connections
RAD460INT	UHF radio module (international), 440–480 MHz; consult factory for other international frequency ranges	UHF radio module for wireless connections, international only (licence and antenna required and not included)
APPBRKT2	Communication bracket for newer plastic pedestals (April 2017)	Holds comm modules and accessories in new-style plastic pedestal

Model	Description	Options	Purpose
IMMS-CCC	Hardwire central interface	None = 120 VAC (North America) E = 230 VAC (Europe/international power) A = 230 VAC (Australia)	Hardwired central interface for connection to site via direct wire (GCBL cable)
GCBL*	100 = 30 m 300 = 90 m 500 = 150 m		Cable for all IMMS hardwired communications

Note:

* GCBL available in 300 m increments (up to 1,200 m)

RADIO ANTENNA OPTIONS (SPECIFY SEPARATELY)

Model	Description
IMMS-ANT2	Omnidirectional antenna fits ACC plastic pedestal lid
IMMS-ANT3	Omnidirectional antenna for wall or pole mount
IMMS-ANTYAGI3	High-efficiency directional antenna for pole mount
RA5M	High-gain omnidirectional mast antenna for roof or pole mount

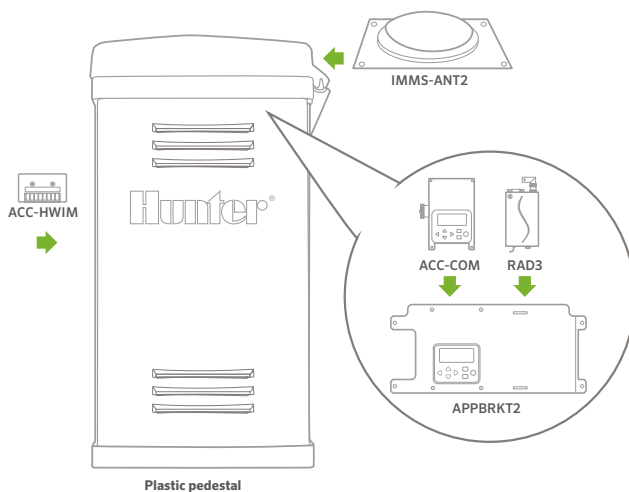

ACC plastic pedestal communication components



Smart WaterMark

Recognised as a responsible water-saving tool when used with a Solar Sync sensor

ACC

Powerful features and simple programming are hallmarks of this proven, flow-monitoring commercial controller.

KEY BENEFITS

- Number of stations:
 - 12 to 99, for large projects
- 6 automatic programs (10 start times each)
- SSGs (Simultaneous Station Groups) to consolidate large systems
- Built-in Solar Sync™ logic for smart water savings
- Real-time flow monitoring detects and diagnoses leaks with optional flow sensor
- Detailed alarm logs in plain language
- Programmable Rain Delay after sensor shutdown
- Easy Retrieve™ programming backup and restore
- Non-Water Windows to inhibit accidental irrigation
- Cycle and Soak, Delay Between Stations

OPERATING SPECIFICATIONS

- Transformer input: 120/230 VAC
- Maximum AC current draw: 120 VAC, 2A/230 VAC, 1 A
- Transformer output: 24 VAC, 4 A
- Station outputs: 0.56 A
- 2 P/MV outputs (24 VAC): 0.325 A each
- Simultaneous program operation: Up to 6 automatic programs
- Sensor inputs: 4 Clik, 1 Solar Sync, and 1 Flow sensor
- Approvals: Wall Mounts IP44, Plastic Pedestal IP34, NEMA 3R, UL, cUL, FCC, CE, RCM
- Warranty period: 5 years

USER-INSTALLED OPTIONS

- Solar Sync smart weather sensor
- Flow sensor including Flow-Sync, WFS, and other approved equals
- ROAM/ROAM XL licence-free remote control (pre-wired controller connection)
- Communication modules for IMMS™ central software on **page 122**



Metal Enclosures

(grey or stainless steel)
Height: 31 cm
Width: 39 cm
Depth: 16 cm



Metal Pedestals

(grey or stainless steel)
Height: 92 cm
Width: 38 cm
Depth: 13 cm

Plastic Pedestal

Height: 99 cm
Width: 61 cm
Depth: 43 cm

Compatible with:



**Solar Sync
Sensor**
Page 146



ROAM Remote
Page 137
ROAM XL Remote
Page 138



**Flow-Sync
Sensor**
Page 148
WFS Sensor
Page 149



Smart WaterMark

Recognised as a responsible water-saving tool when used with a Solar Sync sensor

ADDITIONAL SPECIFICATIONS BY MODEL

ACC-1200 CONVENTIONAL

- Number of stations:
 - 12 to 42
- Modular expansion in 6-station increments
- Extreme service lightning protection, standard on all output modules

ACC-1200 CONVENTIONAL MODELS	
Model	Description
A2C-1200-M	12-station base unit controller, expands to 54 stations, grey steel wall mount, outdoor
A2C-1200-SS	12-station base unit controller, expands to 54 stations, stainless steel wall mount, outdoor
A2C-1200-PP	12-station base unit controller, expands to 54 stations, plastic pedestal
A2M-600	6-station plug-in module for use with the A2C-1200 series controllers

ACC-99D DECODER

- Number of stations:
 - 99 decoder stations
- Operates Hunter's premium ICD decoders over ID wire:
 - Up to 3 km (2 mm² wire)
 - Up to 4.5 km (3 mm² wire)
- Up to 6 two-wire paths for maximum flexibility
- 1-, 2-, 4-, and 6-station decoders plus ICD-SEN sensor input decoders
- See complete ICD decoder key benefits and specifications on **page 133**

ACC-99D DECODER	
Model	Description
ACC-99D	2-wire decoder controller with 99-station capacity, metal cabinet
ACC-99D-SS	2-wire decoder controller with 99-station capacity, stainless steel wall mount
ACC-99D-PP	2-wire decoder controller with 99-station capacity, plastic pedestal
ADM-99	Decoder output module

ACC ACCESSORIES FOR ALL MODELS

ACC ACCESSORIES	
Model	Description
ACC-PED	Grey pedestal for wall mount
PED-SS	Stainless steel pedestal for wall mount

ACC – CONTROL FOR COMMERCIAL PROJECTS



BATTERY-POWERED CONTROLLERS

BATTERY-POWERED CONTROLLERS

BATTERY-OPERATED CONTROLLER COMPARISON CHART

CONTROLLER MODELS	MAXIMUM STATIONS	SENSOR INPUTS	REMOTE CONTROL	SOLAR
BTT	2	None	BTT Bluetooth App	None
NODE	6	1	None	SPNODE
NODE-BT	4	2	NODE-BT Bluetooth App	None
XC HYBRID	12	1	None	SPXCH, XCH-600-SSP, XCH-1200-SSP

BTT

Take advantage of smartphone-controlled, above-ground irrigation for easier access to the hose tap.

KEY BENEFITS

- Number of zones: - 1 or 2
- Battery-operated tap timer with Bluetooth® control
- 1 smartphone manages an unlimited number of controllers
- 1-second to 24-hour run time with 4 start times
- Cycling mode repeats continuously within user-defined water windows, perfect for drip systems or germinating seeds
- Suspend irrigation up to 99 days during the off-season, perfect for seasonal markets
- Manual push-button operation for quick operation without a smartphone
- Automatic water shutoff after 1 hour prevents water waste
- Blinking LED low-battery alert indicates battery replacement
- Secure passcode protection prevents unauthorised schedule changes
- Alkaline batteries included for quicker installation
- Includes quick coupler adapter

OPERATING SPECIFICATIONS

- Two 1.5V AA alkaline batteries (included)
- BTT-101 flow rate: 19 to 64 l/min (1,130 to 3,860 l/hr)
- BTT-201 flow rate: 15 to 57 l/min (908 to 3,840 l/hr)
- Recommended pressure: 0.5 to 8 bar (50 to 800 kPa)
- Approvals: Plastic IPX6, Bluetooth 4.2 BLE, UL, cUL, FCC, CE, RCM
- Warranty period: 2 years

APP SPECIFICATIONS

- iOS® 9.0 or above
- Android™ 4.4 or above
- Maximum communication distance: 10 m



BTT-101
Inlet diameter: ¾" and 1"
Outlet diameter: ¾"
Height: 16.8 cm
Width: 12 cm
Depth: 6 cm



BTT-201
Inlet diameter: ¾" and 1"
Outlet diameter: ¾"
Height: 15.7 cm
Width: 13.5 cm
Depth: 7.6 cm



BTT-LOC
(optional)
Inlet diameter: ¾"
Outlet diameter: 16-18 mm dripline
Height: 7 cm
Width: 3 cm



Pressure Regulator
(optional)
Inlet diameter: ¾"
Outlet diameter: ¾"
Height: 7 cm
Width: 4 cm

BTT	
Model	Description
BTT-101	1-zone Bluetooth Tap Timer, 1" BSP and ¾" hose thread, quick coupler adapter
BTT-201	2-zone Bluetooth Tap Timer, 1" BSP and ¾" hose thread, quick coupler adapter
BTT-LOC	BTT adapter for 16-18 mm dripline

PRESSURE REGULATOR	
Model	Description
PRLG203FH3MH	1.4 bar (140 kPa) pressure regulator, ¾" hose thread
PRLG253FH3MH	1.7 bar (170 kPa) pressure regulator, ¾" hose thread
PRLG303FH3MH	2 bar (200 kPa) pressure regulator, ¾" hose thread
PRLG403FH3MH	2.8 bar (280 kPa) pressure regulator, ¾" hose thread

BTT



The Bluetooth® word mark and logos are registered trademarks owned by Bluetooth SIG Inc. and any use of such marks by Hunter Industries is under license. iOS is a trademark or registered trademark of Cisco in the U.S. and other countries and is used under license. Android is a trademark of Google LLC

www.famcocorp.com

E-mail: info@famcocorp.com

@famco_group

Tel: ۰۲۱-۴۸۰۰۰۰۴۹

Fax: ۰۲۱-۴۴۹۹۴۶۴۲

تهران، کیلومتر ۲۱ بزرگراه لشگری (جاده مخصوص کرج)

روبروی پالایشگاه نفت پارس، پلاک ۱۲

NODE

This battery-powered, waterproof controller offers automatic irrigation control for temporary irrigation and sites without electricity.

KEY BENEFITS

- Number of stations:
– 1, 2, 4, or 6
- Battery-operated controller for automatic irrigation without AC power
- Battery-life indicator for battery replacement
- Waterproof enclosure seal protects against water ingress
- 3 flexible programs with 4 start times each and up to 6-hour run times
- Suspend irrigation up to 99 days during the off-season
- Easy Retrieve™ memory backs up the full irrigation schedule if ever changed
- Delay Between Stations for slow-closing valves or pump recharge
- Seasonal adjustment for quicker schedule adjustments without changing run times
- Solar panel provides maintenance-free operation
- Mounts to Hunter solenoids, pipes, flat surfaces, or inside the valve box

OPERATING SPECIFICATIONS

- One or two 9V alkaline batteries or 1800 mAh solar panel with charging cell
- Operates DC-latching solenoids (P/N 458200)
- 30 m maximum wire runs, 1 mm² wire only
- Station output: 9-11 VDC
- P/MV output: 9-11 VDC
- Sensor inputs: 1
- Approvals: IP68, UL, cUL, FCC, CE, RCM
- Warranty period: 2 years

NODE	
Model	Description
NODE-100	Single-station controller and DC-latching solenoid
NODE-100-LS	Single-station controller
NODE-200	2-station controller
NODE-400	4-station controller
NODE-600	6-station controller
NODE-100-VALVE	Single-station controller with PGV-101G valve and DC-latching solenoid (NPT threads)
NODE-100-VALVE-B	Single-station controller with PGV-101G-B valve and DC-latching solenoid (BSP threads)
458200	DC-latching solenoid



NODE

Diameter: 8.9 cm
Height: 6.4 cm



SPXCH

Solar panel kit (optional)
Height: 8 cm
Width: 8 cm
Depth: 2 cm

NODE



Compatible with:



Mini-Clik
Sensor
Page 145



Freeze-Clik
Sensor
Page 152

تهران، کیلومتر ۲۱ بزرگراه لشگری (جاده مخصوص کرج)

روبروی پالایشگاه نفت پارس، پلاک ۱۲

NODE-BT

Manage gardens, greenhouses, traffic medians, and temporary irrigation sites from a smartphone without opening the valve box.

KEY BENEFITS

- Number of stations:
– 1, 2, or 4
- Bluetooth® battery-operated controller for automatic irrigation without AC power
- 1 smartphone manages an unlimited number of controllers
- Waterproof enclosure seal protects against water ingress
- Active station LEDs and battery-life LED indicator for easy battery replacement
- 3 programs with 8 start times each and 1 second to 12-hour run times
- Suspend irrigation up to 99 days during the off-season
- Manual push-button operation for quick operation without a smartphone
- Delay Between Stations for slow-closing valves or pump recharge
- Add soil moisture sensor for compliance with LEED projects and agricultural applications
- Cycle and Soak prevents water waste and runoff in areas with elevation changes or tight soils
- Monthly and global seasonal adjustment for quicker schedule adjustments without changing run times
- Secure passcode protection prevents unauthorised schedule changes
- Mounts to Hunter solenoids, pipes, flat surfaces, or inside the valve box

OPERATING SPECIFICATIONS

- One or two 9V alkaline batteries
- Operates DC-latching solenoids (P/N 458200)
- 30 m maximum wire runs, 1 mm² wire only
- Station output: 9-11 VDC
- P/MV output: 9-11 VDC
- Sensor inputs: 2
- Approvals: IP68, Bluetooth 5.0 BLE, UL, cUL, FCC, CE, RCM
- Warranty period: 2 years

APP SPECIFICATIONS

- iOS® 9.0 or above
- Android™ 5.0 or above
- Maximum communication distance: 15 m

NODE-BT	
Model	Description
NODE-BT-100	Single-station Bluetooth battery controller and DC-latching solenoid
NODE-BT-100-LS	Single-station Bluetooth battery controller
NODE-BT-200	2-station Bluetooth battery controller
NODE-BT-400	4-station Bluetooth battery controller
NODE-BT-100-VALVE	Single-station Bluetooth battery controller with PGV-101G valve and DC-latching solenoid (NPT threads)
NODE-BT-100-VALVE-B	Single-station Bluetooth battery controller with PGV-101G-B valve and DC-latching solenoid (BSP threads)
458200	DC-latching solenoid
SC-PROBE	Soil probe for moisture sensing

The Bluetooth® word mark and logos are registered trademarks owned by Bluetooth SIG Inc. and any use of such marks by Hunter Industries is under license. iOS is a trademark or registered trademark of Cisco in the U.S. and other countries and is used under license. Android is a trademark of Google LLC.

www.famcocorp.com

E-mail: info@famcocorp.com

@famco_group

Tel: ۰۲۱-۴۸۰۰۰۰۴۹

Fax: ۰۲۱-۴۴۹۹۴۶۴۲



NODE-BT

Diameter: 8.9 cm
Height: 8.3 cm



SC-PROBE Soil Moisture Sensor Probe

Diameter: 2.5 cm
Height: 8.3 cm
Controller to probe: 30 m maximum
1 mm² direct-burial wire

NODE-BT

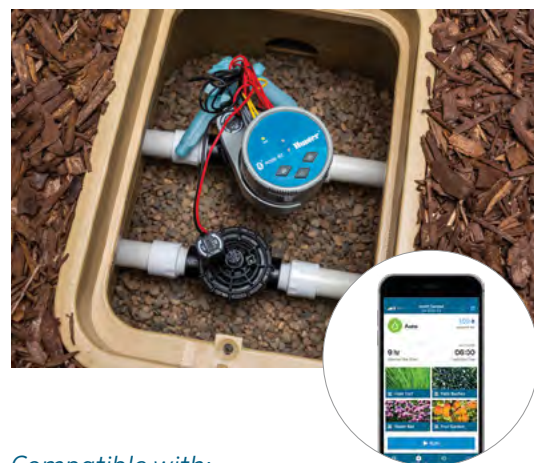

Compatible with:



Mini-Clik
Sensor
Page 145



Freeze-Clik
Sensor
Page 152

تهران، کیلومتر ۲۱ بزرگراه لشگری (جاده مخصوص کرج)

روبروی پالایشگاه نفت پارس، پلاک ۱۲