

Brief Introduction :

1. The rated voltage can be from 100V to 240VAC. The frequency can be either 50Hz, or 60Hz, or 50/60Hz.
2. The motor can be made of 2 poles, 4 poles, 6 poles, etc as needed. Single speed, 2 speeds, 3 speeds or 4 speeds are all available.
3. The standard shaft diameter (d) is Ø8mm. It can be others, and with D-cuts, threads, etc.. Its length (L2) can be any as needed.
4. The stator height (H) can be any from 20mm to 50mm.
5. The bearing brackets (housing) can be made either by steel sheet or by zinc-aluminum alloy, with or without a mounting flange.
6. The rotor bearings can be of either sleeve bearings (bush) or ball bearings as needed to reach different lifetime.
7. The motor rotation can be either in CW or CCW direction as needed.
8. RoHS compliant is available.
9. The motor is CCC certified. **Certificate No.: 2017010401996939.**

Typical Application :

These motors are mainly used for **Ventilators, Exhausters, Air-purifiers**, Table Fans, Desk Fans, Floor Fans, Wall Fans, Box Fans, etc.

Outline Dimensions (All dimensions in millimeter) :

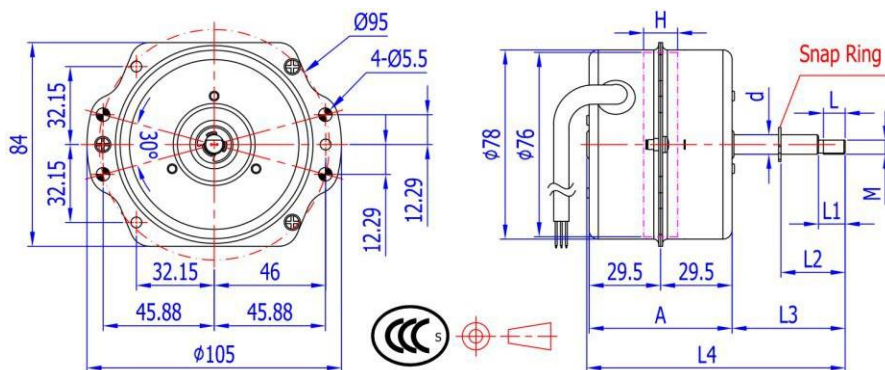

NCP7614M with metal sheet cover



Indication of the above letters (can be changed as needed): H=14mm, stator height
A=59mm, motor housing total height, will be different by different stator height
L: thread length L1: D-cut part length L2: snap ring position Length
d: shaft diameter L3: shaft extended length L4: motor total length M=M8, thread size

Technical Performances (tested under room temperature) :

Specs Model	Stack Height (mm)	Number of Poles ----	Rated Power (Watts)	Rated Supply		@ No Load			On Load			@ Stall	
				Volt.	Freq.	Current	Input P.	Speed	Current	Input P.	Speed	Current	Input P.
				(VAC)	(Hz)	(Amp)	(Watts)	(rpm)	(Amp)	(Watts)	(rpm)	(Amp)	(Watts)
NCP7611S-001	11	4P	4										
NCP7614S-001	14	4P	4	220	50	0.13	29	1420	0.16	34	1300		
NCP7614S-002			6										
NCP7616S-001	16	4P	5										
NCP7616S-002			7										
NCP7618S-001	18	4P	7										
NCP7618S-002			9										
NCP7620S-001	20	4P	9										
NCP7620S-002			11										

Remarks: This catalog listed just some typical models. The performances as above are just for reference only. We can adjust our motor specifications according to what the customer needs. OEM & ODM are both welcome.



Brief Introduction :

1. The rated voltage and the frequency can be any as needed.
2. The output power of the motor can be from 1 - 25W (approx.).
3. The shaft diameter (d) can be: Ø3.17, Ø4, Ø 4.5, Ø5, Ø5.5, Ø6, Ø6.35mm, with D-cuts, threads, etc., and the shaft length (L) can be any as needed.
4. The stator thickness (H) can be any from 8mm to 50mm.
5. The bearing can be either sleeve or ball bearing as needed.
6. The brackets can be made either by steel or by zinc-aluminum alloy.
7. Motor rotation can be either CW or CCW as needed.
8. RoHS compliant is available. Lead out by terminals is also available



Typical Application :

Air-conditioner, Air-purifier, Air Pump, Blower, Fan Heater, Hand-dryer, Humidifier, Oven, Ventilator, Water Pump, etc

Outline Dimensions (All dimensions in millimeter) :

UL File No.: E326620

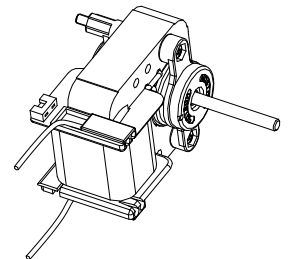
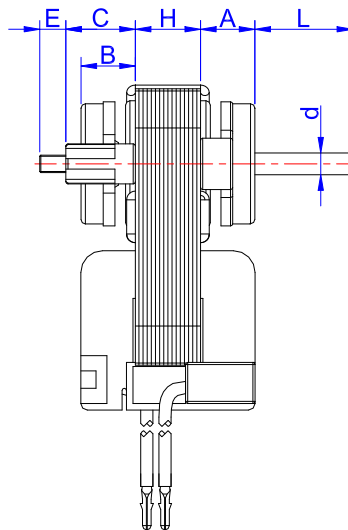
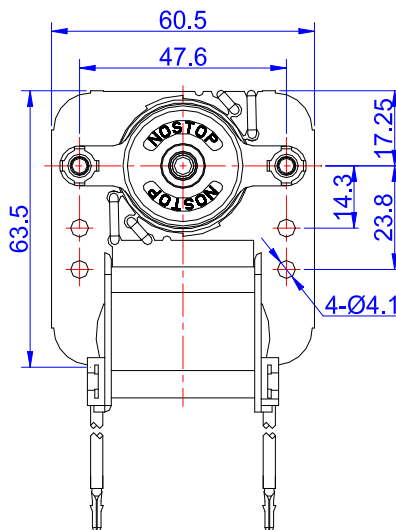

Indication of Letters:

- A: Front Bracket Height
- B: Rear Bracket Height
- C: Raising Pole Height
- D: Shaft Diameter
- E: Mounting Screw Ex. Length
- H: Stator Stack Height
- L: Shaft Extended Length

Remarks: only the dimensions marked in letters are changeable as needed. Other dimensions are fixed.

Technical Performances (tested under room temperature) :

UL File No.: E326620

Specs Model	Stack Height (mm)	Rated Supply		No Load			At Max. Efficiency.				At Stall	
		Volt. (VAC)	Freq. (Hz)	Current (Amp)	Speed (rpm)	Power (Watts)	Current (Amp)	Speed (rpm)	Power (Watts)	Torque (mNm)	Current (Amp)	Power (Watts)
NSP6312	12	230	50	0.115	2750	11.7	0.119	1960	15.6	7.0	0.125	15.4
NSP6313	13	120	60	0.409	3378	18.7	0.445	2792	23.2	14.8	0.502	26.7
		120	60	0.500	3320	23.6	0.543	2366	31.7	12.6	0.570	32.5
NSP6315	15	230	50	0.230	2750	20.0	0.250	1612	27.2	18.3	0.250	27.5
		120	60	0.610	3400	26.3	0.850	2400	41.5	21.5	0.700	34.0
NSP6318	18	220	50	0.362	2800	31.0	0.412	2530	12.5	28.7	0.448	50.8
		120	60	0.632	3436	30.1	0.830	2864	40.3	26.7	0.787	41.5
NSP6322	22	220	50	0.193	2850	18.0	0.245	2450	21.0	12.3	0.287	31.3
		120	60	0.322	3500	17.8	0.420	2800	27.6	19.0	0.522	33.6
NSP6338	38	240	50	0.921	2900	83.0	1.650	2500	94.1	50.8	1.280	148.2
		120	60	1.570	3500	80.7	1.962	2775	124.6	88.3	2.300	138.0

Remarks: This catalog listed just some typical models. The performances as above are just for reference only. We can adjust our motor specifications according to what the customer needs. OEM & ODM are both welcome.

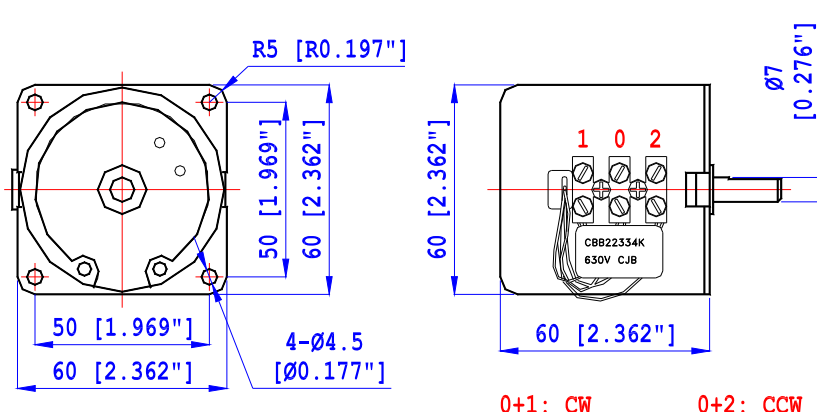

Main Application:

Mainly used for Automatic Curtains, Stage Lights, Electric Advertisement, Electric Appliances, Pumps, Scientific & Teaching Devices, etc which needs high torque but low speed.

Main Features:

- 1) Shaft diameter is: Ø7.0mm. Shaft length and shape can be any as customers' needs.
- 2) Reversible. Motor rotation direction can be CW or CCW controlled by capacitor.
- 3) Low lifetime (more than 8000 hours), low noise [less than 42dB(A)], stable running.
- 4) High torque available. If customer doesn't need high torque, we can use permanent magnet which is cheaper. But if customer needs high torque, we can use either plastic magnet (with 30% more torque) or even Nd-Fe-B (with 90% more torque). Please see the details as following chart.
- 5) CE, UL, TUV approved.

Characteristics (test under room temperature):

Rated Voltage		(VAC)	12~240 (can be any as needed)															
Rated Frequency		(Hz)	50 or 60 or 50/60															
Input Power		(W)	≤20															
Input Current		(mA)	≤55															
Starting Voltage		(VAC)	≤85% of rated voltage															
Insulation Class		-	E (or any as needed)															
Rated Speed	@ 50Hz	(rpm)	2.5	3.8	5.0	7.5	10	12.0	15	20	25	30	40	50	60	80	110	
	@ 60Hz	(rpm)	3.0	4.5	6.0	9.0	12	14.4	18	24	30	36	48	60	72	96	132	
Rated Torque @ 50Hz	Permanent Magnet	(Nm)	4.41	3.14	2.55	1.96	1.47	1.32	0.98	0.74	0.64	0.49	0.39	0.29	0.25	0.20	0.14	
		(Kg _f .cm)	45	32	26	20	15	13.5	10.0	7.5	6.5	5.0	4.0	3.0	2.5	2.0	1.4	
	Plastic Magnet	(Nm)	5.88	4.90	3.92	2.45	1.96	1.77	1.37	0.98	0.83	0.74	0.59	0.39	0.34	0.25	0.20	
		(Kg _f .cm)	60	50	40	25	20	18	14	10	8.5	7.5	6.0	4.0	3.5	2.5	2.0	
	Nd-Fe-B Magnet	(Nm)	7.85	5.88	4.90	3.92	2.94	2.55	2.06	1.47	1.18	0.98	0.78	0.59	0.49	0.34	0.29	
		(Kg _f .cm)	80	60	50	40	30	26	21	15	12	10	8	6	5	3.5	3.0	

Remarks: The torque @ 50Hz is 1.2 times of the torque @ 60Hz.

All above performances are from some typical models only. OEM and ODM are all welcome.

NOSTOP MOTOR GROUP HEAD OFFICE:

BUILDING C#, GANGZHILONG SCIENCE & TECH. INDUS. PARK, HEPING EAST RD., LONGHUA TOWN, SHENZHEN, P.R.CHINA

TEL: (+86.755) 2967 4819, 2967 4809, 2967 4212, 2967 4862, 2983 4766 FAX: (+86.755) 2967 4299

URL: <http://www.nostop.cn>, <http://www.nostopmotor.com> E-mail: stony@nostop.cn Postal Code: 518107

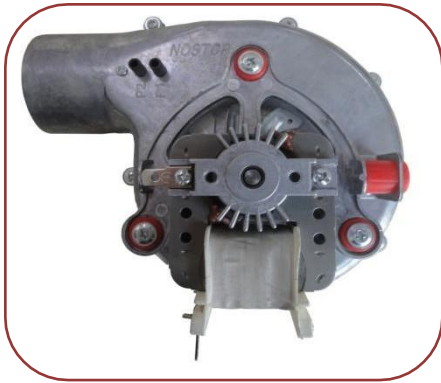

Brief Introduction:

1. It's mainly used for **gas boiler, fuel boiler, pellet stove, water boiler, home air-pipe**, etc. The input power can be adjusted during 25~65W.
2. The air-housing can be made of die-cast aluminium or galvanized steel, the fan wheel can be made of sheet aluminium or galvanized steel, and the motor can be of shaded pole type, capacitor type, or brushless one.
3. Long lifetime, low noise, stable running & withstand high temperature.
4. Class 180 (H) insulation, ambient temperature permits 250°C.

Basic Dimensions (viewed by 1st angle):

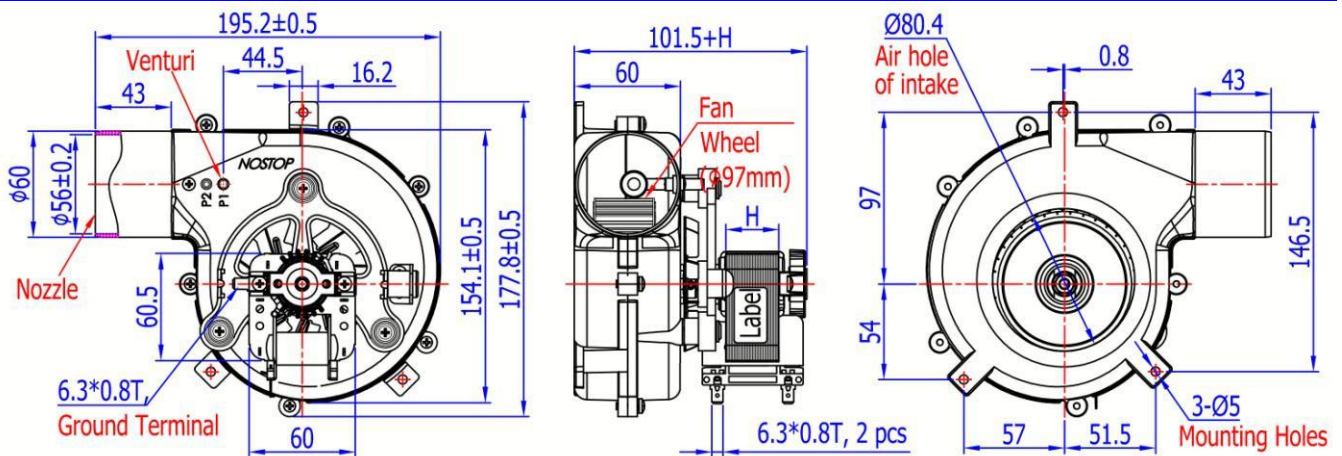

Remark: "H" in the drawing refers to the motor stack height. It would be different based on different power & different speeds needed

Notes: Based on the same fan wheel and air housing, adjusting the motor stack & design, the specs are as follow.

Technical Performances of Some Typical Models:

Models of the Blower	Motor Height	Rated Supply		Technical Performances					
		Volt.	Freq'y	Input Power	Input Current	Output Speed	Max. Air Pressure	Max. Airflow	Noise
	(H)	(VAC)	(Hz)	(W)	(A)	(rpm)	(Pa)	(m³/h)	(dB)
NCF9735-SP6025B-25W	25mm	220	50	25	0.21	1500	136	72.0	≤50
NCF9735-SP6025B-35W	25mm	220	50	35	0.33	1950	193	98.5	≤57
NCF9735-SP6030B-45W	30mm	220	50	45	0.46	2200	256	118.0	≤61

Performance Curve of NCF9735-SP6025B35 (as an example):

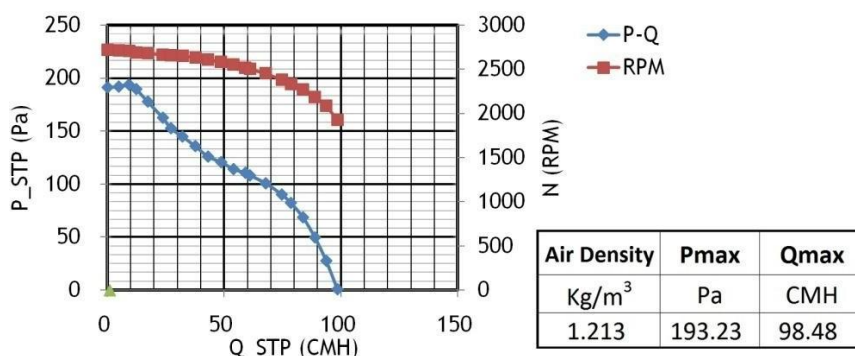

Technical Performances of Some Typical Models:

Models of the Blower	Motor Height	Rated Supply		Technical Performances					
		Volt.	Freq'y	Input Power	Input Current	Output Speed	Max. Air Pressure	Max. Airflow	Noise
	(H)	(VAC)	(Hz)	(W)	(A)	(rpm)	(Pa)	(m³/h)	(dB)
NCF8535-SP6020B-15W	20mm	220	50	15	0.14	1350	61	50	≤47
NCF8535-SP6020B-20W	20mm	220	50	20	0.19	1500	78	65	≤52
NCF8535-SP6025B-30W	25mm	220	50	30	0.32	2150	158	98	≤54

Performance Curve of NCF8535-SP6025B30 (as an example):

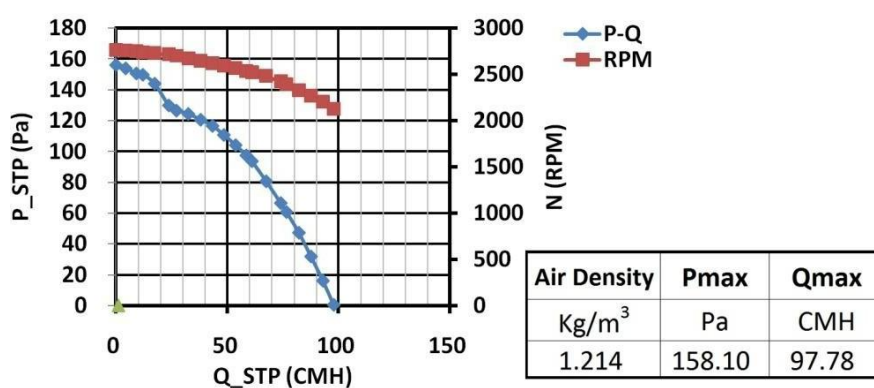

Technical Performances of Some Typical Models:

Models of the Blower	Motor Height	Rated Supply		Technical Performances					
		Volt.	Freq'y	Input Power	Input Current	Output Speed	Max. Air Pressure	Max. Airflow	Noise
	(H)	(VAC)	(Hz)	(W)	(A)	(rpm)	(Pa)	(m³/h)	(dB)
NCF10845-SP6325B-45W	25mm	220	50	45	0.42	1560	245	115	≤59
NCF10845-SP6330B-55W	30mm	220	50	55	0.57	1780	280	121	≤63
NCF10845-SP6335B-65W	35mm	220	50	65	0.68	1950	340	135	≤67

Performance Curve of NCF8535-SP6025B30 (as an example):

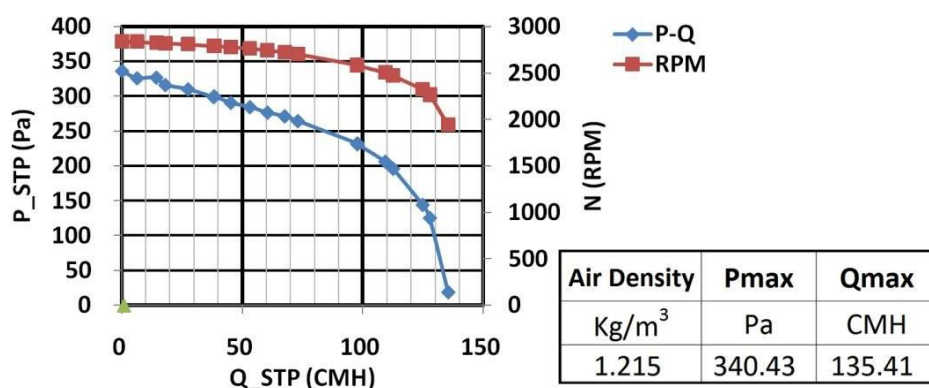

Remarks: The air speed is tested at 50cm far away from the air-outlet hole, and the noise is tested at 80m far away. The tolerances of the current, the power and the speeds are permitted by ±15%. This catalog listed just some typical models. Other requirements are possible. OEM & ODM are both welcome.





Gear Reduction Ratio	Series 1	12	30	75	187.5	468.75	1171.875
	Series 2	9.6	24	60	150	375	937.5
	Series 3			40	120	300	750
Gearbox Length (L)		11.2		12.6	14	16.3	17.7
(Other reduction ratios are welcome)							

Brief Introduction

This is a series of motors based on the flat, open-frame gearbox of OD 12x10mm. Gearbox length can be increased or decreased according to different gear reduction ratio. Motor can be any type but most popular motors are those that the diameter is approx. 12mm. Gearbox spindle outputs from the centre of the gearbox.

Main Application

Electronic door lock, monitor, optic equipment, printer, medical equipments, etc.

Outline Drawing

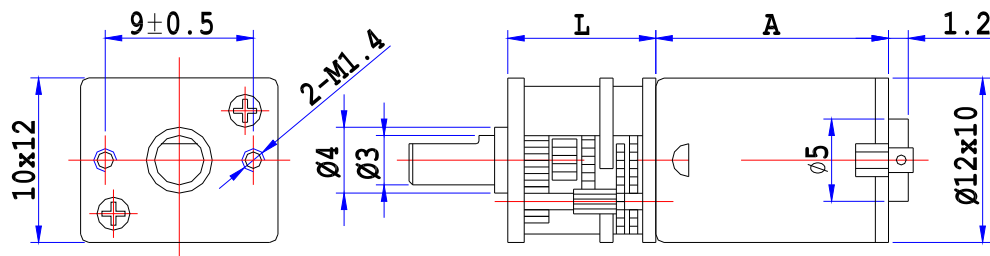

Specifications

Serial No.	Model	Rated Voltage	No Load		At Maximum Efficiency				At Stall	
			Speed	Current	Speed	Torque	Current	Output	Torque	Current
		V	rpm	mA	rpm	gcm	mA	mW	Kgcm	mA
12GF030	08260-287	4.5	40	30	32	500	150	160	2.1	600
	09175-287	2.4	27	35	18	600	150	110	1.5	350
		4.5	52	45	30	1500	350	460	3	700
	13115-287	2.4	55	30	40	700	350	280	3	500
		6	70	70	52	1200	250	640	4	700

Remarks: The above specifications are just for some typical models. Other specifications are welcome.