

Air-ends and Screw Compressor Components

AIR-ENDS - INTAKE REGULATORS - MULTI-BLOCKS - SINGLE-BLOCKS



MADE IN ITALY

FSN
ORIGINAL SPARE PARTS

www.famcocorp.com

E-mail: info@famcocorp.com

@famco_group

Tel: ۰۲۱-۴۸۰۰۰۰۴۹

Fax: ۰۲۱-۴۴۹۹۴۶۴۲

تهران، کیلومتر ۲۱ بزرگراه لشگری (جاده مخصوص کرج)

روبروی پالایشگاه نفت پارس، پلاک ۱۲



We have been manufacturing screw air-ends and all main components for the industrial compressors industry for more than 20 years, gradually becoming a leading manufacturer in the global market.

In the last few years, we have invested significant amount of energy and effort in innovation and technological product development, with the aim to ensure the highest quality standards, maximum reliability and flexibility in terms of use.

The various screw air-ends models and a full series of components such as intake and multi-block regulators

(a system including minimum pressure valve, oil filter nipple and separator filter nipple) have allowed to distinguish

our company as a world leader in this field and to become a benchmark brand in the industrial compressed air industry.



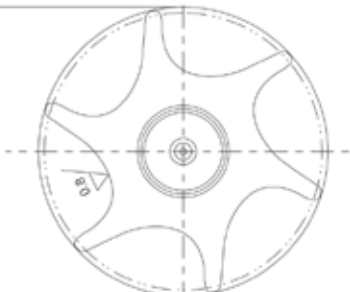

The constant pursuit of first-class quality, an innovative spirit and a special focus on our customers' needs have always been our core values.



The entire manufacturing process is carried out in our Italian plant, in accordance with Quality Management System certified in compliance with ISO 9001 certified since 1996.

Assembly operations and testing conducted on automated lines, state of the art robotic systems, IT tools for design and control, cutting-edge machine tools and sophisticated control instrumentation guarantee the highest level of quality at every stage of production, from design to assembly.

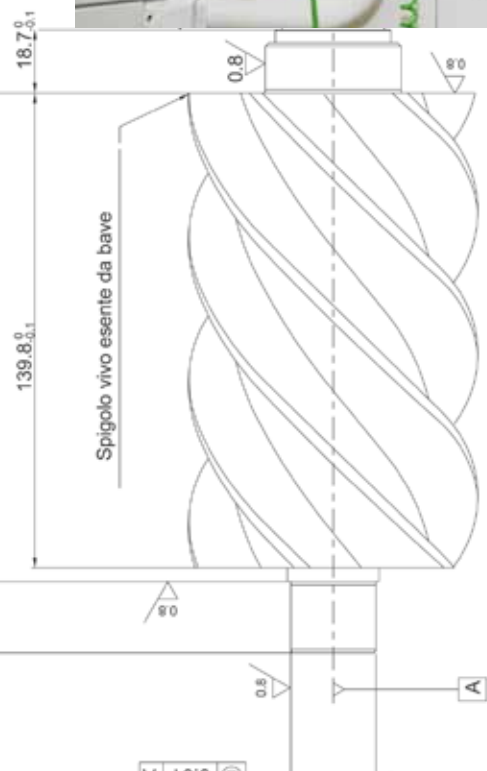

Our screw units stand out for their particular rotors profile and optimized performance. The unique design of the screw units ensures their operation regardless of whether the rotor is male or female. This particular feature makes it possible to satisfy the needs of any project both in terms of performance and traction with electric or internal combustion engines, in order to maximize performance and reduce energy consumption.

A solid modeling CAD system optimizes the arrangement of components and evaluates its resistance. The cutting of each single rotor is carried out in four precise machining phases allowing to achieve high execution precision and repeatability. This level of constructive accuracy ensures the undifferentiated coupling of each male rotor with any female rotor.

All parts are 100% tested before being placed on the market. The screw units, in particular, are individually tested after assembly and then again when installed on the complete machine. The performance of each element is



www.famcocorp.com

E-mail: info@famcocorp.com

@famco_group

Tel: 021-48000049

Fax: 021-44996642

تهران، کیلومتر ۲۱ بزرگراه لشگری (جاده مخصوص کرج)

روبروی پالایشگاه نفت پارس، پلاک ۱۲

Air-end for direct coupling or belt-driven.

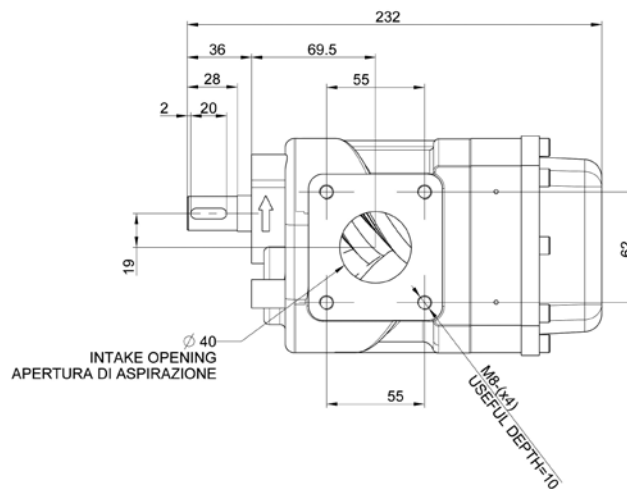
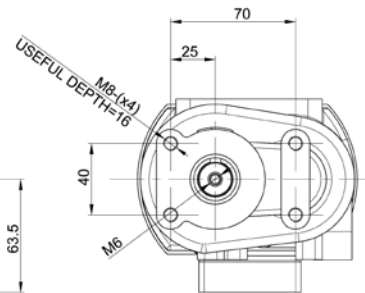
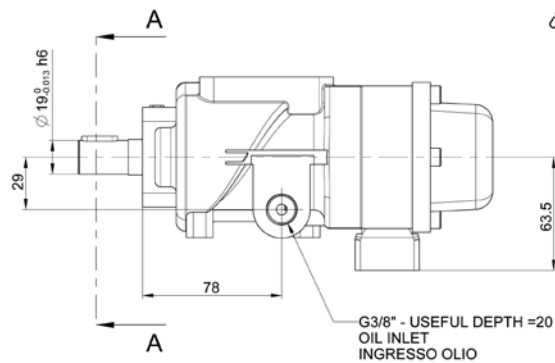
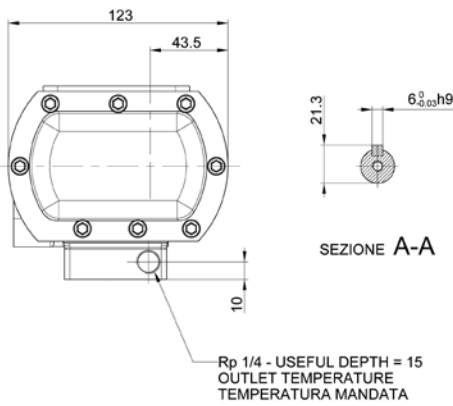
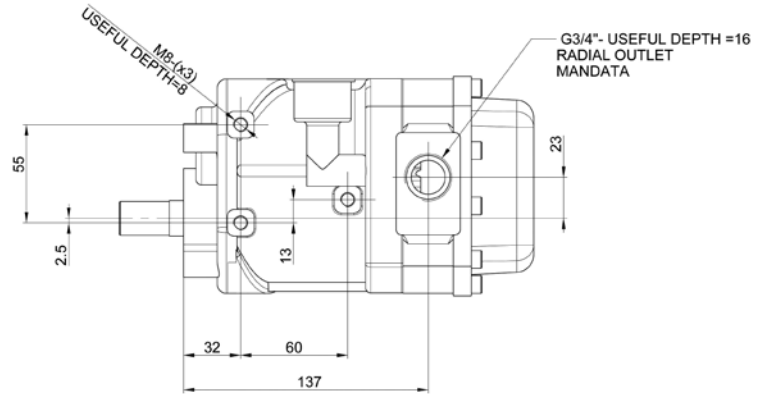

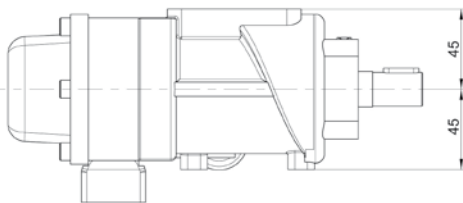
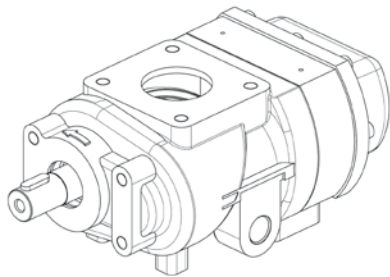

Code (1 pc)	#5305100110
Code (24 pcs)	#5305100120
Power range	2.2 - 5.5 kW
Rotor speed	2,600 - 6,800 r.p.m. (min. - max.)
Max. pressure	15 bar
Net Weight	7.2 kg

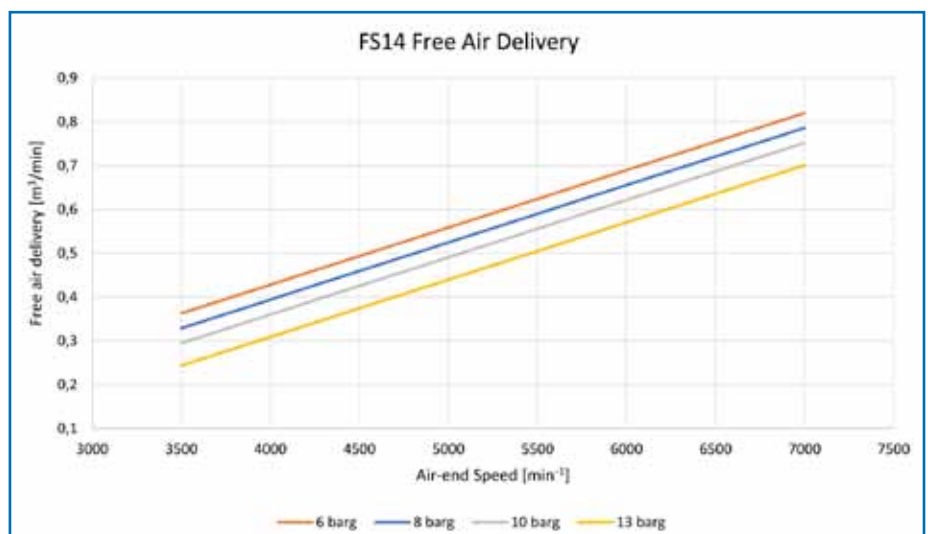
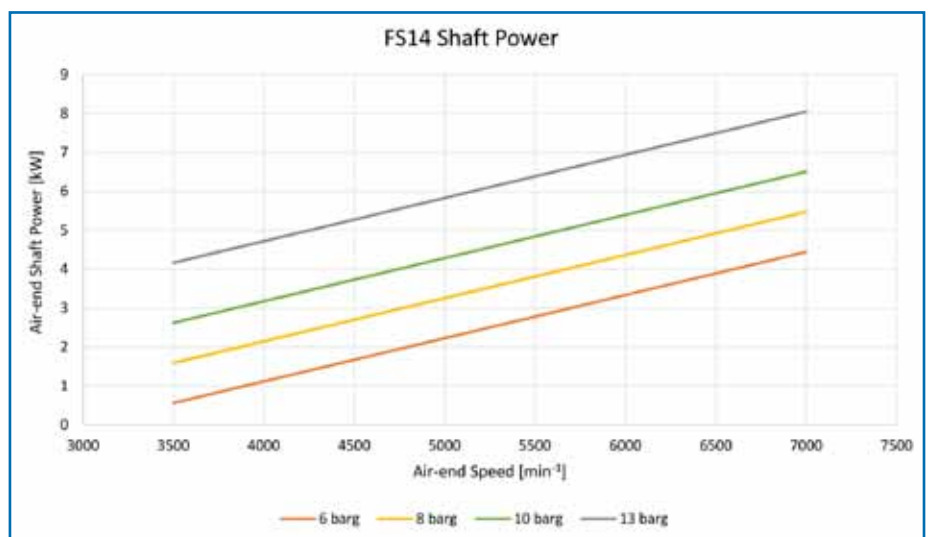

Air-end for direct coupling or belt-driven.

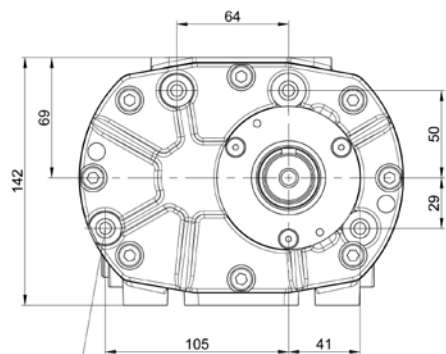
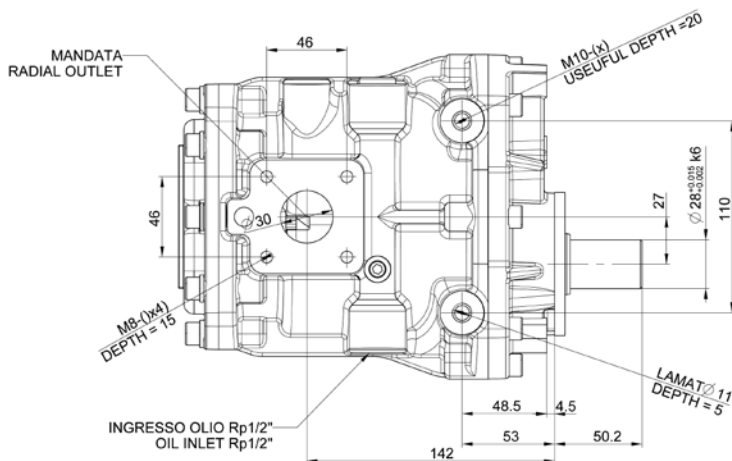

M8-(xx4)
USEFUL DEPTH = 15

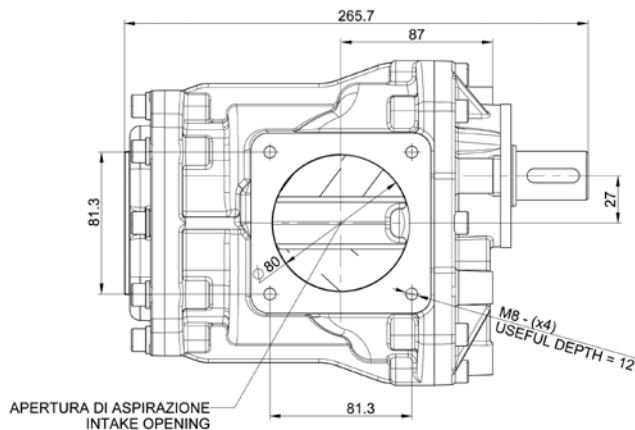
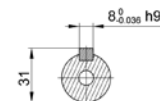
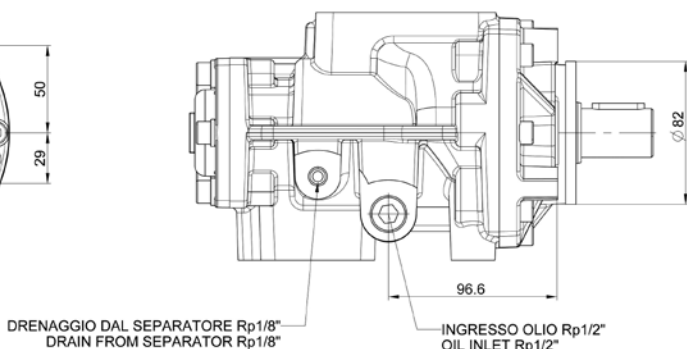

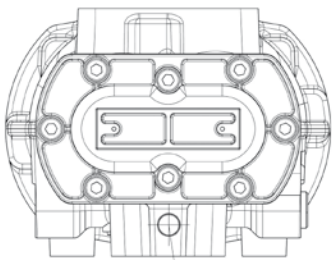
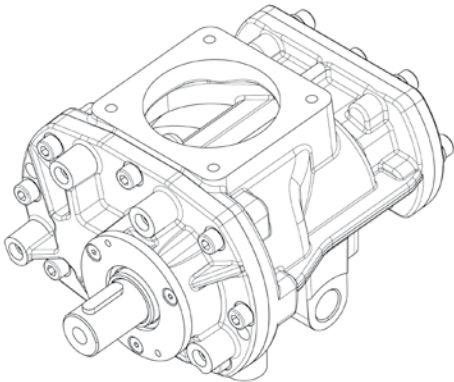

TEMPERATURA MANDATA Rp1/4"
OUTLET TEMPERATURE Rp1/4"

Code (1 pc)	#5303000110
Code (24 pcs)	#5303000120
Power range	5.5 - 15 kW
Rotor speed	1400 - 5300 r.p.m. (min. - max.)
Max. pressure	15 bar
Net Weight	15 kg

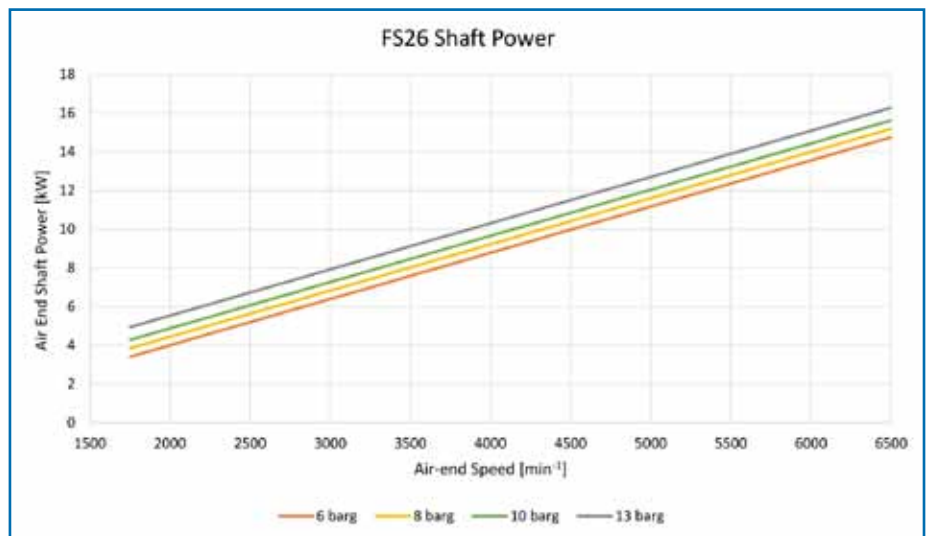

Air-end for direct coupling or belt-driven.

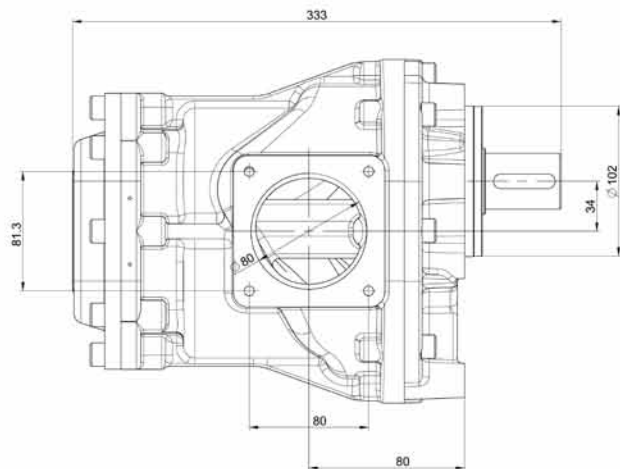
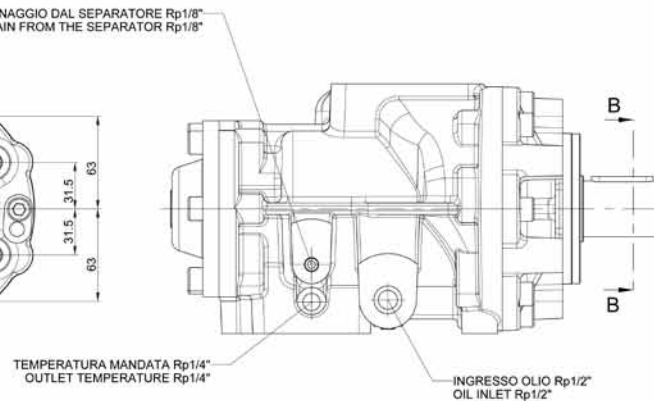
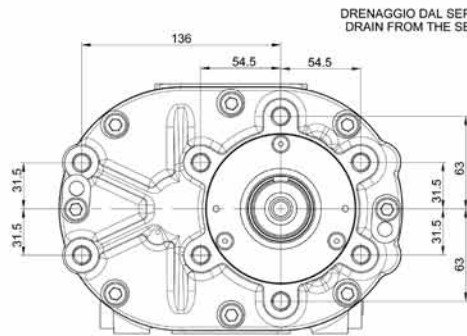
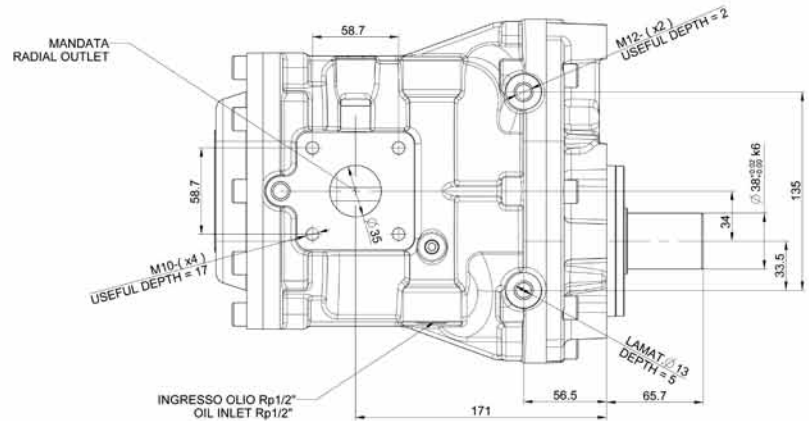

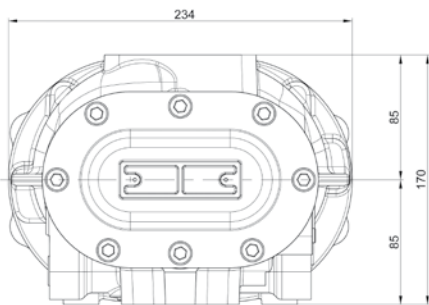
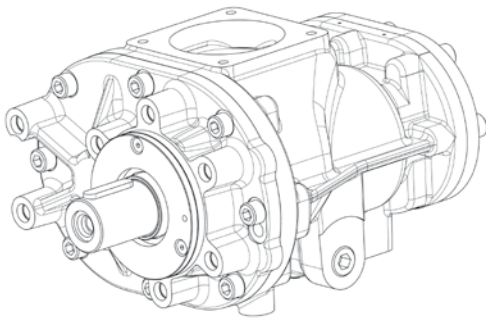

Code (1 pc)	#5304000110
Code (10 pcs)	#5304000120
Power range	11 - 30 kW
Rotor speed	2,100 - 5,300 r.p.m. (min. - max.)
Max. pressure	15 bar
Net Weight	36 kg

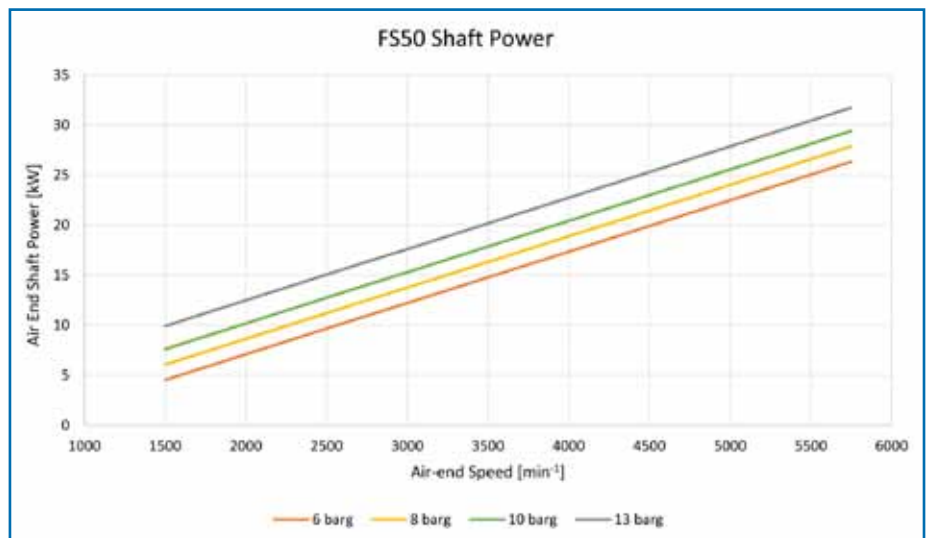

Air-end for direct coupling or belt-driven.

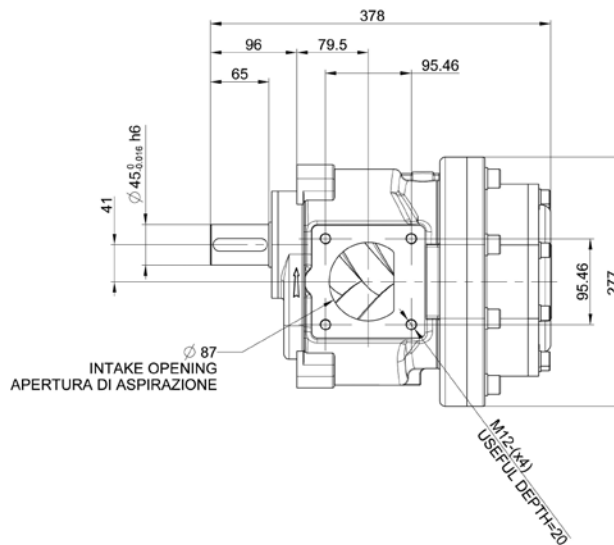
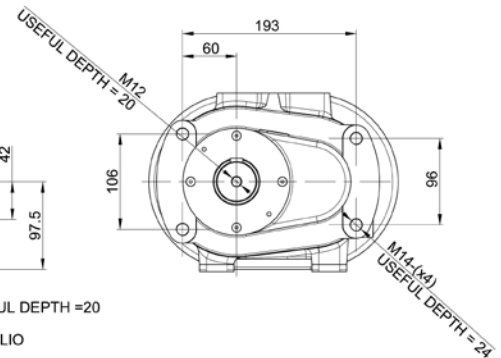
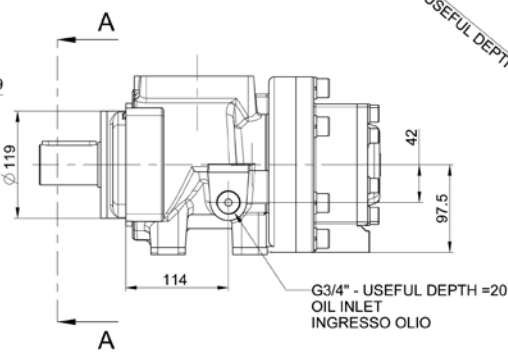
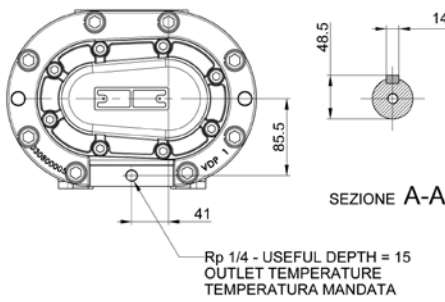
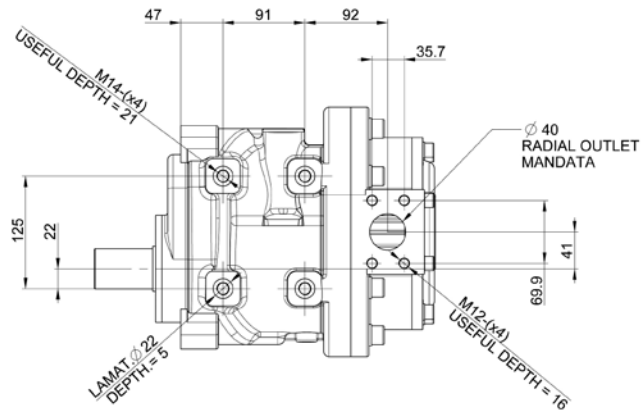

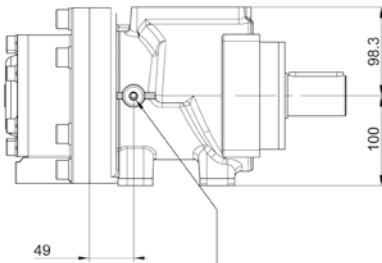
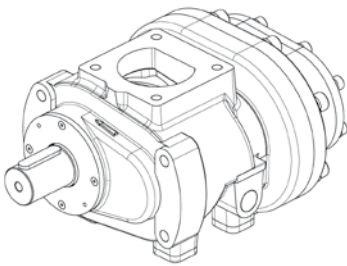

G1/8" - USEFUL DEPTH = 10
DRAIN FROM THE SEPARATOR
DRENAGGIO DAL SEPARATORE

Code	#5308000110
Power range	22 - 37 kW
Rotor speed	2,500 - 6,500 r.p.m. (min. - max.)
Max. pressure	15 bar
Net Weight	57 kg

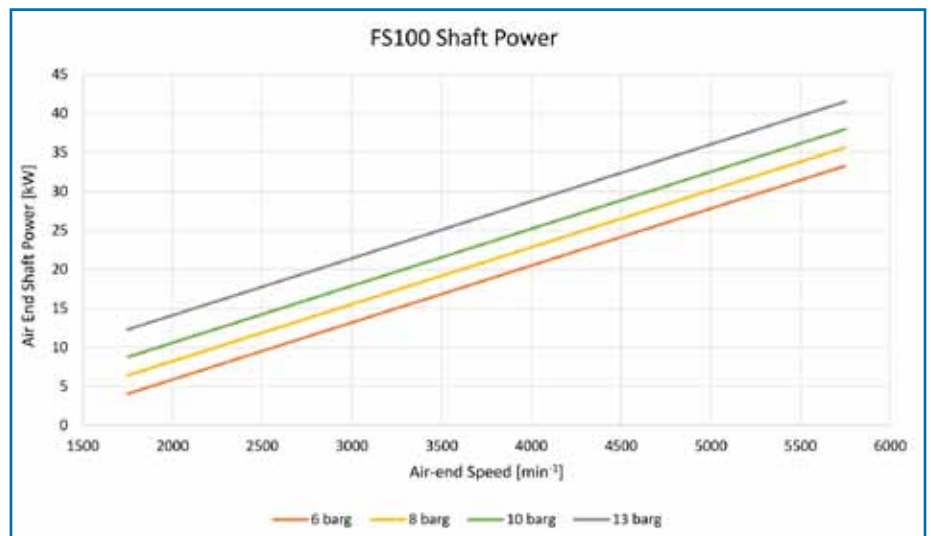

IR 8 + OR3212 (FS 14)

Intake regulator for FS 14 air-end, complete with OR.



Code	#451J00042
Power range	2.2 - 4 kW
Operating temperature	-10 to 120 °C
Max. pressure	15 bar
Net Weight	0.3 kg

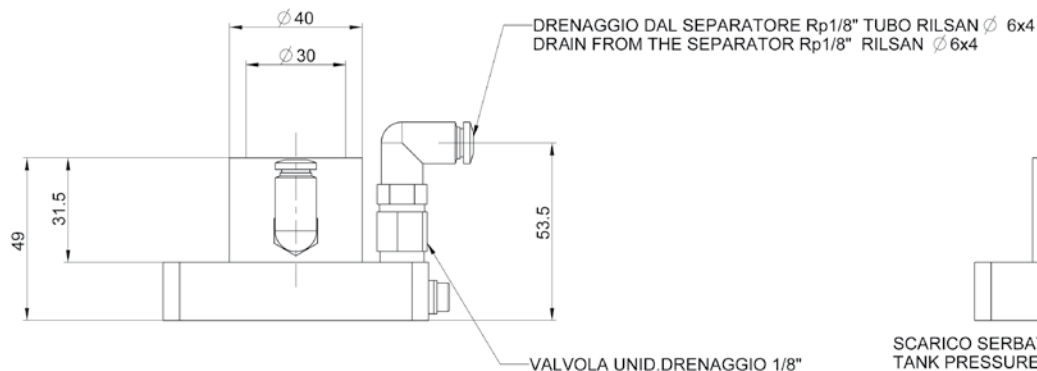
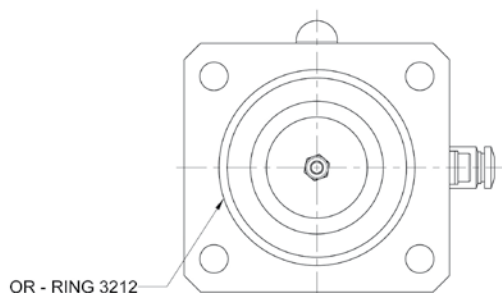

SCARICO SERBATOIO TUBO RILSAN \varnothing 6x4
TANK PRESSURE RELEASE RILSAN \varnothing 6x4

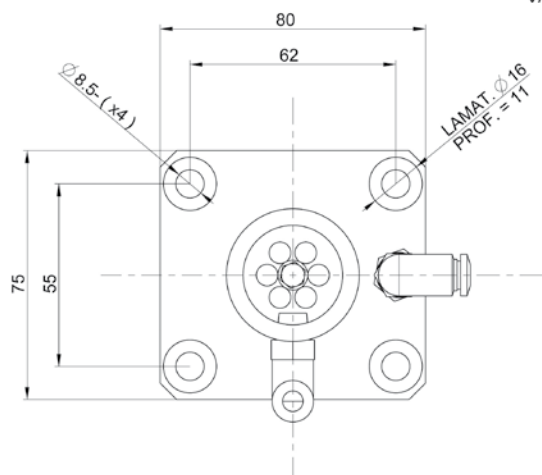

IR 10 + E.V. 5,5-24VAC (FS 14)

Intake regulator for FS 14 air-end, complete with solenoid valve.



Code	#419250005
Power range	2.2 - 7.5 kW
Operating temperature	-10 to 120 °C
Max. pressure	15 bar
Solenoid valve	24V AC 50-60 Hz
Net Weight	0.3 kg

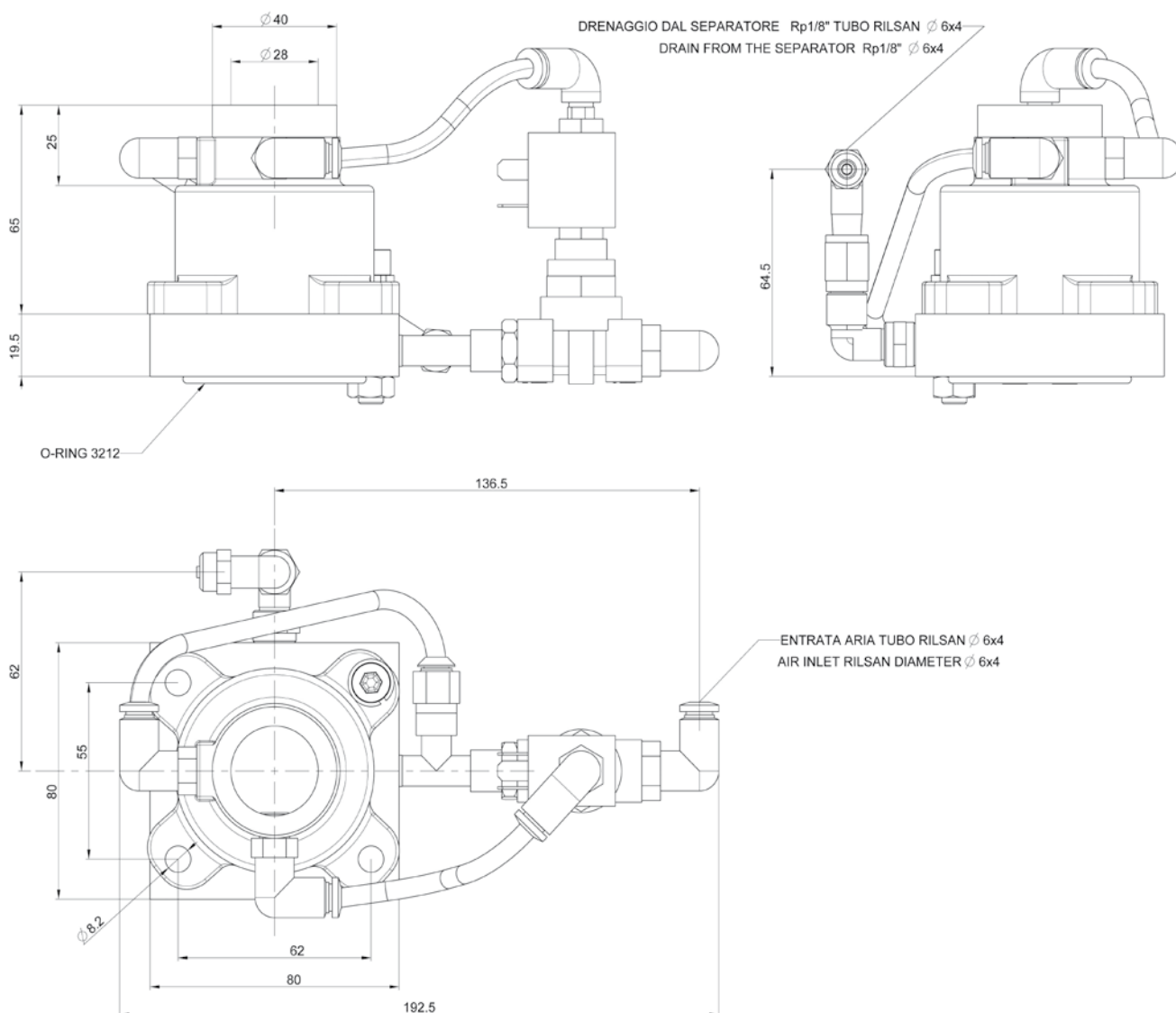

IR 10DC + RACC.+EV24 VAC (FS 26)

Intake regulator for FS 26 air-end, complete with joints and solenoid valve.



Code	#419261020
Power range	4 - 7.5 kW
Operating temperature	-10 to 120 °C
Max. pressure	15 bar
Solenoid valve	24V AC 50-60 Hz
Net Weight	0.6 kg

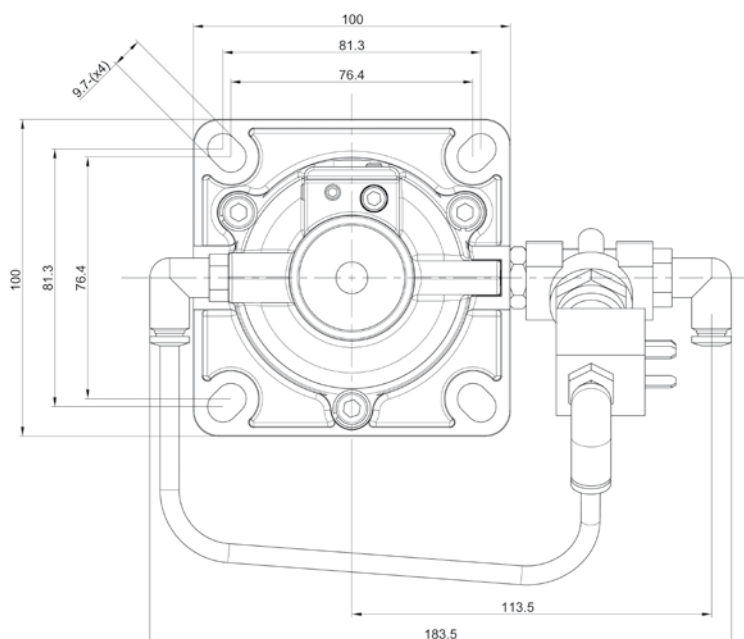
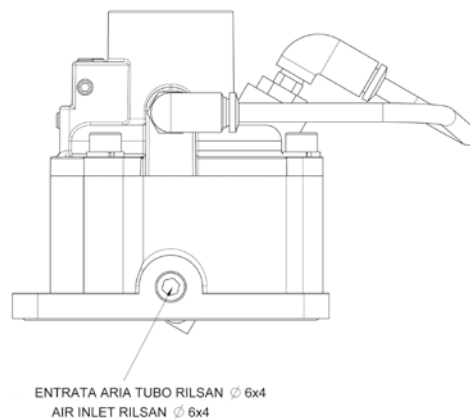
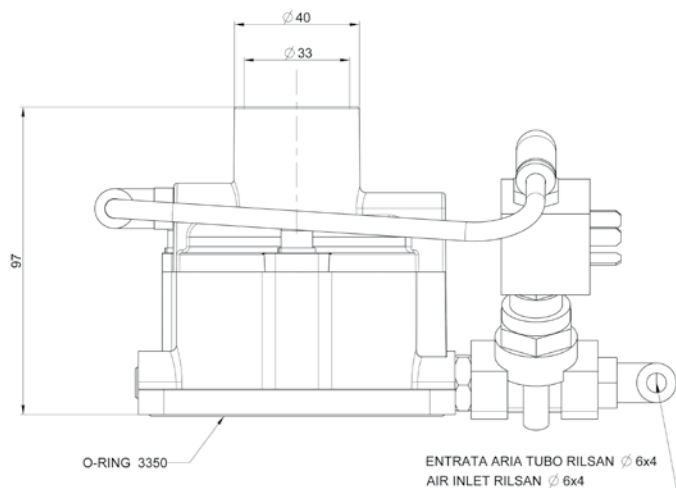

IR 30DC + RACC.+EV24 VAC (FS 50)

Intake regulator for FS 50 air-end, complete with joints and solenoid valve.



Code	#419260020
Power range	11 - 22 kW
Operating temperature	-10 to 120 °C
Max. pressure	15 bar
Solenoid valve	24V AC 50-60 Hz
Net Weight	0.6 kg

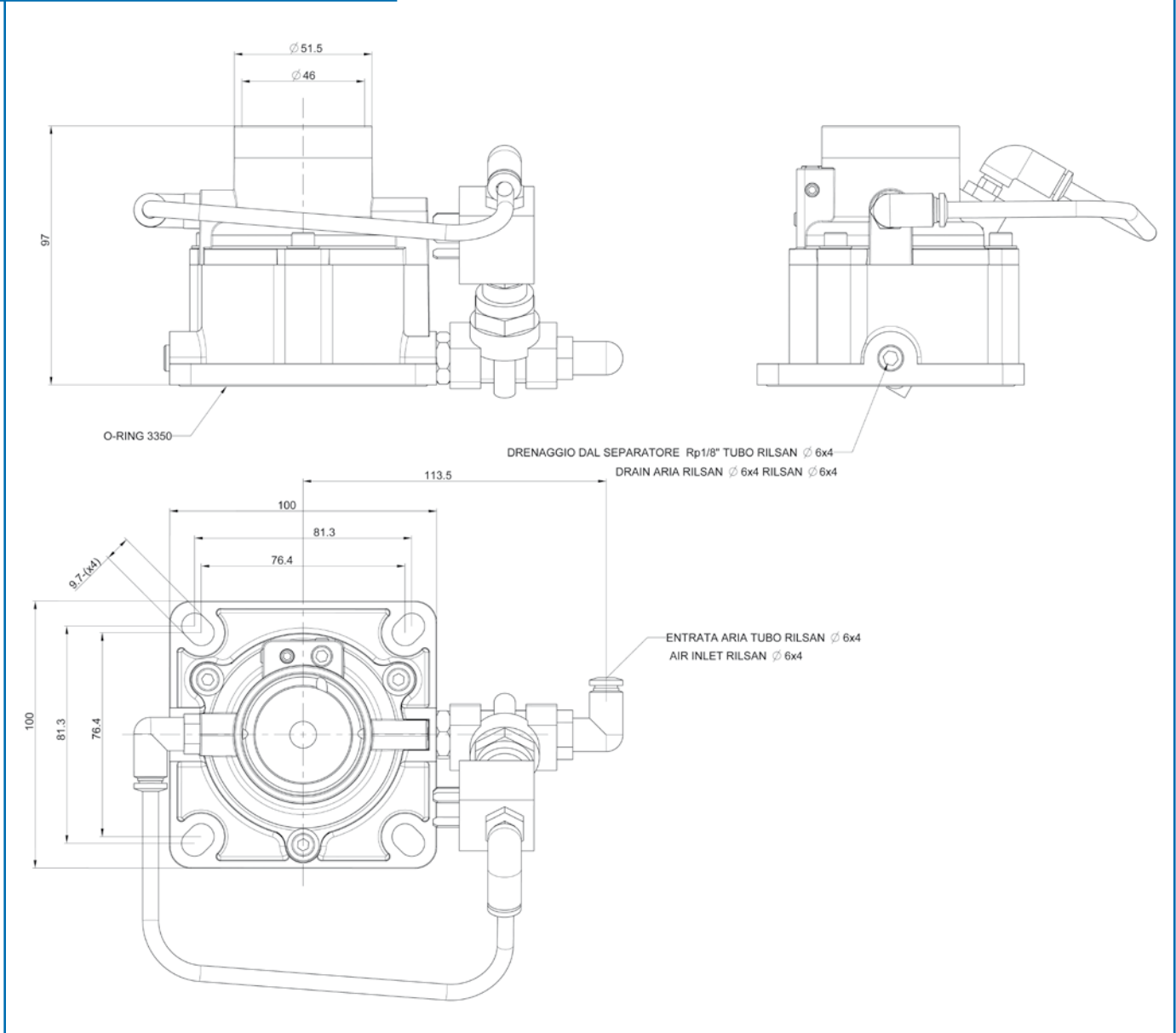

IR 60 + E.V. 24VAC (FS 100)

Intake regulator for FS 100 air-end, complete with solenoid valve.



Code	#319253000
Power range	22 - 45 kW
Operating temperature	-10 to 120 °C
Max. pressure	15 bar
Solenoid valve	24V AC 50-60 Hz
Net Weight	3.1 kg

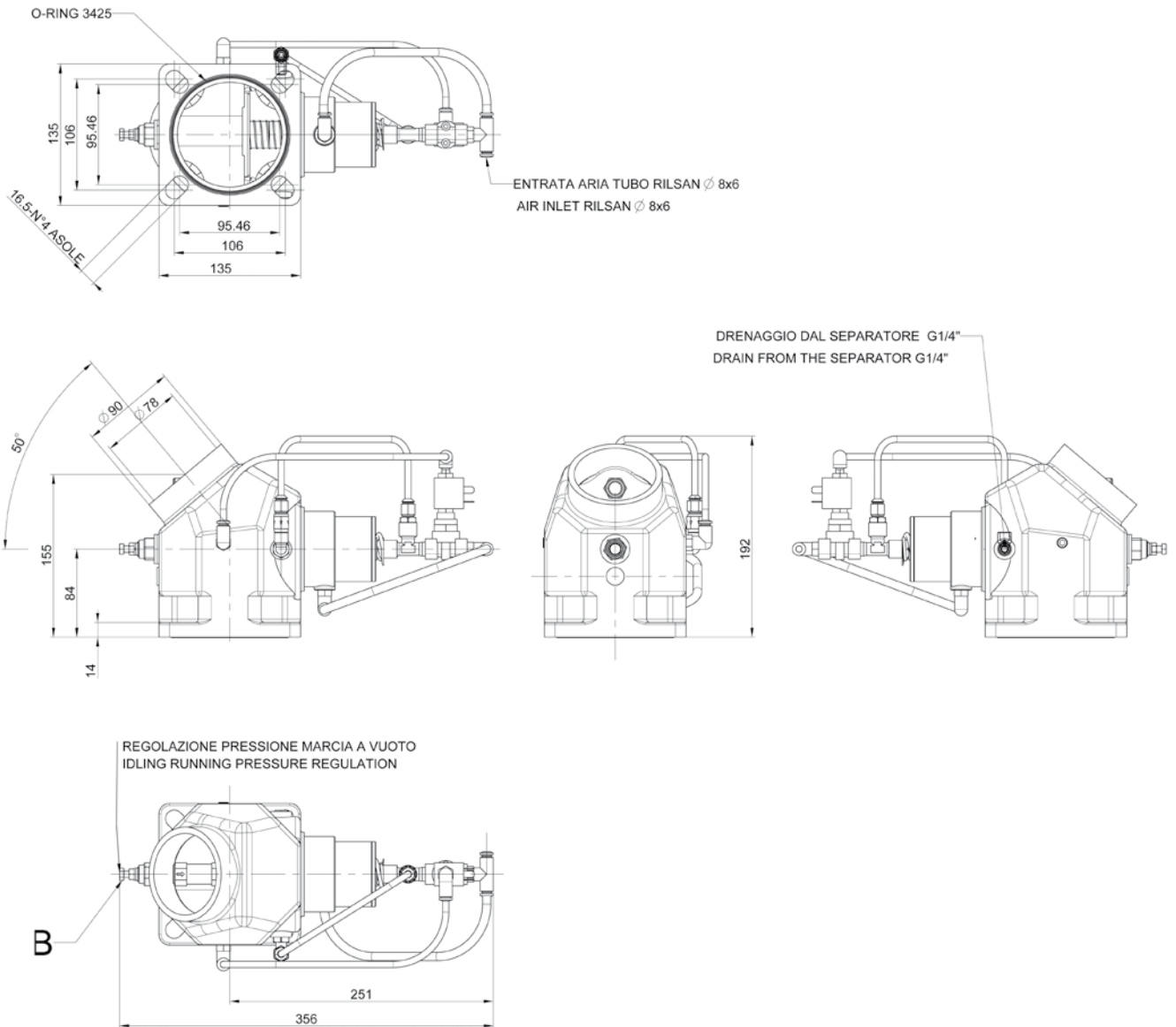

Intake regulator complete with solenoid valve.



Code	#319266010
Power range	22 - 55 kW
Operating temperature	-10 to 120 °C
Max. pressure	15 bar
Solenoid valve	24V AC 50-60 Hz
Net Weight	3.2 kg

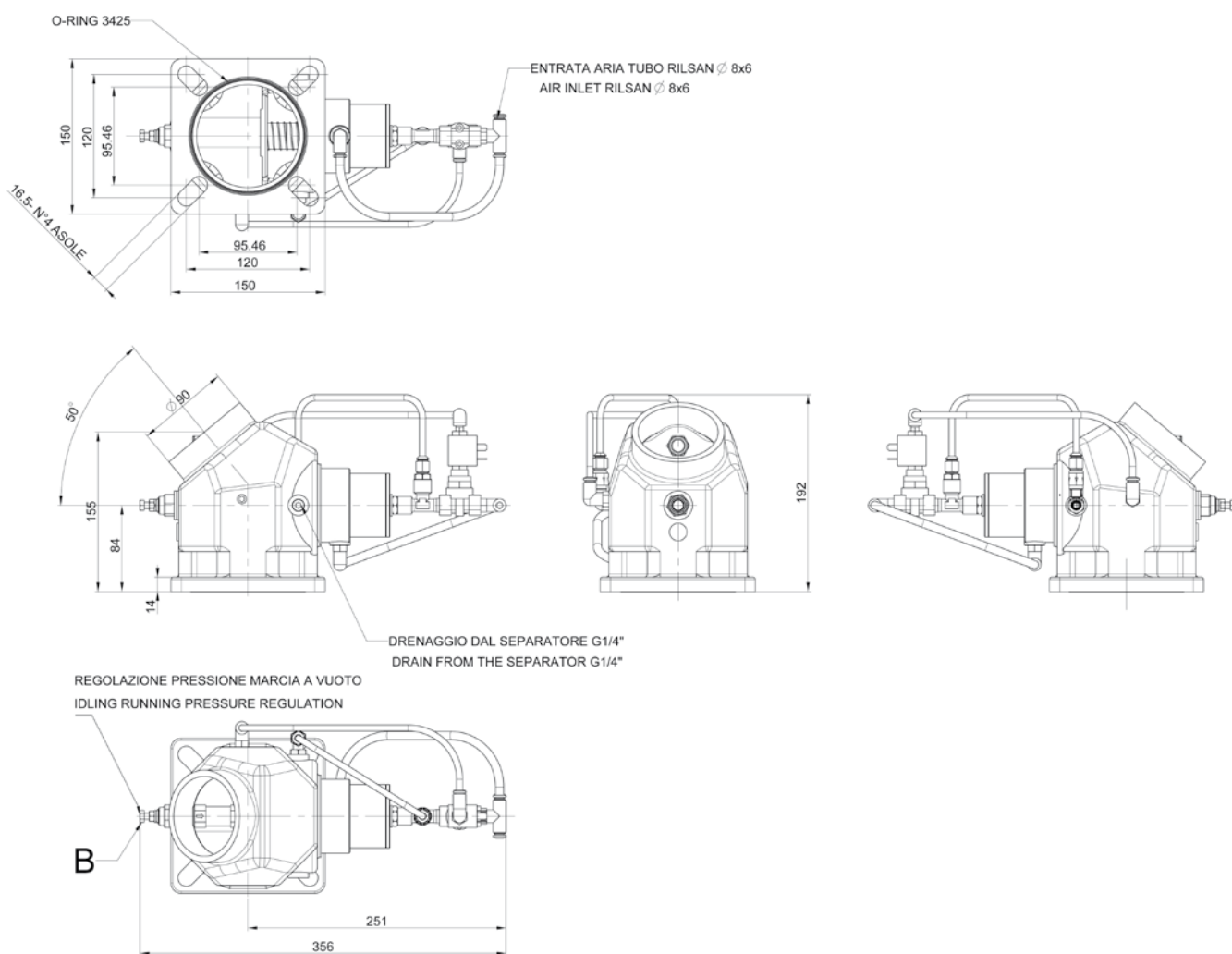

IR 100 + E.V. 24VAC

Intake regulator complete with solenoid valve.



Code	#319265000
Power range	37 - 75 kW
Operating temperature	-10 to 120 °C
Max. pressure	15 bar
Solenoid valve	24V AC 50-60 Hz
Net Weight	5.1 kg

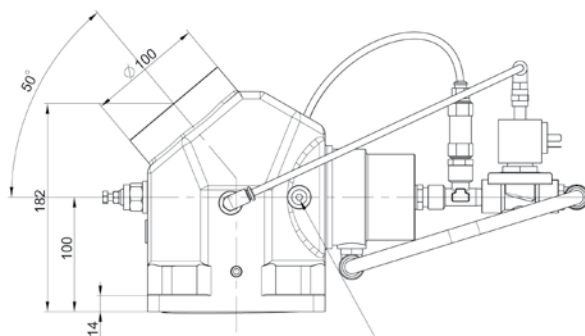
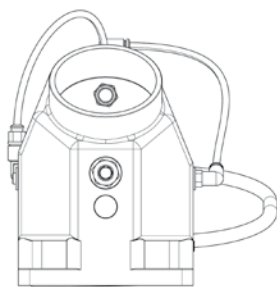
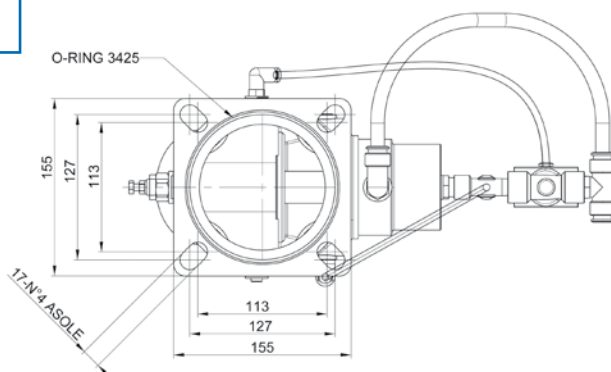

DRENAGGIO DAL SEPARATORE G1/4"
DRAIN FROM THE SEPARATOR G1/4"

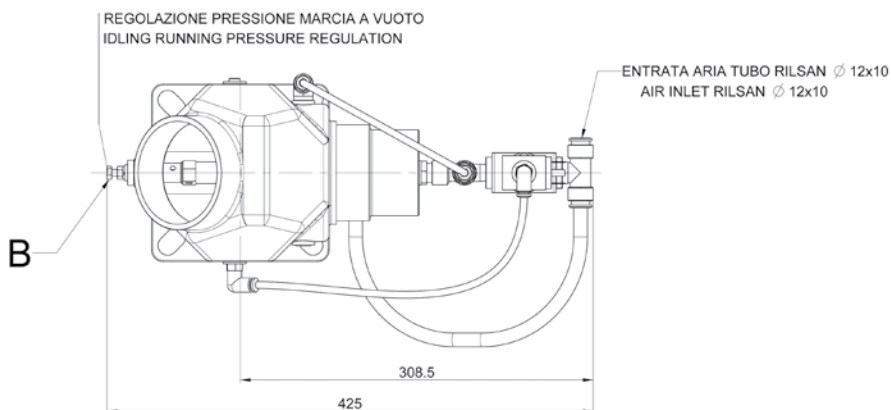

Multi-block including oil filter, oil separator filter and minimum pressure valve.



Code	#451J00045
Power range	2.2 - 5.5 kW
Max. pressure	15 bar
Oil nipple size	3/4" - 16 UNF
Air nipple size	M22 x 1.5 mm

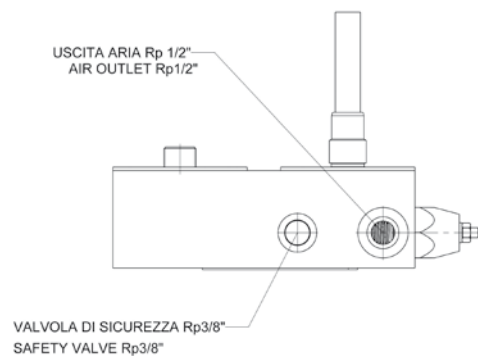
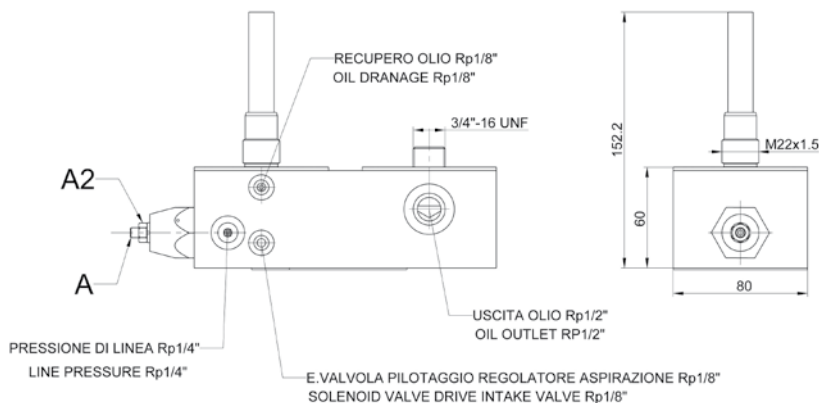
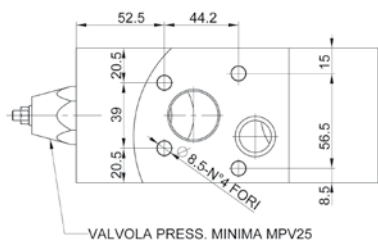

MB 20

Multi-block including oil filter, oil separator filter and minimum pressure valve.



Code	#451J00046
Power range	7.5 - 15 kW
Max. pressure	15 bar
Oil nipple size	3/4" - 16 UNF
Air nipple size	M24 x 1.5 mm

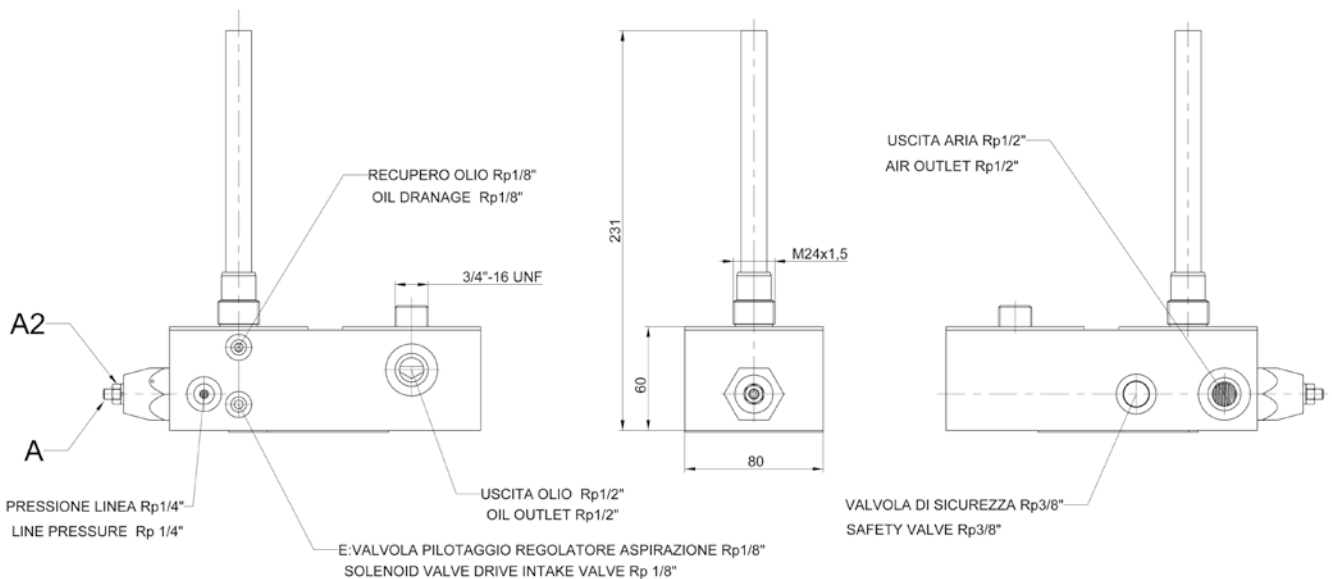
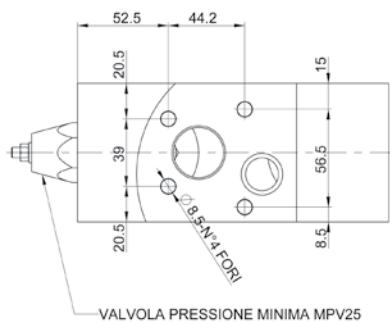

Oil separator block with minimum pressure valve.



Code	#451P00012
Power range	2.2 - 7.5 kW
Max. pressure	15 bar
Air nipple size	M22 x 1.5 mm

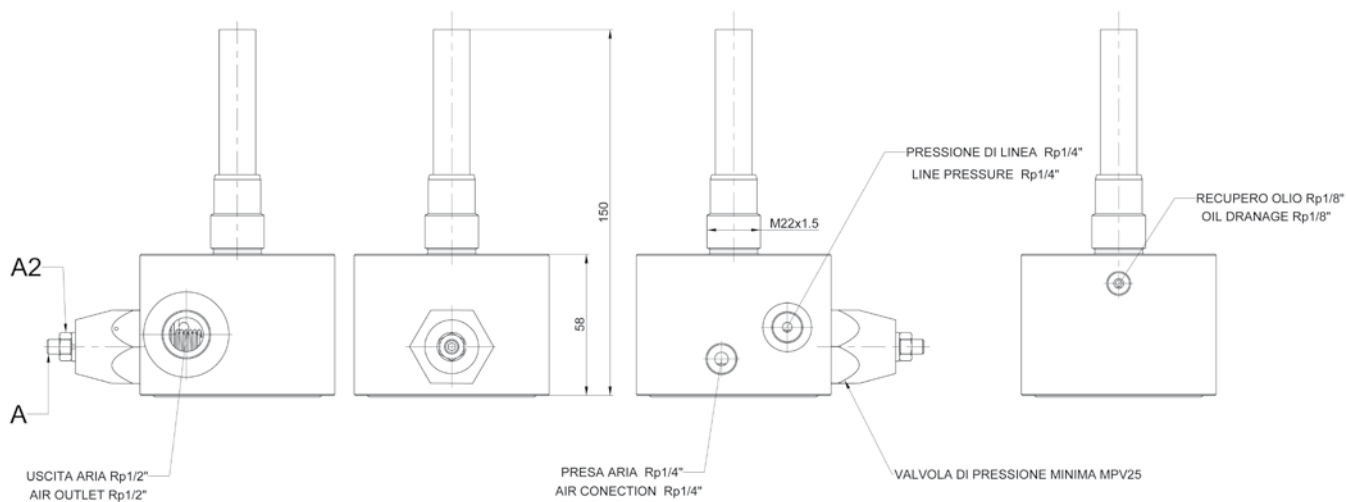
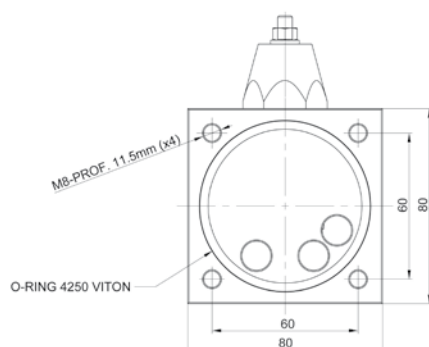

SB 20 3/4"

Oil separator block with minimum pressure valve.



Code	#460FG0052
Power range	7.5 - 15 kW
Max. pressure	15 bar
Air nipple size	M24 x 1.5 mm

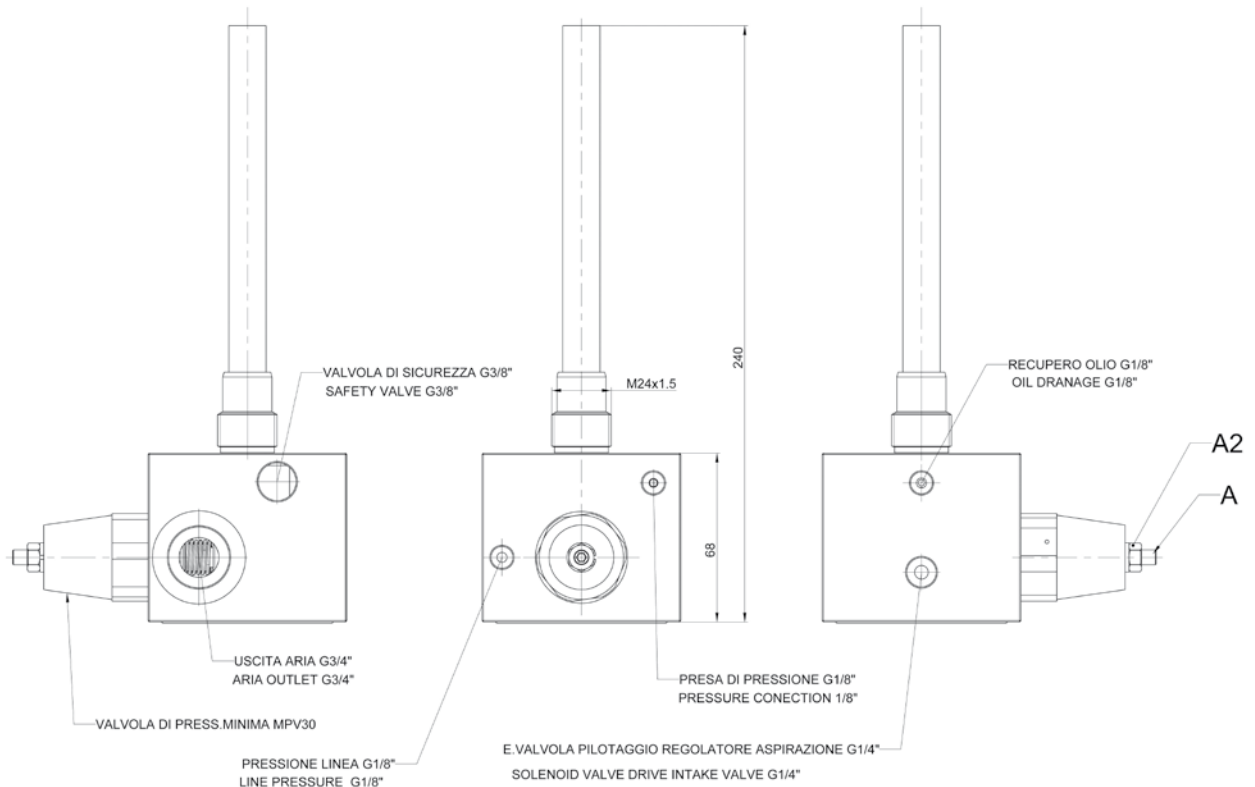
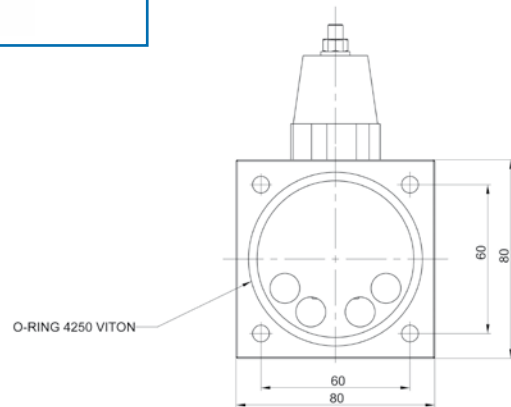

SB 50 1-1/4"

Oil separator block with minimum pressure valve.



Code	#460152000
Power range	18.5 - 37 kW
Max. pressure	15 bar
Air nipple size	M39 x 1.5 mm

