

**TECHNICAL DATA SHEET PHOENIX P18**



PP



PVDF+CF



POMc



AISI 316

**TECHNICAL DATA P18**

- FLUID CONNECTIONS : 3/8" BSP
- AIR CONNNECTION : 6 mm
- MAX FLOW RATE : 20 lt/min
- MAX AIR PRESSURE: 8 bar
- MAX DELIVERY HEAD: 80 m
- MAX SUCTION LIFT DRY: 6 m
- MAX SUCTION LIFT WET: 9,8 m
- MAX SOLID PASSING: 3 mm
- NOISE LEVEL: 65 dB
- DISPLACEMENT FOR CYCLE: 30 cc
- MAX VISCOSITY : 12.000 cps
- ATEX zone 2 : EX II 3/3 GD c IIB T135°C

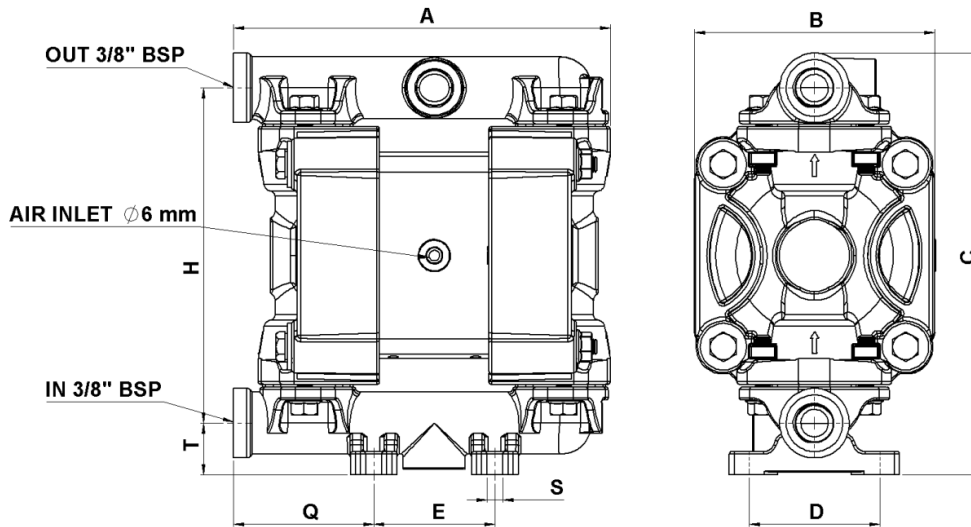
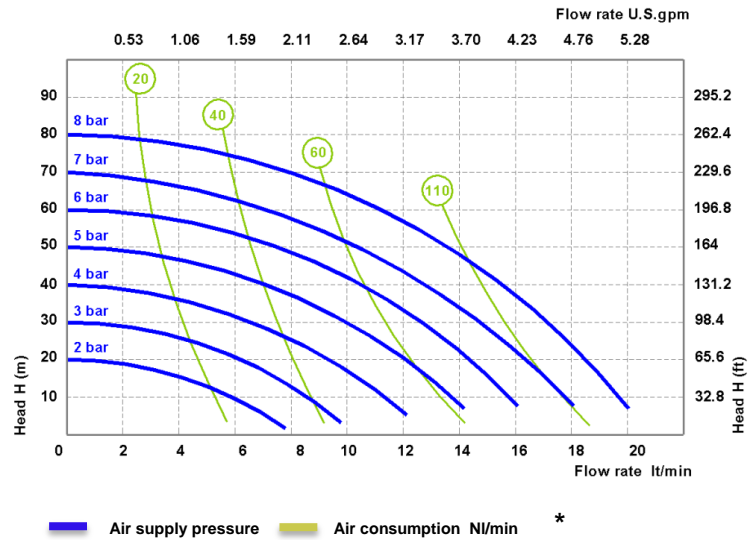

PHOENIX P18	A	B	C	D	E	H	Q	S	T	Weight Kg	Max Temperature
PP	146	93	164	50	47	130	55	6	20	1,1	65 °C
PVDF+CF	146	93	164	50	47	130	55	6	20	1,4	95 °C
POMc	146	93	164	50	47	130	55	6	20	1,1	95 °C
AISI 316	148	85	153	47	51	122	55	6	18	2,1	95 °C

\* The curves and performance values refer to pumps with submerged suction and a free delivery outlet with water at 20°C, and vary according to the construction material.

Technical data are approximate and not binding for the manufacturer who reserves the right to change them without notice at any time.

**COMPOSITION**

MODEL	CASING	DIAPHRAGM	BALL	SEATS	GASKET	CONNECTIONS	ATEX	PORTS IN/OUT
<b>P0018</b>	P= PP KC= PVDF+CF O= POMc S=SS	NT=NBR+PTFE	T= PTFE S= SS	P=PP K=PVDF O=POMc S=SS	D=EPDM V=VITON N=NBR T=PTFE	1=BSP 5=NPT	- = zone 2	AB=Standard

**AVAILABLE CONNECTIONS**

**Standard** = A B  
**IN** = A-E-T-C-G  
**OUT** =B-S-D-F-P

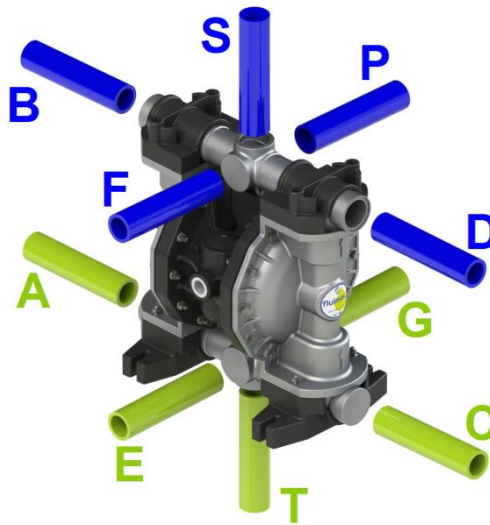

**HOW TO READ THE CODE**

