

SIEMENS

Data sheet

3RH2131-1BB40



Contactor relay, 3 NO + 1 NC, 24 V DC, Size S00, screw terminal

product brand name	SIRIUS
product designation	Auxiliary contactor
product type designation	3RH2
General technical data	
size of contactor	S00
product extension auxiliary switch	Yes
power loss [W] for rated value of the current without load current share typical	4 W
insulation voltage with degree of pollution 3 at AC rated value	690 V
degree of pollution	3
surge voltage resistance rated value	6 kV
shock resistance at rectangular impulse <ul style="list-style-type: none">• at DC	10g / 5 ms, 5g / 10 ms
shock resistance with sine pulse <ul style="list-style-type: none">• at DC	15g / 5 ms, 8g / 10 ms
mechanical service life (operating cycles) <ul style="list-style-type: none">• of contactor typical• of the contactor with added electronically optimized auxiliary switch block typical• of the contactor with added auxiliary switch block typical	30 000 000 5 000 000 10 000 000
reference code according to IEC 81346-2	K
Substance Prohibitance (Date)	10/01/2009
Weight	0.27 kg
Ambient conditions	
installation altitude at height above sea level maximum	2 000 m
ambient temperature <ul style="list-style-type: none">• during operation• during storage	-25 ... +60 °C -55 ... +80 °C
relative humidity minimum	10 %
relative humidity at 55 °C according to IEC 60068-2-30 maximum	95 %
Environmental footprint	
Environmental Product Declaration (EPD)	Yes
Global Warming Potential [CO2 eq] total	133 kg
Global Warming Potential [CO2 eq] during manufacturing	1.3 kg
Global Warming Potential [CO2 eq] during operation	132 kg
Global Warming Potential [CO2 eq] after end of life	-0.227 kg
Main circuit	
no-load switching frequency <ul style="list-style-type: none">• at AC• at DC	10 000 1/h 10 000 1/h

Control circuit/ Control	
type of voltage of the control supply voltage	DC
control supply voltage at DC rated value	24 V
operating range factor control supply voltage rated value of magnet coil at DC <ul style="list-style-type: none"> initial value full-scale value 	<div>0.8</div> <div>1.1</div>
closing power of magnet coil at DC	4 W
holding power of magnet coil at DC	4 W
closing delay <ul style="list-style-type: none"> at DC 	30 ... 100 ms
opening delay <ul style="list-style-type: none"> at DC 	7 ... 13 ms
arcing time	10 ... 15 ms
Auxiliary circuit	
number of NC contacts for auxiliary contacts <ul style="list-style-type: none"> instantaneous contact 	<div>1</div> <div>1</div>
number of NO contacts for auxiliary contacts <ul style="list-style-type: none"> instantaneous contact 	<div>3</div> <div>3</div>
identification number and letter for switching elements	31 E
operational current at AC-12 maximum	10 A
operational current at AC-15 <ul style="list-style-type: none"> at 230 V rated value at 400 V rated value at 500 V rated value at 690 V rated value 	<div>10 A</div> <div>3 A</div> <div>2 A</div> <div>1 A</div>
operational current at 1 current path at DC-12 <ul style="list-style-type: none"> at 24 V rated value at 110 V rated value at 220 V rated value at 440 V rated value at 600 V rated value 	<div>10 A</div> <div>3 A</div> <div>1 A</div> <div>0.3 A</div> <div>0.15 A</div>
operational current with 2 current paths in series at DC-12 <ul style="list-style-type: none"> at 24 V rated value at 60 V rated value at 110 V rated value at 220 V rated value at 440 V rated value at 600 V rated value 	<div>10 A</div> <div>10 A</div> <div>4 A</div> <div>2 A</div> <div>1.3 A</div> <div>0.65 A</div>
operational current with 3 current paths in series at DC-12 <ul style="list-style-type: none"> at 24 V rated value at 60 V rated value at 110 V rated value at 220 V rated value at 440 V rated value at 600 V rated value 	<div>10 A</div> <div>10 A</div> <div>10 A</div> <div>3.6 A</div> <div>2.5 A</div> <div>1.8 A</div>
operating frequency at DC-12 maximum	1 000 1/h
operational current at 1 current path at DC-13 <ul style="list-style-type: none"> at 24 V rated value at 110 V rated value at 220 V rated value at 440 V rated value at 600 V rated value 	<div>10 A</div> <div>1 A</div> <div>0.3 A</div> <div>0.14 A</div> <div>0.1 A</div>
operational current with 2 current paths in series at DC-13 <ul style="list-style-type: none"> at 24 V rated value at 60 V rated value at 110 V rated value at 220 V rated value at 440 V rated value at 600 V rated value 	<div>10 A</div> <div>3.5 A</div> <div>1.3 A</div> <div>0.9 A</div> <div>0.2 A</div> <div>0.1 A</div>
operational current with 3 current paths in series at DC-13	

<ul style="list-style-type: none"> • at 24 V rated value • at 60 V rated value • at 110 V rated value • at 220 V rated value • at 440 V rated value • at 600 V rated value 	10 A 4.7 A 3 A 1.2 A 0.5 A 0.26 A
operating frequency at DC-13 maximum	1 000 1/h
design of the miniature circuit breaker for short-circuit protection of the auxiliary circuit up to 230 V	C characteristic: 6 A; 0.4 kA
contact reliability of auxiliary contacts	1 faulty switching per 100 million (17 V, 1 mA)
UL/CSA ratings	
contact rating of auxiliary contacts according to UL	A600 / Q600
Short-circuit protection	
design of the fuse link for short-circuit protection of the auxiliary switch required	fuse gL/gG: 10 A
Installation/ mounting/ dimensions	
mounting position	+/-180° rotation possible on vertical mounting surface; can be tilted forward and backward by +/- 22.5° on vertical mounting surface
fastening method	screw and snap-on mounting onto 35 mm DIN rail
height	57.5 mm
width	45 mm
depth	73 mm
required spacing <ul style="list-style-type: none"> • with side-by-side mounting <ul style="list-style-type: none"> — forwards — upwards — downwards — at the side • for grounded parts <ul style="list-style-type: none"> — forwards — upwards — at the side — downwards • for live parts <ul style="list-style-type: none"> — forwards — upwards — downwards — at the side 	10 mm 10 mm 10 mm 0 mm 10 mm 10 mm 6 mm 10 mm 10 mm 10 mm 10 mm 6 mm
Connections/ Terminals	
type of electrical connection for auxiliary and control circuit	screw-type terminals
type of connectable conductor cross-sections <ul style="list-style-type: none"> • for auxiliary contacts <ul style="list-style-type: none"> — solid or stranded — finely stranded with core end processing • for AWG cables for auxiliary contacts 	2x (0.5 ... 1.5 mm²), 2x (0.75 ... 2.5 mm²), 2x 4 mm² 2x (0.5 ... 1.5 mm²), 2x (0.75 ... 2.5 mm²) 2x (20 ... 16), 2x (18 ... 14), 2x 12
Safety related data	
product function <ul style="list-style-type: none"> • positively driven operation according to IEC 60947-5-1 • suitable for safety function 	Yes Yes
suitability for use safety-related switching OFF	Yes
service life maximum	20 a
proportion of dangerous failures <ul style="list-style-type: none"> • with low demand rate according to SN 31920 • with high demand rate according to SN 31920 	40 % 73 %
B10 value with high demand rate according to SN 31920	1 000 000; With 0.3 x Ie
failure rate [FIT] with low demand rate according to SN 31920	100 FIT
ISO 13849	
device type according to ISO 13849-1	3
overdimensioning according to ISO 13849-2 necessary	Yes
IEC 61508	
safety device type according to IEC 61508-2	Type A

Electrical Safety	
protection class IP on the front according to IEC 60529	IP20
touch protection on the front according to IEC 60529	finger-safe, for vertical contact from the front
Approvals Certificates	
General Product Approval	



[Confirmation](#)



[KC](#)

General Product Approval	EMV	Functional Safety	Test Certificates		
		Type Examination Certificate	Type Test Certificates/Test Report	Special Test Certificate	Miscellaneous

Marine / Shipping					

other	Railway	Dangerous goods	Environment		
Miscellaneous	Confirmation	Special Test Certificate	Transport Information		Environmental Confirmations

Further information					
Information on the packaging					
https://support.industry.siemens.com/cs/ww/en/view/109813875					
Information- and Downloadcenter (Catalogs, Brochures,...)					
https://www.siemens.com/ic10					
Industry Mall (Online ordering system)					
https://mall.industry.siemens.com/mall/en/en/Catalog/product?mlfb=3RH2131-1BB40					
Cax online generator					
http://support.automation.siemens.com/WW/CAXorder/default.aspx?lang=en&mlfb=3RH2131-1BB40					
Service&Support (Manuals, Certificates, Characteristics, FAQs,...)					
https://support.industry.siemens.com/cs/ww/en/ps/3RH2131-1BB40					
Image database (product images, 2D dimension drawings, 3D models, device circuit diagrams, EPLAN macros, ...)					
http://www.automation.siemens.com/bilddb/cax_de.aspx?mlfb=3RH2131-1BB40&lang=en					
Characteristic: Tripping characteristics, I²t, Let-through current					
https://support.industry.siemens.com/cs/ww/en/ps/3RH2131-1BB40/char					
Further characteristics (e.g. electrical endurance, switching frequency)					
http://www.automation.siemens.com/bilddb/index.aspx?view=Search&mlfb=3RH2131-1BB40&objecttype=14&gridview=view1					

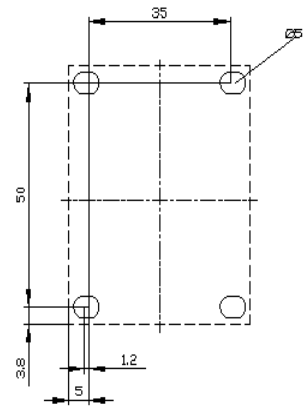
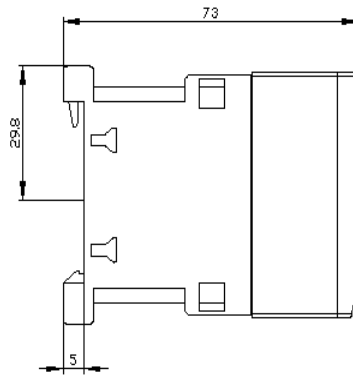
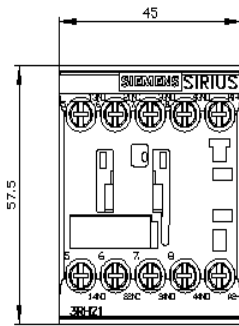

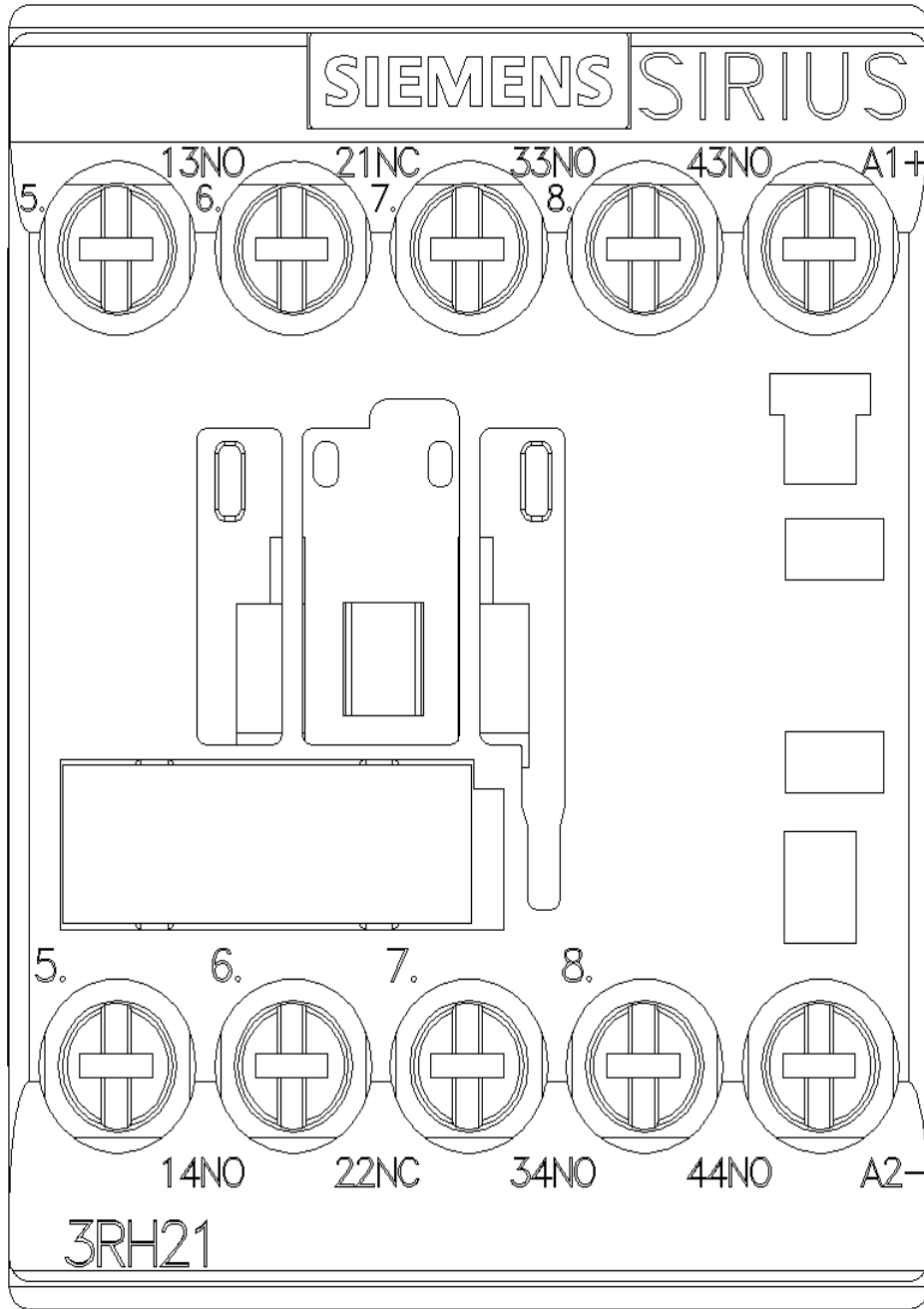

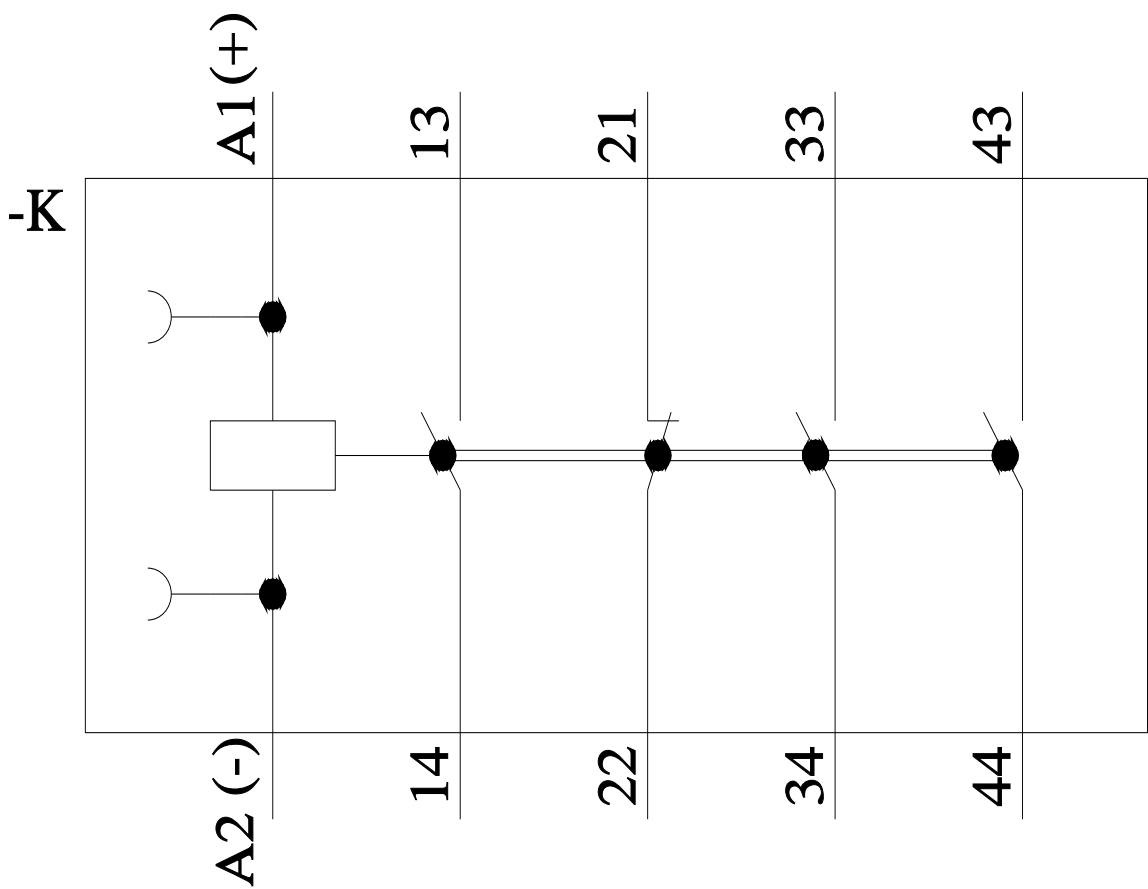

last modified:

5/28/2024 ↗