

Features

- ✧ Alarming by pressing, reset by a special key.
- ✧ Plug-in structure.
- ✧ Designed to comply with EN 54-11.

Description

DC-9204 Innovation Manual Call Point (MCP) is non-addressable. It alarms by the current caused by pressing the action plate. It can be simply connected to compatible conventional fire alarm system from various manufacturers. This MCP is suitable for public places. When there is fire, pressing the action plate on this MCP can send alarm signal to compatible conventional fire alarm control panel.

Connection and Cabling

Terminals on the MCP base are shown as Fig. 1.

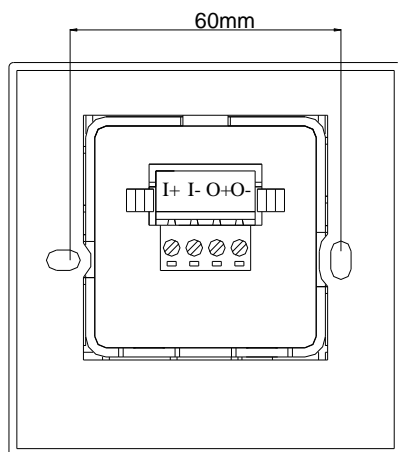

Fig. 1

I+, I-: Input signal, connecting with compatible control panel or the previous MCP.

O+, O-: Output signal, connecting with the next MCP.

Recommended Wiring

0.5mm² or above fire cable, subject to local codes.

Installation

The conduit can be surface mounted or flush mounted.

Surface mounting:

First install the back box onto the wall using 4 screws, then install the base onto the back box. Connect cables to corresponding terminals as described above. Hook the juts of the MCP body to the base, and then press the part below the action plate to combine them completely. Fig. 2 shows surface mounting.

Flush mounting:

Install the base onto the back box. Then combine the enclosure and base the same as surface mounting. Fig. 3 shows flush mounting.

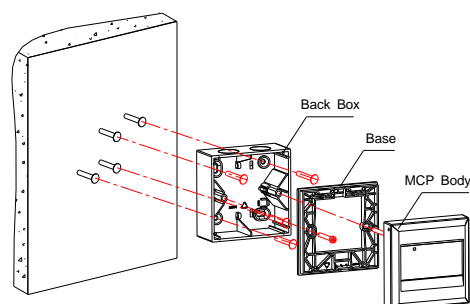

Fig. 2

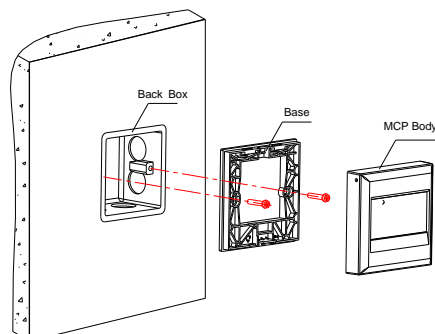

Fig. 3

Application

- ✧ Application of the MCP is shown in Fig. 4.

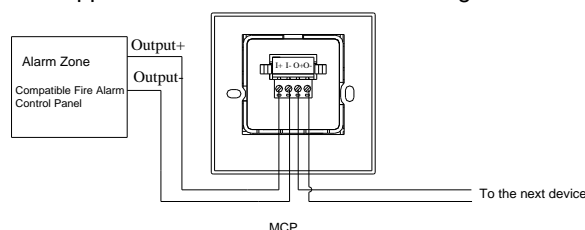

Fig. 4

✧ Usage of the key

Vertically insert the key into the key-hole, then push it with force and turn it clockwise. Turn the key back and pull it out when the action plate is rebounded.

✧ Usage of the test tool

The test tool is used to keep continuity during commissioning or maintenance when MCP is not installed, so that cable test can be carried out easily and make the circuit completed.

Limited Warranty

GST warrants that the product will be free of charge for repairing or replacing from defects in design, materials and workmanship during the warranty period. This warranty doesn't cover any product that is found to have been improperly installed or used in any way not in accordance with the instructions supplied with the product. Anybody, including the agents, distributors or employees, is not in the position to amend the contents of this warranty. Please contact your local distributor for products not covered by this warranty.

Specification

Operating Voltage	24VDC (12VDC ~28VDC)
Standby Current	0mA
Alarm Current	≤30mA (equivalent resistance is 470Ω/1W)
Indicator	Red. Illuminates after alarming.
Type of Initiating Part	Reusable
Initiating Mode	Pressing the action plate manually
Resuming Mode	Manually resumed by a special key
Wiring	two-wire
Class	Type A, indoor use
Ingress Protection Rating	IP43
Ambient Temperature	-10℃~+55℃
Relative Humidity	≤95%, non-condensing
Material of Enclosure	ABS
Dimensions (L×W×H)	87.1mm×87.1mm×58mm (with back box) 87.1mm×87.1mm×23mm (without back box)
Mounting Hole Distance	60mm
Weight	About 160g (with back box) About 107g (without back box)

This Data Sheet is subject to change without notice. Please contact GST for more information or questions.

Gulf Security Technology Co., Ltd.

No. 80, Changjiang East Road, QETDZ, Qinhuangdao, Hebei, P. R. China 066004

Tel: +86 (0) 335 8502434 Fax: +86 (0) 335 8502532

Features

- ✧ Electronically addressed. The address can be modified in field.
- ✧ Alarm by pressing, reset by a special key.
- ✧ Plug-in structure.
- ✧ Standard: EN 54-11.

Description

Connecting to the loop of GST fire alarm system, DI-9204E Digital Manual Call Point (MCP) is suitable for public places. When there is a fire, pressing the frangible element on this MCP can send fire signal to fire alarm control panel. After receiving the signal, the control panel will show address information of the MCP and generate alarm sound.

Connection and Cabling

Terminals on the MCP base are shown as Fig. 1 (unit: mm).

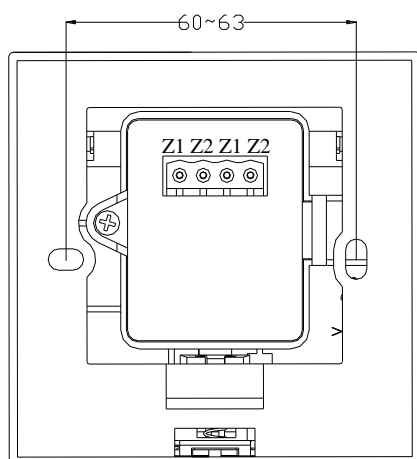

Fig. 1

Z1, Z2: Connecting with loop of the control panel, polarity-insensitive.

Recommended Cabling

0.5mm² or above fire cable, subject to local codes.



2831-CPR-F0130
GST-0011-01

13



548g/08

Installation

The MCP can be mounted in two ways: conduit embedded and surface mounting.

Surface Mounting: First install the back box into the wall using 4 screws, and then install the base onto the back box. Connect cables to corresponding terminals as described above. Hook the juts of the MCP body to the base, and then press the part below the frangible element to combine them completely, and then screw the lock screw as shown in Fig. 2.

Conduit Embedded: First install the base onto the back box, then connect the MCP body and the base followed instructions above, then screw the lock screw as shown in Fig. 3.

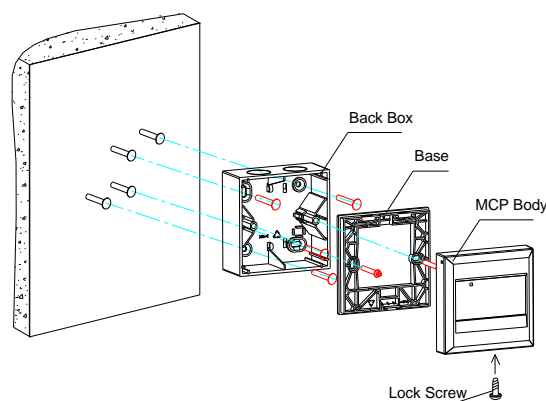

Fig. 2

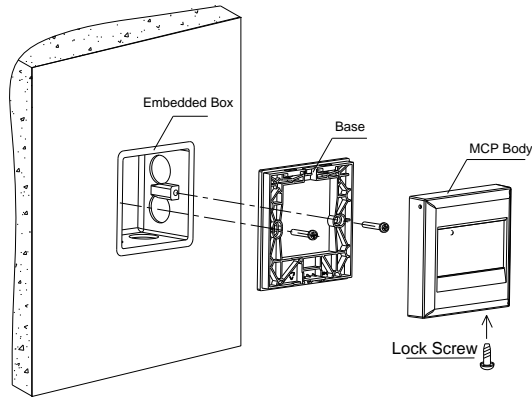

Fig. 3

Application

- ✧ The MCP should be programmed using P-9910B programmer. Please refer to P-9910B Hand Held Programmer Installation and Operation Manual.
- ✧ Z1 and Z2 are to be connected with the loop of fire alarm control panel. If it's correct, the FACP can register the MCP.
- ✧ Usage of the key
Vertically insert the key into the key-hole, and turn it clockwise, then push it with force. Turn the key back and pull it out when the frangible element is rebounded.
- ✧ Compatible equipment
It can be used with GST control panels such as GST200, GST200-2, GST200N, GST-IFP8.

Accessories and Tools

Model	Name	Remarks
P-9910B	Handheld Programmer	Order separately

WEEE Information



2012/19/EU (WEEE directive): Products marked with this symbol cannot be disposed of as unsorted municipal waste in the European Union. For proper recycling, return this product to your local supplier upon the purchase of equivalent new equipment, or dispose of it at designated collection points.

Operating Voltage	Loop 24V (16V~28V)
Standby Current	≤0.6mA
Alarm Current	≤1.8mA
Indicator	Red. Flashes every 3s normally. Illuminates after alarming.
Type of Initiating Part	Reusable
Initiating Mode	Pressing the frangible element manually
Resuming Mode	Manually resumed by a special key
Programming Mode	Electronically addressed
Address Range	One address within 1~242.
Wiring	Polarity-insensitive two-wire
Class	Type A, indoors.
Ingress Protection Rating	IP43
Environmental Temperature	-10°C~+55°C
Relative Humidity	≤95%, non condensing
Material of Enclosure	ABS, red
Dimension (L×W×H)	87.1mm×87.1mm×58.5mm (with back box) 87.1mm×87.1mm×23.5mm (without back box)
Mounting Distance	60mm
Weight	About 160g (with back box) About 107g (without back box)

Limited Warranty

GST warrants that the product will be free from defects in design, materials and workmanship during the warranty period. This warranty shall not apply to any product that is found to have been improperly installed or used in any way not in accordance with the instructions supplied with the product. Anybody, including the agents, distributors or employees, is not in the position to amend the contents of this warranty. Please contact your local distributor for products not covered by this warranty.

This Data Sheet is subject to change without notice. Please contact GST for more information or questions.

Gulf Security Technology Co., Ltd.

No. 80, Changjiang East Road, QETDZ, Qinhuangdao, Hebei, P. R. China 066004

Tel: +86 (0) 335 8502434 Fax: +86 (0) 335 8502532