



**FG230**

CAST - IRON CYLINDER LINER  
TWO MAIN BALL BEARINGS  
MECHANICAL GOVERNOR

232cm<sup>3</sup>, 4.3kW (5.8Hp) / 4000rpm

### GENERAL SPECIFICATIONS

Engine Type	Forced air-cooled 4-stroke, horizontal shaft, gasoline engine
Number of Cylinder	1
Bore x Stroke	74 x 54mm ( 2.91 x 2.13in. )
Piston Displacement	232cm <sup>3</sup> ( 14.2cu.in. )
Compression Ratio	6.4 : 1
Max.Horse Power	4.3kW ( 5.8Hp ) / 4000rpm
Max.Torque	12.0N-m ( 8.9ft.lbs ) / 2800rpm
Direction of Rotation	Counter-clockwise facing the PTO shaft
Fast Idle Speed	4000rpm
Slow Idle Speed	1600rpm
Fuel	Unleaded gasoline
Fuel Tank Capacity	4.5litre ( 4.8US.qt. )
Min.Specific Fuel Consumption Ratio	415gr/kW-hr ( 305gr/Hp-hr )
Carburetor	Float type with fixed main jet
Oil	Gasoline engine oil SAE10W-30
Oil Capacity	0.7litre ( 0.7US.qt. )
Ignition	Flywheel magneto transistor type
Plug	NGK BP4HS
Starter	Recoil starter with Automatic Compression Release
Governor	Mechanical governor
Lubrication	Splash system
Air Cleaner	Dual element
Muffler	Low tone type with adjustable deflector
Net Weight	19.5kg ( 43.0lbs )
Dimension ( L x W x H )	356 x 357 x 401mm ( 14.02 x 14.06 x 15.79in. )

FG230G	2 : 1 cam gear reduction
--------	--------------------------

Specifications subject to change without notice.

### PERFORMANCE CURVES

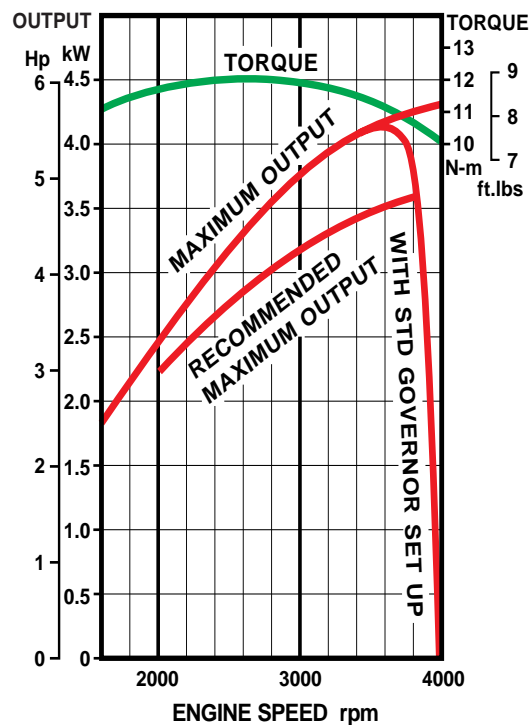

**Kawasaki**  
Let the good times roll.

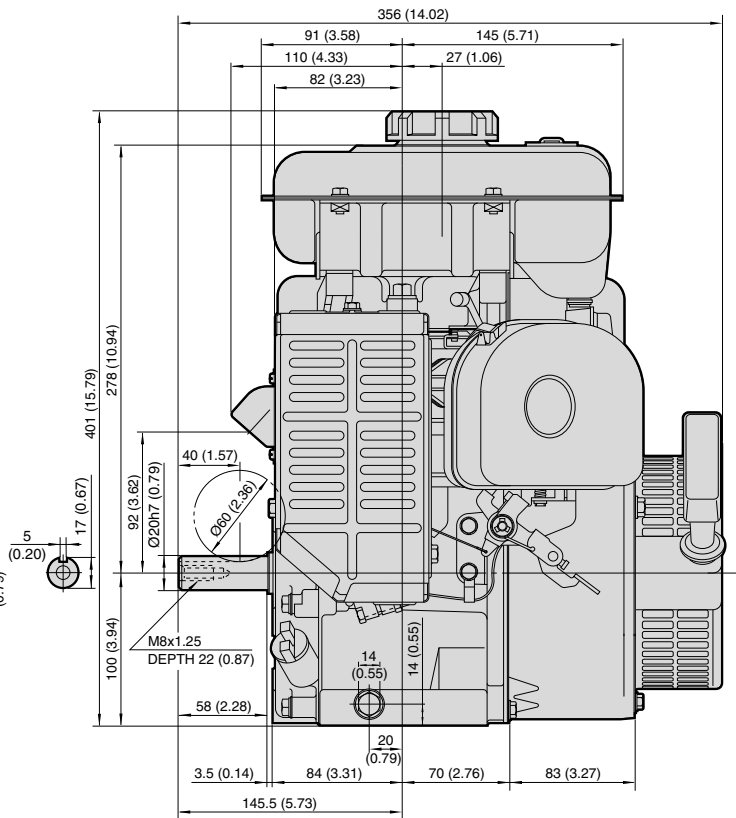
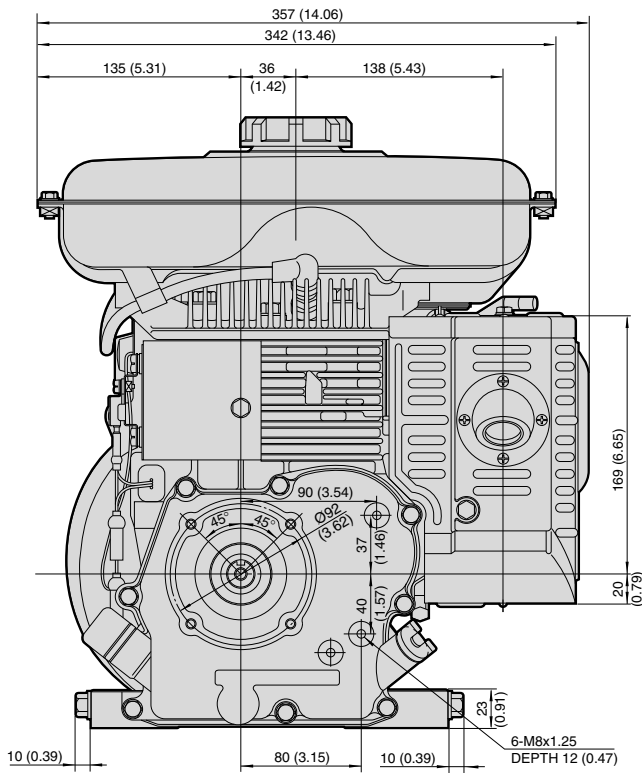

**FG230D STRAIGHT SHAFT  
( METRIC )**

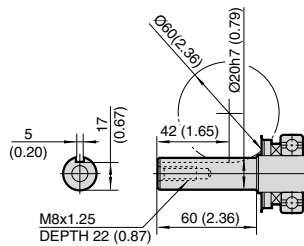
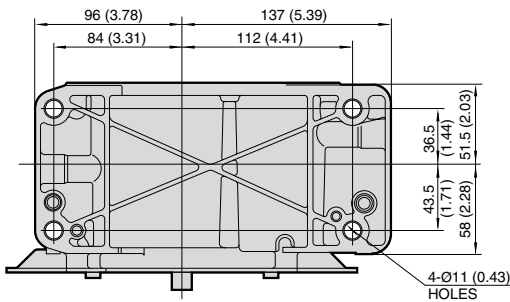

**FG230G STRAIGHT SHAFT  
( METRIC )**

