

Features

1. Quick response.
2. Stainless steel stem provides exceptional durability.
3. Flange type is available for JIS 10K, ANSI 150LB and PN16.
4. Ex-proof coil T4 as optional accessory, please refer to page 5-9.
5. Timer for setting on/off time as optional accessory.
6. CE conformity for all series.
7. Coil nut is available, please refer to page 5-3.



How to order

PU220A N	V	F	-	O3	N	-	S1	L	E
Brass Assisted Lift	Acting style	Diaphragm	Port size	Port size	Thread	Voltage	LED	Ex-Proof coil	
	Blank : Normally closed N : Normally open	Blank : NBR V : VITON E : EPDM H : HNBR	Blank : W/O Flange F : 10K F3 : 150LB F4 : PN16 only far A series	O3 : 3/8" O4 : 1/2" O6 : 3/4" O8 : 1"	Blank : G N : NPT R : Rc	S1 : 110VAC S2 : 220VAC S6 : 24VAC S7 : 12VDC S9 : 24VDC	Blank : W/O LED L : W/I LED	Blank : Standard E : Ex-proof coil	

How to order Repair kit

ZGPU220A	-	O3	N	
Repair kit	Port size	Diaphragm	Description	Qty.
ZGPU220A (Normally closed)	O3 : 3/8", 1/2"	N : NBR	Diaphragm set	1
ZGPU220AN (Normally open)	O6 : 3/4" O8 : 1"	V : VITON E : EPDM H : HNBR	Spring	1
			Packing	1

Specifications

Model	PU220A-03	PU220A-04	PU220A-06	PU220A-08
Port size	3/8"	1/2"	3/4"	1"
Fluid	Compressed air (light oil, water)			
Orifice	13mm	13mm	20mm	25mm
Effective area	76mm ²	76mm ²	162mm ²	220mm ²
Acting	Assisted Lift			
Construction	Diaphragm			
Operating pressure range AC	0 ~ 7 kgf/cm ²			
Operating pressure range DC	0 ~ 6 kgf/cm ²		0 ~ 5 kgf/cm ²	
Proof pressure	10 kgf/cm ²			
Body material / Flange material	Forged Brass / Steel SS41			
Fluid temperature	-10°C ~ 90°C			
Ambient temperature	-10°C ~ 60°C			
Installation	Horizontal			
Duty cycle	100% ED			
Coil type	DIN			
Protection class	IP65 (DIN 40 050)			
Insulation class	F			
Voltage tolerance	± 10%			
Standard voltage	220VAC, 110VAC, 24VDC, the other voltage is optional			
Power consumption	AC110V: 17.6VA, AC220V: 18.1VA, DC: 15W (DC: 18.5W option)			
Net weight	740g	740g	945g	1485g

Seal material selection guide

Seal	Temperature range	Suitable fluid	Unsuitable fluid
NBR	-15°C ~ 80°C	Air, Water, Neutral gases, Mineral oil	Fuel oil, Gasoline and Hi-test gasoline, Diesel fuel
HNBR	-40°C ~ 150°C	Air, Water, Gear oil, Engine oil	Pharmaceutical liquid, Gasoline and Hi-test gasoline, Light oil
VITON	-10°C ~ 180°C	Fuel oil, Gasoline and Hi-test gasoline, Diesel fuel	Hot water, Steam, Brake oil (ATE Blue)
EPDM	-5°C ~ 130°C	Hot water, Detergent liquid	Mineral oil, Gasoline

Dimensions

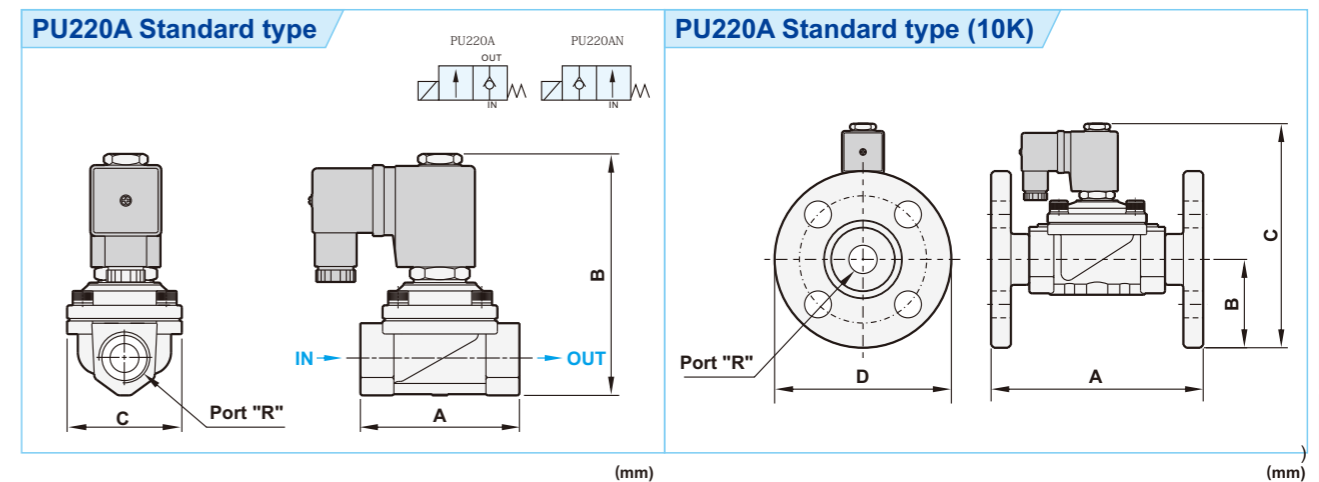

Model	PU220A-03	PU220A-04	PU220A-06	PU220A-08	Model	PU220AF-03	PU220AF-04	PU220AF-06	PU220AF-08
R	3/8"	1/2"	3/4"	1"	R	3/8"	1/2"	3/4"	1"
A	66.5	66.5	71	96	A	110	110	120	150
B	101	101	107	120.5	B	45	47.5	50	62.5
C	48	48	58	70.7	C	130.5	133	138.5	158.5
					D	90	95	100	125

Explosion

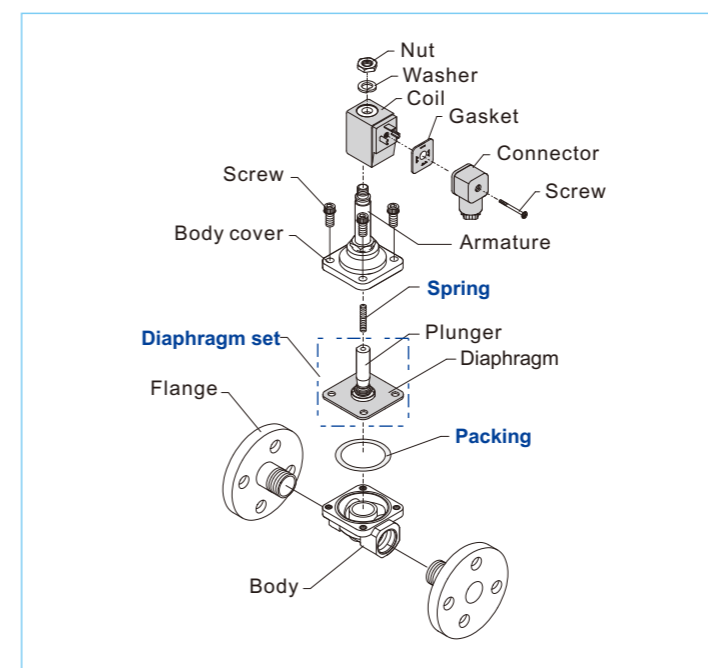

Flow chart

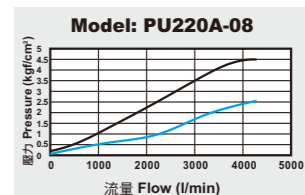
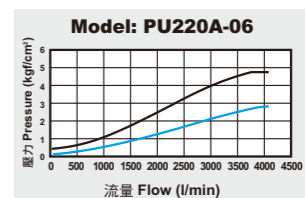
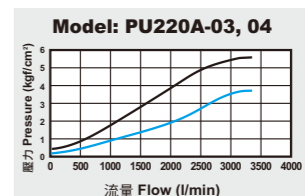

Features

1. Direct acting.
2. Quick response.
3. Timer for setting on/off time as optional accessory.
4. Ex-proof coil is available, please refer to page 5-9, 5-10.
5. Coil nut is available, please refer to page 5-1, 5-3.



How to order

PU220AR V - 01 1 N - S1 L E1

Brass Direct acting	Diaphragm	Port size	Pressure	Thread	Voltage	Led	Ex-Proof coil
	Blank: NBR V: VITON E: EPDM H: HNBR	01: 1/8" 02: 1/4" 03: 3/8"	Blank: Standard 1: High pressure 2: Medium pressure <small>*High pressure & Medium pressure are only available for PU220AR-01 & PU220AR-02</small>	Blank: G N: NPT R: Rc	S1: 110VAC S2: 220VAC S6: 24VAC S7: 12VDC S9: 24VDC	Blank: W/O LED L: W/I LED	Blank: DIN E1: EX-proof 22mm width E2: EX-proof 30mm width E3: EX-proof CSA standard E4: EX-proof 36mm width <small>PU220AR-03 is only available for E4 ex-proof coil.</small>

How to order Repair kit

ZGPU220AR - 01 N

Repair kit	Port size	Diaphragm
	01: 1/8", 1/4" 03: 3/8"	N: NBR V: VITON E: EPDM H: HNBR

ZGPU220AR-01	
Description	Qty.
Plunger	1
O-ring	1

ZGPU220AR-03	
Description	Qty.
Plunger	1
Orifice adaptor	1
Diaphragm	1
O-ring	1

Specifications

Model	PU220AR-01	PU220AR-011	PU220AR-012	PU220AR-02	PU220AR-021	PU220AR-022	PU220AR-03
Port size	1/8"			1/4"			3/8"
Fluid	Compressed air (light oil, water)						
Orifice	1.5mm	0.8mm	1.2mm	2.3mm	1.2mm	1.5mm	8.0mm
Effective area	1.8mm ²			3.3mm ²			20.64mm ²
Acting	Direct acting						Assisted lift
Construction	Gasket						Diaphragm
Operating pressure range AC	0~8.5 kgf/cm ²	0~20kgf/cm ²	0~16kgf/cm ²	0~8.5kgf/cm ²	0~20kgf/cm ²	0~16kgf/cm ²	0~8.5kgf/cm ²
Operating pressure range DC	0~7 kgf/cm ²	0~13kgf/cm ²	0~10kgf/cm ²	0~7kgf/cm ²	0~13kgf/cm ²	0~10kgf/cm ²	0~7kgf/cm ²
Proof pressure	10 kgf/cm ²						
Body material	Brass						
Fluid temperature	-10°C ~ 90°C						
Ambient temperature	-10°C ~ 60°C						
Installation	Any direction (Horizontal is recommended)						
Duty cycle	100% ED						
Coil type	DIN						
Protection class	IP65 (DIN 40 050)						
Insulation class	F						
Voltage tolerance	±10%						
Standard voltage	220VAC, 110VAC, 24VDC, the other voltage is optional						
Power consumption	AC: 6.0VA, DC: 4.8W						AC110V:17.6VA, AC220V:18.1VA, DC:15W (DC:18.5W option)
Net weight	175g			255g			510g

Seal material selection guide

Seal	Temperature range	Suitable fluid	Unsuitable fluid
NBR	-15°C ~ 80°C	Air, Water, Neutral gases, Mineral oil	Fuel oil, Gasoline and Hi-test gasoline, Diesel fuel
HNBR	-40°C ~ 150°C	Air, Water, Gear oil, Engine oil	Pharmaceutical liquid, Gasoline and Hi-test gasoline, Light oil
VITON	-10°C ~ 180°C	Fuel oil, Gasoline and Hi-test gasoline, Diesel fuel	Hot water, Steam, Brake oil (ATE Blue)
EPDM	-5°C ~ 130°C	Hot water, Detergent liquid	Mineral oil, Gasoline

Dimensions

PU220AR-01

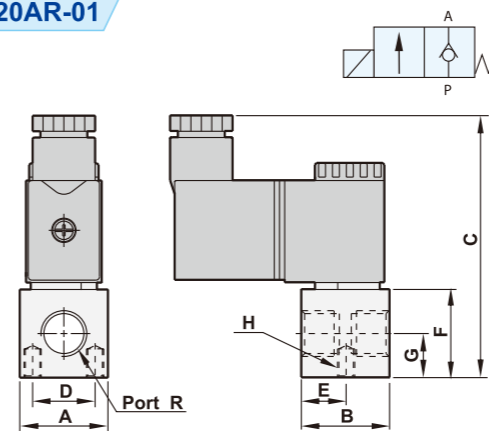

PU220AR-02

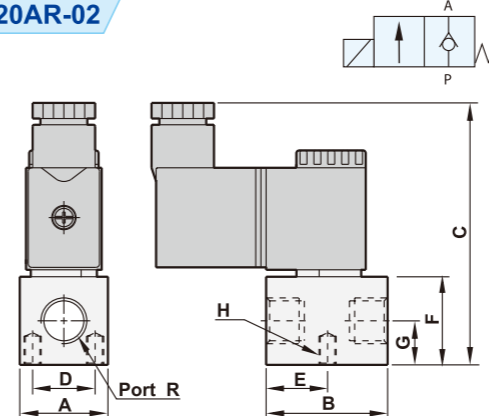

PU220AR-03

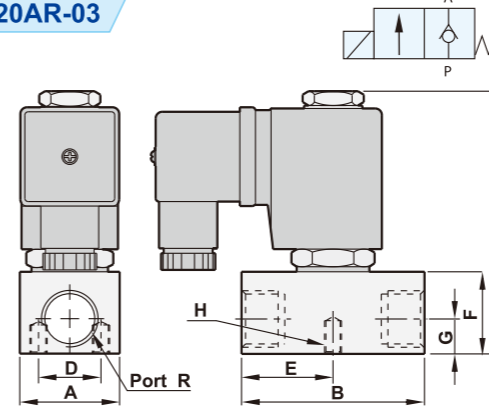

Model	PU220AR-01	PU220AR-02	PU220AR-03
R	1/8"	1/4"	3/8"
A	22	25.4	30
B	22	35	55
C	72	75	79
D	15	18	18
E	11	17.5	27.5
F	22	25.4	25
G	7.5	12.7	11
H	M4xP0.7xL6.5	M5xP0.8xL7.0	M5xP0.8xL7.0

Flow chart

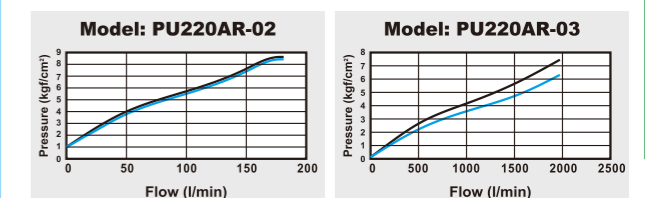

Explosion

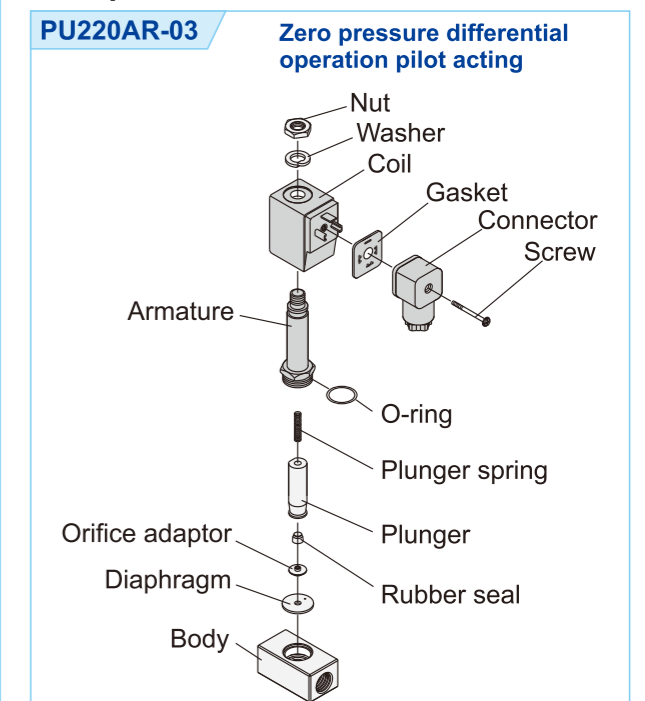

Features

1. Pilot acting for low starting pressure.
2. Large flow rate and high working pressure.
3. Quick response.
4. Stainless steel stem provides exceptional durability.
5. Flange type is available for JIS 10K, ANSI 150LB and PN16.
6. Ex-proof coil T4 as optional accessory, please refer to page 5-9.
7. Timer for setting on/off time as optional accessory.
8. CE conformity for all series.
9. Coil nut is available, please refer to page 5-3.



How to order

Pilot Acting	Acting style	Diaphragm	Port size	Port size	Thread	Voltage	LED	Ex-Proof coil
Blank : Normally closed N : Normally open	Blank : NBR V : VITON E : EPDM H : HNBR	Blank : W/O Flange F : 10K F3 : 150LB F4 : PN16	03 : 3/8" 04 : 1/2" 06 : 3/4" 08 : 1" 12 : 1 1/4" 14 : 1 1/2" 20 : 2"	Blank : G N : NPT R : Rc	S1 : 110VAC S2 : 220VAC S6 : 24VAC S7 : 12VDC S9 : 24VDC	Blank : W/O LED L : W/I LED	Blank : Standard E : Ex-proof coil	

How to order Repair kit

Repair kit	Port size	Diaphragm	Description	Qty.
ZGPU225A (Normally closed) ZGPU225AN (Normally open)	03 : 3/8", 1/2" 06 : 3/4", 1" 12 : 1-1/4", 1-1/2" 20 : 2"	N : NBR V : VITON E : EPDM H : HNBR	Plunger	1
			Spring	2
			Diaphragm	1

Specifications

Model	PU225A-03	PU225A-04	PU225A-06	PU225A-08	PU225A-12	PU225A-14	PU225A-20
Port size	3/8"	1/2"	3/4"	1"	1 1/4"	1 1/2"	2"
Fluid	Compressed air (light oil, water)						
Orifice	13mm		25mm		38mm		50mm
Effective area	88mm ²		230mm ²		404mm ²		552mm ²
Acting	Pilot acting						
Construction	Diaphragm						
Operating pressure range	0.5 ~ 10kgf/cm ² (0.5 ~ 10.0Bar)						
Proof pressure	15 kgf/cm ² (15.0Bar)						
Body / Flange material	Forged Brass / Steel SS41						
Fluid temperature	-10°C ~ 90°C						
Ambient temperature	-10°C ~ 60°C						
Installation	Horizontal						
Duty cycle	100% ED						
Coil type	DIN						
Protection class	IP65 (DIN 40 050)						
Insulation	F						
Voltage tolerance	± 10%						
Standard voltage	220VAC, 110VAC, 24VDC, the other voltage is optional						
Power consumption	Normally closed AC110V: 17.6VA; AC220V: 18.1VA; DC:15W/Normally open AC: 17.8VA; DC:15W						
Net weight	775g		1550g		2820g		4665g

Seal material selection guide

Seal	Temperature range	Suitable fluid	Unsuitable fluid
NBR	-15°C ~ 80°C	Air, Water, Neutral gases, Mineral oil	Fuel oil, Gasoline and Hi-test gasoline, Diesel fuel
HNBR	-40°C ~ 150°C	Air, Water, Gear oil, Engine oil	Pharmaceutical liquid, Gasoline and Hi-test gasoline, Light oil
VITON	-10°C ~ 180°C	Fuel oil, Gasoline and Hi-test gasoline, Diesel fuel	Hot water, Steam, Brake oil (ATE Blue)
EPDM	-5°C ~ 130°C	Hot water, Detergent liquid	Mineral oil, Gasoline

Dimensions

PU225A Standard type

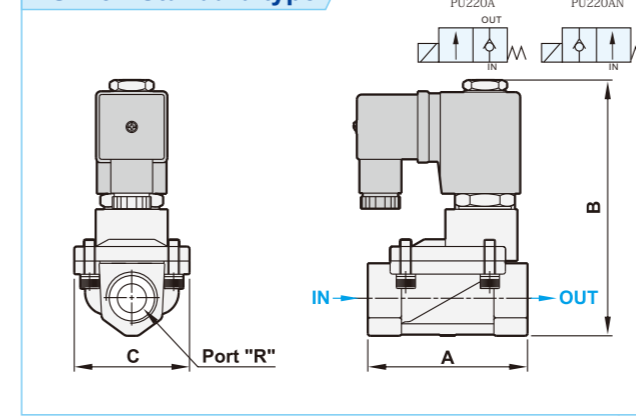

PU225A Standard type (10K)

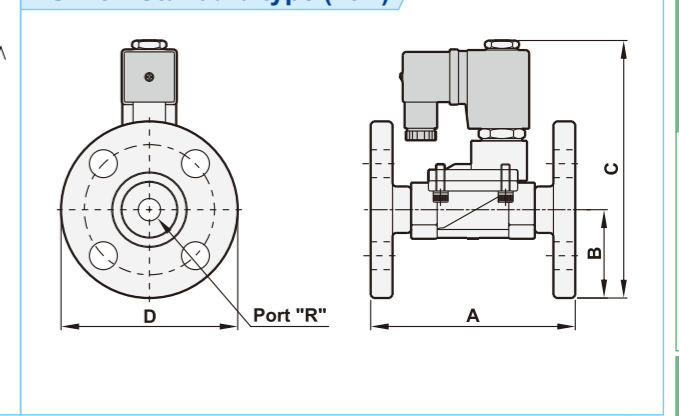

Model	PU225A-03	PU225A-04	PU225A-06	PU225A-08	PU225A-12	PU225A-14	PU225A-20	Model	PU225AF-03	PU225AF-04	PU225AF-06	PU225AF-08	PU225AF-12	PU225AF-14	PU225AF-20
R	3/8"	1/2"	3/4"	1"	1 1/4"	1 1/2"	2"	R	3/8"	1/2"	3/4"	1"	1 1/4"	1 1/2"	2"
A	66.5	66.5	96	96	131.5	131.5	160	A	110	110	145	150	180	180	210
B	106.5	106.5	126	126	145.5	145.5	160	B	45	47.5	50	62.5	67.5	70	77.5
C	48.5	48	70.7	70.7	96	96	112	C	136	138.5	153	165.5	173	182.5	210
								D	90	95	100	125	135	140	155

Explosion

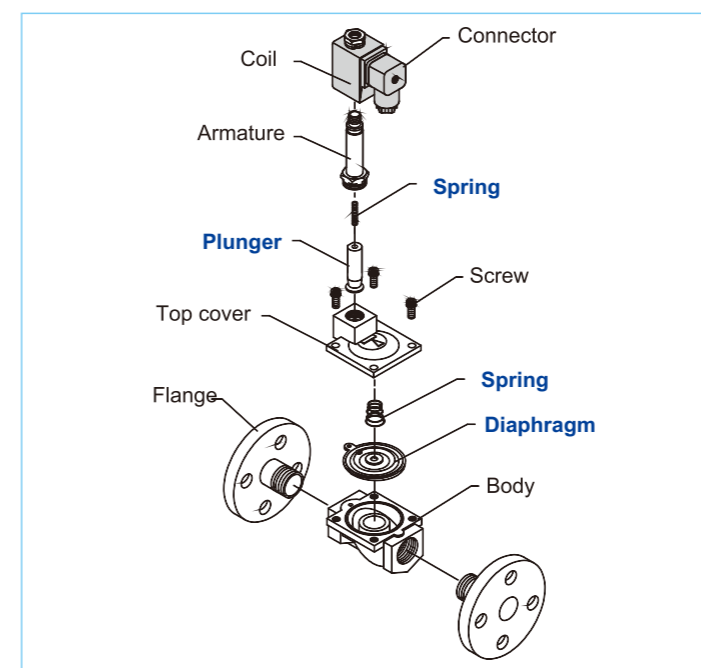

Flow chart

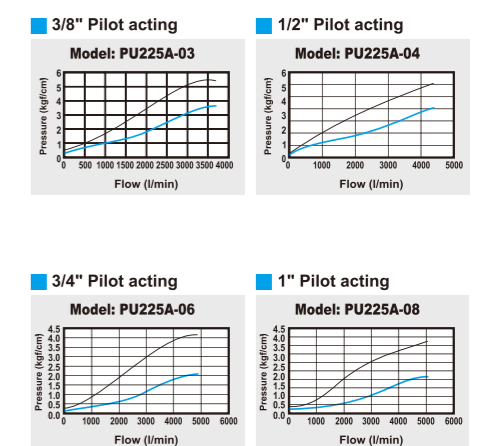

Features

1. Pilot acting for low starting pressure.
2. Large flow rate and high working pressure.
3. Quick response.
4. Stainless steel body and stem provide exceptional durability.
5. Flange type is available for JIS 10K, ANSI 150LB and PN16.
6. Ex-proof coil T4 as optional accessory, please refer to page 5-9.
7. Timer for setting on/off time as optional accessory.
8. CE and EX-proof certified for all series.
9. Coil nut is available, please refer to page 5-3.

How to order

SPU225A N	E	F	-	O3	N	-	S1	L	E
Stainless steel Pilot acting	Acting style Blank :Normally closed N :Normally open	Diaphragm Blank :VITON B :NBR E :EPDM H :HNBR	Port size Blank :W/O Flange F :10K F3 :150LB F4 :PN16	Port size O3 :3/8" O4 :1/2" O6 :3/4" O8 :1" O12 :1 1/4" O14 :1 1/2" O20 :2"	Thread Blank :G N :NPT R :Rc	Voltage S1 :110VAC S2 :220VAC S6 :24VAC S7 :12VDC S9 :24VDC	LED Blank :W/O LED L :W/I LED	Ex-Proof coil Blank :Standard E :Ex-proof coil	

How to order Repair kit

ZGPU225A	-	O3	N	Description	Qty.
Repair kit		Port size	Diaphragm	Plunger	1
ZGPU225A (Normally closed)		O3 :3/8", 1/2"	N :NBR	Spring	2
ZGPU225AN (Normally open)		O6 :3/4", 1" O12 :1-1/4", 1-1/2" O20 :2"	V :VITON E :EPDM H :HNBR	Diaphragm	1

Specifications

Model	SPU225A-03	SPU225A-04	SPU225A-06	SPU225A-08	SPU225A-12	SPU225A-14	SPU225A-20
Port size	3/8"	1/2"	3/4"	1"	1 1/4"	1 1/2"	2"
Fluid	Compressed air (light oil, water)						
Orifice	13mm		25mm		38mm		50mm
Effective area	88mm ²		230mm ²		404mm ²	552mm ²	883mm ²
Acting	Pilot acting						
Diaphragm	VITON (Standard), NBR, EPDM (Option)						
Operating pressure range	0.5 ~ 10 kgf/cm ²						
Proof pressure	15 kgf/cm ²						
Body /Flange material	Stainless steel SUS316 / SUS304,SUS316						
Fluid temperature	-10°C ~ 90°C						
Ambient temperature	-10°C ~ 60°C						
Installation	Horizontal						
Duty cycle	100% ED						
Coil type	DIN						
Protection class	IP65 (DIN 40 050)						
Insulation class	F						
Voltage tolerance	± 10%						
Standard voltage	220VAC, 110VAC, 24VDC, the other voltage is optional						
Power consumption	Normally closed AC110V: 17.6VA; AC220V: 18.1VA; DC:15W/Normally open AC: 17.8VA; DC:15W						
Net weight	775g		1550g		2820g		4665g

www.famcocorp.com

E-mail: info@famcocorp.com

@famco_group

Tel: ۰۲۱-۴۸۰۰۰۰۴۹

Fax: ۰۲۱-۴۴۹۹۴۶۴۲

تهران، کیلومتر ۲۱ بزرگراه لشگری (جاده مخصوص کرج)

روبروی پالایشگاه نفت پارس، پلاک ۱۲

Seal material selection guide

Seal	Temperature range	Suitable fluid	Unsuitable fluid
NBR	-15°C ~ 80°C	Air, Water, Neutral gases, Mineral oil	Fuel oil, Gasoline and Hi-test gasoline, Diesel fuel
HNBR	-40°C ~ 150°C	Air, Water, Gear oil, Engine oil	Pharmaceutical liquid, Gasoline and Hi-test gasoline, Light oil
VITON	-10°C ~ 180°C	Fuel oil, Gasoline and Hi-test gasoline, Diesel fuel	Hot water, Steam, Brake oil (ATE Blue)
EPDM	-5°C ~ 130°C	Hot water, Detergent liquid	Mineral oil, Gasoline

Dimensions

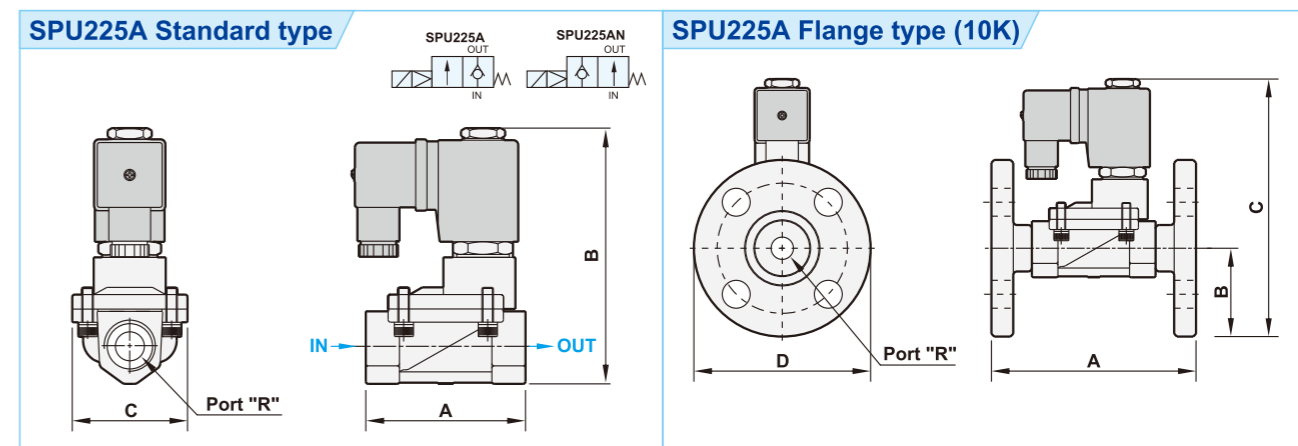

Model	SPU225A-03	SPU225A-04	SPU225A-06	SPU225A-08	SPU225A-12	SPU225A-14	SPU225A-20	Model	SPU225AF-03	SPU225AF-04	SPU225AF-06	SPU225AF-08	SPU225AF-12	SPU225AF-14	SPU225AF-20
R	3/8"	1/2"	3/4"	1"	1 1/4"	1 1/2"	2"	R	3/8"	1/2"	3/4"	1"	1 1/4"	1 1/2"	2"
A	66.5	66.5	100	100	131.5	131.5	160	A	110	110	149	150	180	180	210
B	106.5	106.5	126.5	126.5	145.5	145.5	160.5	B	45	47.5	50	62.5	67.5	70	77.5
C	48	48	75	75	96	96	112	C	137	139.5	152.5	164	173	182.5	210
								D	90	95	100	125	135	140	155

Explosion

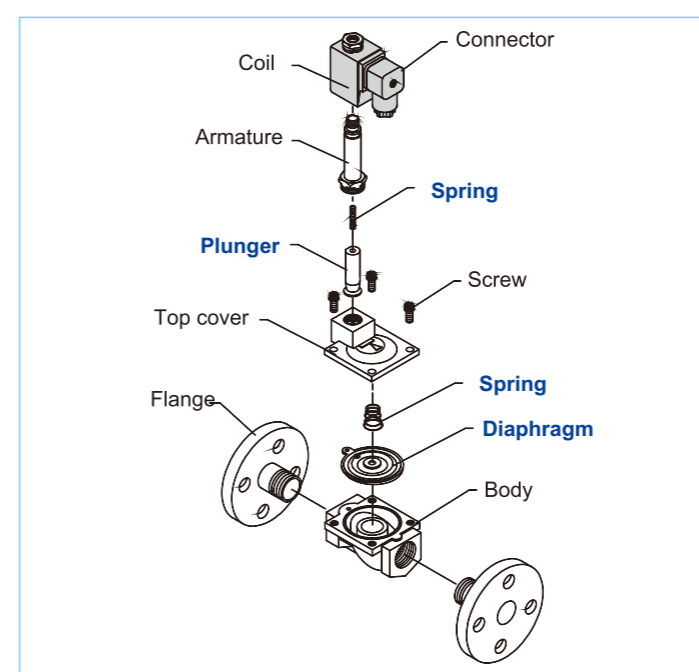

Flow chart

