

FAMCO
هایپر صنعت



VIBRATION ROLLER

Vibration Roller 27

Safety Operation

Deadman Brake

Deadman brake prevents accidents when backing up the machine.



Deadman brake

Head Light and Rubber Bumper

Head LED Light suited nighttime work is equipped as standard. Rubber Bumper is equipped as standard to protect the machine from the impact of frontal collisions. (MRH-501•601•700)



Self-start safety design

Engine self-start is a safety feature that is designed to prevent the engine from starting if the travel lever is not in the neutral position.

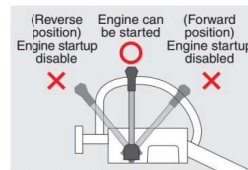

Soft Start

Prevent Drum-mark against surface of paving asphalt.

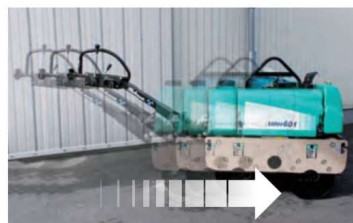

Safety Transportation

To transfer safety by a truck

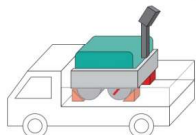

To prevent slide off, be sure to use **Drum stopper** and **Handbrake**. (MRH-501•601•700)



Drum stopper



Handbrake

Safety mechanism



The mechanism is worked to suppress runaway on a slope (when the engine is stopped). Be sure to park the machine on a flat area.

Periodically Maintenance

Hour Meter is equipped as standard.

Hour meter is equipped as standard. It lets you check work and maintenance time. (MRH-501DS•601DS•700DSCB)

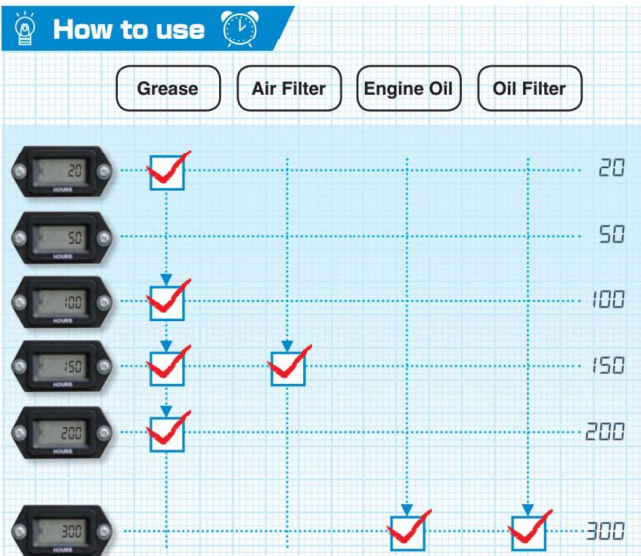

Hydraulic Pipe Guard

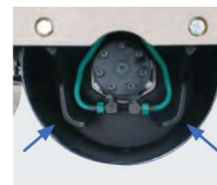

One-Touch-Open Center Cover



Saving your time

Work efficiency

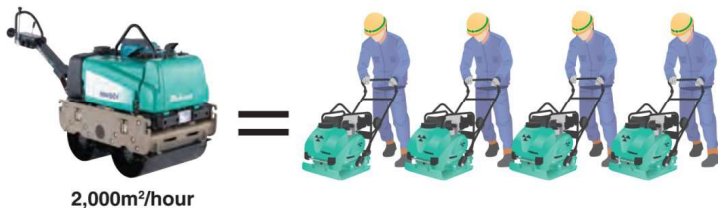

Compaction Area/Hour

| MODEL | Width | | Speed | | Compaction area/hour m ² |
|--------------------------|-------|-------|-------|------|--|
| | mm | m(A) | m/min | m | |
| ① MVC-F60 | 350 | 0.350 | 25 | 1500 | 525.0 |
| ② MRH-601DS MRH-700DS | 650 | 0.650 | 50 | 3000 | 1950.0 |

① 0.350m (A) x 25m/min. x 60min/hour = 525m²/hour
 ② 0.650m (A) x 50m/min. x 60min/hour = 1,950m²/hour

Design for fine visibility

The design for low-center of gravity lets you see easily in front of the roller.



Excellent side clearance

The small side clearance between drum and frame makes you align easily.



Safety Design for both of Up and Down hill

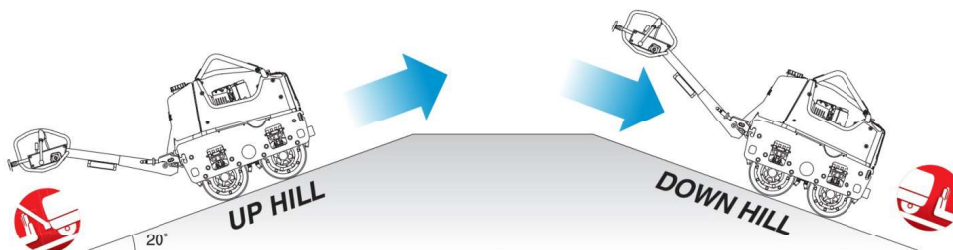

Engine Guard

Engine guard is equipped as standard to prevent damage to engine during working close to a wall.



Compact Design

It makes you enable to keep space by handle with upright when storing or transporting.

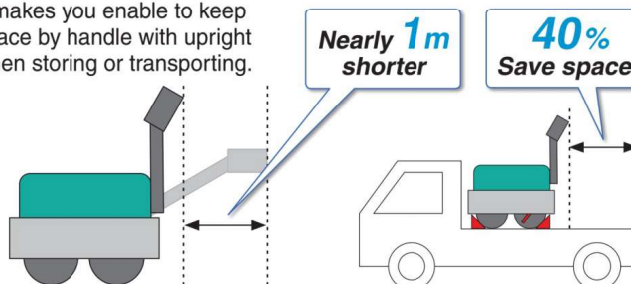

Vibration Roller

- Mikasa's original strainer and plastic water tank prevents the sprinkler pipes from clogging.
- The durability of travel motor have been improved.
- Rubber Bumper is equipped as standard to absorb the impact from frontal collisions lessening the damage to the machine.
- Head LED Light suited nighttime work is equipped as standard.

FAMCO
هایپر صنعت

MRH-601DS (551kg)

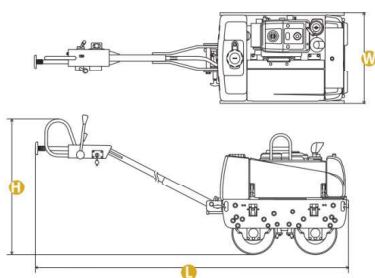

● One-Touch Center Cover



● Head LED Light and Rubber Bumper

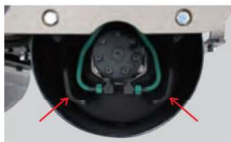

● Hydraulic Pipe Guard



● Engine Guard



● Handbrake



● Drum Stopper



● Deadman Brake



● Buzzer and Light Switch



● Vibration Switch



● Hour Meter

MRH Specifications

| model | weight (kg) | dimensions (mm) | drum size (mm) | vibrating frequency Hz (V.P.M.) | centrifugal force kN (kgf) | traveling speed (km/h) | max.limited gradeability (%) | water tank (lits) | power source kW (PS) |
|--------------------------|-------------|-----------------------------------|--------------------------|---------------------------------|----------------------------|------------------------|------------------------------|-------------------|--|
| MRH-601DS (water cooled) | 551 | H : 1,195 W : 692 L : 2,265 | dia : 355 width : 650 | 55 (3,300) | 10.8 (1,100) | 0-3 | 35 | 30 | Kubota EA330 diesel (electric start) max. output 4.6 (6.3) |

MRH-700DSCB (700kg)



● Recoil Start
(MRH-700DSCB/700GS)

MRH-700GS (680kg)



MRH Specifications

| model | weight (kg) | dimensions (mm) | drum size (mm) | vibrating frequency Hz (V.P.M.) | centrifugal force kN (kgf) | traveling speed (km/h) | max.limited gradeability (%) | water tank (lits) | power source kW (PS) |
|------------------------------|-------------|----------------------------------|--------------------------|---------------------------------|----------------------------|------------------------|------------------------------|-------------------|--|
| MRH-501DS (water cooled) | 530 | H : 1,195 W: 617 L : 2,265 | dia : 355 width : 575 | | 10.0 (1,020) | | | 30 | Kubota EA330 diesel (electric start) max. output 4.6 (6.3) |
| MRH-700DSB (water cooled) | 728 | | | 55 (3,300) | | 0-3 | 35 | | Yanmar TF70V diesel (electric start) max. output 5.5 (7.5) |
| MRH-700DSCB (air cooled) | 700 | H : 1,170 W: 692 L : 2,670 | dia : 406 width : 650 | | 23.5 (2,400) | | | 40 | Yanmar L100N diesel (electric start) max. output 7.4 (10.0) |
| MRH-700GS | 680 | | | | | | | | Honda GX390 gasoline (electric start) max. output 8.7 (11.8) |

※ The color of water tank will be changed to black in order.

Product Information

| | Applied engine | Operating E/G speed(rpm) | Fuel tank capacity(liters) | Engine oil capacity(cc) | V-belt size numbers | Spark plug NGK |
|-----------------------------|----------------|--------------------------|----------------------------|-------------------------|-------------------------|----------------|
| TAMPING RAMMER | | | | | | |
| MT-55H | Honda GX100 | 3,800 - 4,100 | 2.0 | 280 | — | CR5HSB |
| MTX-60 | Honda GX100 | 3,800 - 4,100 | 2.0 | 280 | — | CR5HSB |
| MTX-70 | Honda GX100 | 3,800 - 4,100 | 3.0 | 280 | — | CR5HSB |
| MT-66HL | Honda GX100 | 3,800 - 4,100 | 2.0 | 280 | — | CR5HSB |
| MT-77HRL | Honda GXR120 | 3,800 - 4,100 | 2.0 | 280 | — | CR5HSB |
| Plate Compactor | | | | | | |
| MVC-50H | Honda GX120 | 3,600 | 2.0 | 560 | RPF-3270 x 1 | BPR6ES |
| MVC-F60H | Honda GX120 | 3,600 | 2.0 | 560 | RPF-3310 x 1 | BPR6ES |
| MVC-F80H | Honda GX160 | 3,600 | 3.1 | 580 | RPF-3310 x 1 | BPR6ES |
| MVC-T90HC | Honda GX160 | 3,600 | 3.1 | 580 | RPF-3330 x 1 | BPR6ES |
| MVC-T100DC | Yanmar L48N | 3,600 | 2.4 | 800 | RPF-3380 x 1 | — |
| Reversible Compactor | | | | | | |
| MVH-R60H | Honda GX120 | 3,600 | 2.0 | 560 | RPF-3320 x1 | BPR6ES |
| MVH-128GH | Honda GX160 | 3,600 | 3.1 | 580 | RPF-3330 x1 | BPR6ES |
| MVH-158GH | Honda GX200 | 3,600 | 3.1 | 600 | RPF-3360 x 1 | BPR6ES |
| MVH-208DSY | Yanmar L70N | 3,100 | 3.3 | 1,100 | HDPF-5390 x1 | — |
| MVH-308DSZ | Hatz 1B30 | 3,350 | 5.0 | 1,100 | HDPF-5430 x1 | — |
| MVH-308DSY | Yanmar L70N | 3,600 | 3.3 | 1,100 | HDPF-5440 x1 | — |
| MVH-408DSZ | Hatz 1B50 | 2,350 | 5.0 | 1,500 | HDPF-5460 x 1 | — |
| MVH-408DSY | Yanmar L100N | 3,200 | 5.4 | 1,600 | HDPF-5440 x 1 | — |
| MVH-508DSZ | Hatz 1D81 | 2,350 | 7.0 | 1,900 | HDPF-5480 x 2 | — |
| Vibration Roller | | | | | | |
| MRH-601DS | Kubota EA330 | 2,600 | 4.8 | 1,300 | A-36 x 1 | — |
| MRH-700DSCBY | Yanmar L100N | 2,500 | 5.4 | 1,600 | A-38 x 2, 3V-300 x 2 | — |
| Concrete Cutter | | | | | | |
| MCD-L14H | Honda GX200 | 3,600 | 3.1 | 600 | 3V-265 x 3 | BPR6ES |
| MCD-218CEH | Honda GX390 | 3,600 | 6.1 | 1,100 | A34 x 4 | BPR6ES |
| Other Models | | | | | | |
| GE-5LH | Honda GX160 | 3,200 | 3.1 | 600 | — | BPR6ES |
| MPT-36H | Honda GX160 | 3,600 | 3.1 | 600 | A30 x 1 | BPR6ES |
| FG-210H | Honda GX120 | 3,700 | 2.0 | 560 | — | BPR6ES |
| FG-310H | Honda GX270 | 3,600 | 5.3 | 1,100 | — | BPR5ES |

*Specifications are subject to change without notification.

*This information is for the reference purpose only.