

DIAPHRAGM PUMPS

BOXER 15



MADE IN ITALY 

- **Product of Italian origin**
- **Patented** stall protection pneumatic circuit
- Works with **non**-lubricated air
- **Self priming**
- Possibility of adjusting the pumping speed
- Versatility of use
- Broad choice of materials that are compatible with the fluid to be pumped
- Idles without damage
- Particularly suitable for heavy duty applications
- High performance
- High power and sturdiness
- Suitable for pumping high viscosity fluids
- Can be set up in tight spaces
- Atex zone 1 (*on request*) - Atex zone 2 standard
- Can be ceiling-mounted
- Continuous operation: YES
- Warranty: 1 year - according to our general conditions of sale
- Spare parts: to identify the spare parts check the exploded views provided at the end of the operation and maintenance manual

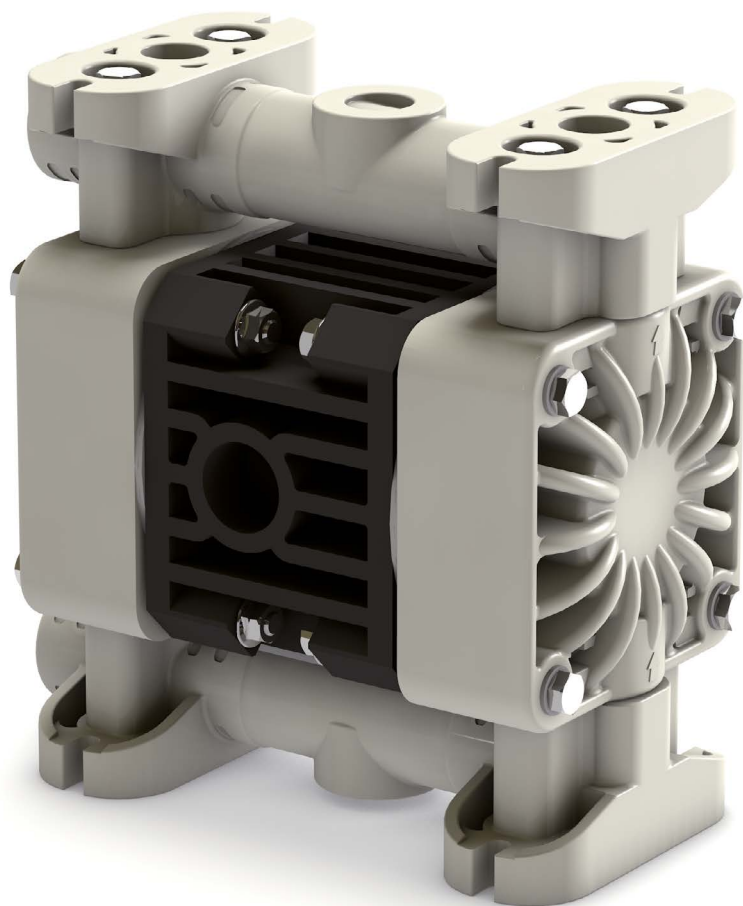

 **STANDARD:** II 3/3 GD c IIB T135°C (zone 2)
CONDUCT: II 2/2 GD c IIB T135°C (zone 1)

Attacchi aspirazione/mandata G 3/8" f - portata 17 l/min
Materiali di costruzione PP - PP+CF - PVDF - ALU - AISI 316



DIAPHRAGM PUMPS

BOXER 15



Ex STANDARD: II 3/3 GD c IIB T135°C (zone 2)
 CONDUCT: II 2/2 GD c IIB T135°C (zone 1)

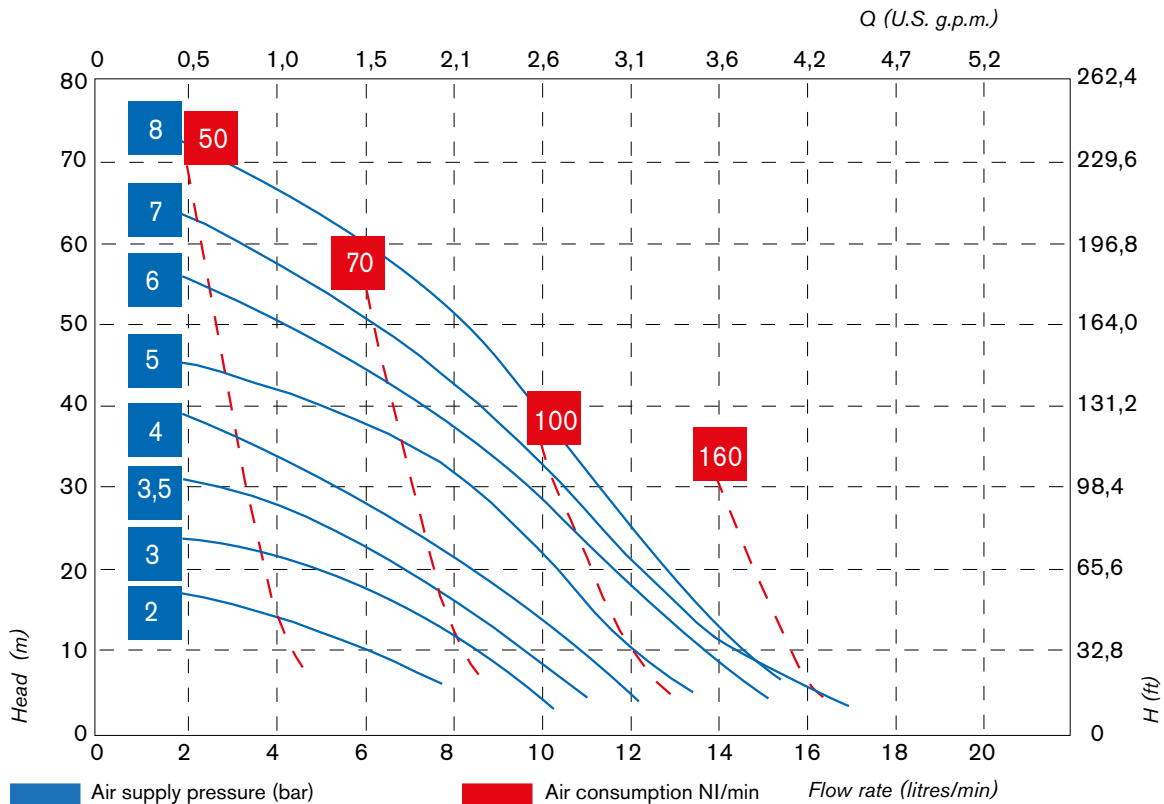

* The curves and performance values refer to pumps with submerged suction and a free delivery outlet with water at 20°C, and vary according to the construction material. ** Attention: the average values of the various configurations of materials by ball and ball seats. *** The value depends on the configuration of the pump.

Guaranteed head/flow rate according to ISO 9906

Intake/delivery connections	G 3/8" f
Air connection	G 3/8" f
Max. flow rate*	17 l/min
Max. air supply pressure	8 bar
Max. head*	80 m
Max. self-priming capacity**	3 m
Max. stored neg. suction	9,5
Max. diameter of passing solids	0,5 mm
Noise***	65 dB
Displacement per cycle	10,3 cc
Max. viscosity	15.000 cps

Construction materials and net weight	PP	1,05 Kg	Temp. 3°C min.	65°C max.
	PVDF	1,05 Kg	Temp. 3°C min.	95°C max.
	Alu	--	Temp. 3°C min.	95°C max.
	AISI 316	--	Temp. 3°C min.	95°C max.

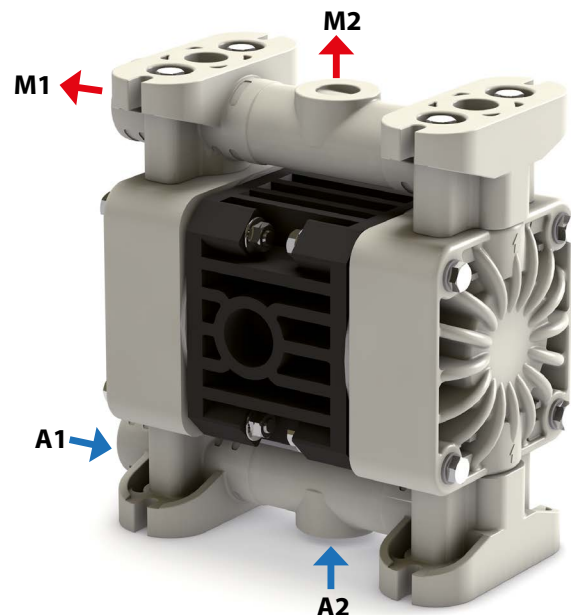

BOXER 15 (PLASTIC): A1-A2-M1-M2

DIAPHRAGM PUMPS

BOXER 15



Ex STANDARD: II 3/3 GD c IIB T135°C (zone 2)
 CONDUCT: II 2/2 GD c IIB T135°C (zone 1)

AVAILABLE MATERIALS

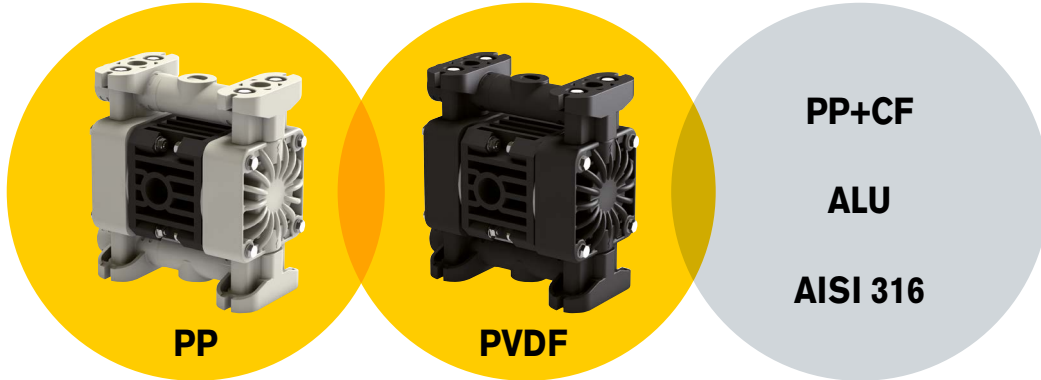

INSTALLATION

SELF PRIMING

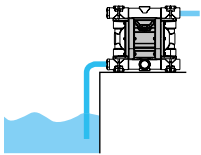

TWIN SUCTION AND DELIVERY MANIFOLD

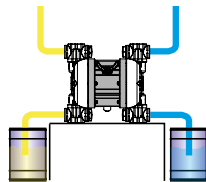

TWIN SUCTION MANIFOLD

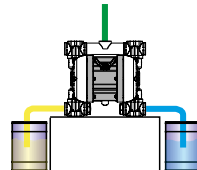

POSITIVE SUCTION HEAD

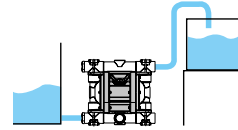

DRUM TRANSFER

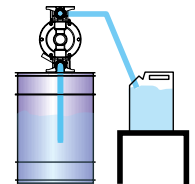

B15
 PP/PP+CF/PVDF

3/8" G AIR CONNECTION 47,30

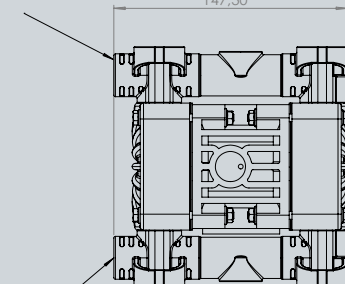

G
 3/8" G INTAKE

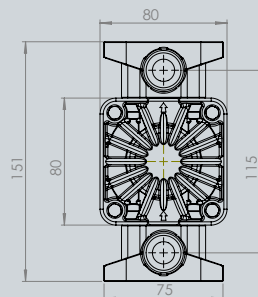

(Dimensions in mm)

Packaging: cardboard box - 18,5 x 13 x 18 cm - weight: 0,2 Kg
 (the weight only refers to the packaging without the pump in it).

DIAPHRAGM PUMPS

BOXER 15



Ex STANDARD: II 3/3 GD c IIB T135°C (zone 2)
 CONDUCT: II 2/2 GD c IIB T135°C (zone 1)

BOXER COMPOSITION CODE

ex. **IB15-P-NTTPV**

Internal Exchanger, BOXER 15, body in PP, air side diaphragm NBR, fluid side diaphragm PTFE, balls PTFE, ball seats PP, O-Ring in VITON.

I	B15 -	P -	N	T	T	P	V	-
INTERNAL EXCHANGER	PUMP MODEL	PUMP BODY	AIR SIDE DIAPHRAGM	FLUID SIDE DIAPHRAGM	BALLS	BALL SEATS	O-RING	CONDUCT VERSION
I	B15 - Boxer 15	P - Polypropylene PC - PP + CF PVDF AL - Alu A - AISI 316	N - NBR	T - PTFE	T - PTFE A - AISI 316	P - Polypropylene ECTFE I - Polizene A - AISI 316	T - PTFE* V - Viton E - EPDM N - NBR	C

*Only mounts ball seats in AISI 316

PRODUCT APPLICATION

